



# OPERATOR'S MANUAL

SETTING UP INSTRUCTIONS  
PARTS LIST

**INTERNATIONAL<sup>®</sup>  
DANCO**

**Model BB-36**

**Snow Thrower**

for

**INTERNATIONAL<sup>®</sup>  
CUB<sup>®</sup> CADET**

**Tractor**

**INTERNATIONAL HARVESTER COMPANY**

180 North Michigan Ave.

Chicago 1, Illinois, U.S.A.

## TO THE OWNER

The purpose of this manual is to assist you in realizing the benefits you anticipated when you purchased this International Harvester product. Literally thousands of people have contributed to the design and production of this product and its delivery to you. They have an interest in its successful performance and have provided this manual to give you the benefit of the experience they have gained through years of field testing and normal usage of this and similar products.

The way you operate and the care you give this product will have much to do with its successful performance. This manual has been carefully prepared and the information arranged and illustrated to make it as easy as possible for you to find the information you wish. It will pay you to read the entire manual carefully before operating and keep it handy for future reference. Your International Harvester Dealer will be glad to answer any further questions you may have on the operation or care of this product.

---

It is the policy of International Harvester Company to improve its products whenever it is possible and practical to do so. We reserve the right to make changes or add improvements at any time without incurring any obligation to make such changes on products sold previously.

---

As a member of the National Safety Council, we are privileged to use the Green Cross for Safety to designate not only our interest in Safety, but to point out more clearly the safety precautions in this manual.





# DELIVERY REPORT

(This copy to be filed by dealer.)

Delivered to \_\_\_\_\_ Address \_\_\_\_\_  
Purchaser's Name Street and No. or R.F.D. and Box No.

\_\_\_\_\_ 19\_\_\_\_  
Town State Date

## International Danco Model BB-36 Snow Thrower

Serial No. \_\_\_\_\_

### PREDELIVERY SERVICE

Prior to the delivery of the above implements the following checks were made and corrective action taken as necessary:

- |   |   |
|---|---|
| <input type="checkbox"/> Shortage or damage in shipment                     | <input type="checkbox"/> Completely lubricated thrower        |
| <input type="checkbox"/> Assemble thrower according to Operator's Manual    | <input type="checkbox"/> Checked alignment of universal drive |
| <input type="checkbox"/> Checked drive chain adjustment                     | <input type="checkbox"/> Checked drive belt adjustment        |
| <input type="checkbox"/> Checked lubrication of RD-6 Underdrive (when used) | <input type="checkbox"/> Checked snow chute adjustment        |
|   | <input type="checkbox"/> Checked for loose bolts and nuts     |

### DELIVERY SERVICE

At time of delivery the importance of the Operator's Manual was explained and, with it as a guide, instruction was given as indicated by check marks:

- |   |   |
|---|---|
| <input type="checkbox"/> Mounting and dismounting thrower | <input type="checkbox"/> Lubricating entire thrower                                     |
| <input type="checkbox"/> Proper use of thrower            | <input type="checkbox"/> How to adjust for ground clearance including runner adjustment |
| <input type="checkbox"/> Proper use of snow chute         |   |

The customer's signature below certifies that the above equipment was delivered to him in a satisfactory condition and that he received instruction as to its proper operation and maintenance.

Signed \_\_\_\_\_ Signed \_\_\_\_\_  
Customer Dealer

By \_\_\_\_\_ By \_\_\_\_\_



# DELIVERY REPORT

DISTRICT OFFICE COPY

(EXPORT—DISTRIBUTOR OR AFFILIATE OFFICE COPY)

(This copy to be sent to International Harvester District Office.)  
(EXPORT—Send to Distributor or Affiliate General Office.)

Delivered to \_\_\_\_\_ Address \_\_\_\_\_  
Purchaser's Name Street and No. or R.F.D. and Box No.

\_\_\_\_\_ 19\_\_\_\_  
Town State Date

International Danco Model BB-36 Snow Thrower

Serial No. \_\_\_\_\_

### PREDELIVERY SERVICE

Prior to the delivery of the above implements the following checks were made and corrective action taken as necessary:

- Shortage or damage in shipment
- Assemble thrower according to Operator's Manual
- Checked drive chain adjustment
- Checked lubrication of RD-6 Underdrive (when used)
- Completely lubricated thrower
- Checked alignment of universal drive
- Checked drive belt adjustment
- Checked snow chute adjustment
- Checked for loose bolts and nuts

### DELIVERY SERVICE

At time of delivery the importance of the Operator's Manual was explained and, with it as a guide, instruction was given as indicated by check marks:

- Mounting and dismounting thrower
- Proper use of thrower
- Proper use of snow chute
- Lubricating entire thrower
- How to adjust for ground clearance including runner adjustment

The customer's signature below certifies that the above equipment was delivered to him in a satisfactory condition and that he received instruction as to its proper operation and maintenance.

Signed \_\_\_\_\_  
Customer

Signed \_\_\_\_\_  
Dealer

By \_\_\_\_\_

By \_\_\_\_\_

INTERNATIONAL  
DANCO

INTERNATIONAL  
DANCO

INTERNATIONAL  
DANCO

INTERNATIONAL  
DANCO



# DELIVERY REPORT

DISTRICT OFFICE COPY  
(FOR MANUFACTURER)

Delivered to \_\_\_\_\_ Address \_\_\_\_\_  
Purchaser's Name Street and No. or R.F.D. and Box No.

\_\_\_\_\_ 19\_\_\_\_\_  
Town State Date

International Danco Model BB-36 Snow Thrower

Serial No. \_\_\_\_\_

### PREDELIVERY SERVICE

Prior to the delivery of the above implements the following checks were made and corrective action taken as necessary:

- |   |   |
|---|---|
| <input type="checkbox"/> Shortage or damage in shipment                     | <input type="checkbox"/> Completely lubricated thrower        |
| <input type="checkbox"/> Assemble thrower according to Operator's Manual    | <input type="checkbox"/> Checked alignment of universal drive |
| <input type="checkbox"/> Checked drive chain adjustment                     | <input type="checkbox"/> Checked drive belt adjustment        |
| <input type="checkbox"/> Checked lubrication of RD-6 Underdrive (when used) | <input type="checkbox"/> Checked snow chute adjustment        |
|   | <input type="checkbox"/> Checked for loose bolts and nuts     |

### DELIVERY SERVICE

At time of delivery the importance of the Operator's Manual was explained and, with it as a guide, instruction was given as indicated by check marks:

- |   |   |
|---|---|
| <input type="checkbox"/> Mounting and dismounting thrower | <input type="checkbox"/> Lubricating entire thrower                                     |
| <input type="checkbox"/> Proper use of thrower            | <input type="checkbox"/> How to adjust for ground clearance including runner adjustment |
| <input type="checkbox"/> Proper use of snow chute         |   |

The customer's signature below certifies that the above equipment was delivered to him in a satisfactory condition and that he received instruction as to its proper operation and maintenance.

Signed \_\_\_\_\_  
Customer

Signed \_\_\_\_\_  
Dealer

By \_\_\_\_\_

By \_\_\_\_\_

INTERNATIONAL  
DANCO

INTERNATIONAL  
DANCO

INTERNATIONAL  
DANCO

INTERNATIONAL  
DANCO



OWNER'S COPY

# DELIVERY REPORT

(This copy to be retained by owner.)

Delivered to \_\_\_\_\_ Address \_\_\_\_\_  
Purchaser's Name Street and No. or R.F.D. and Box No.

\_\_\_\_\_ 19\_\_\_\_\_  
Town State Date

International Danco Model BB-36 Snow Thrower

Serial No. \_\_\_\_\_

### PREDELIVERY SERVICE

Prior to the delivery of the above implements the following checks were made and corrective action taken as necessary:

- |   |   |
|---|---|
| <input type="checkbox"/> Shortage or damage in shipment                     | <input type="checkbox"/> Completely lubricated thrower        |
| <input type="checkbox"/> Assemble thrower according to Operator's Manual    | <input type="checkbox"/> Checked alignment of universal drive |
| <input type="checkbox"/> Checked drive chain adjustment                     | <input type="checkbox"/> Checked drive belt adjustment        |
| <input type="checkbox"/> Checked lubrication of RD-6 Underdrive (when used) | <input type="checkbox"/> Checked snow chute adjustment        |
|   | <input type="checkbox"/> Checked for loose bolts and nuts     |

### DELIVERY SERVICE

At time of delivery the importance of the Operator's Manual was explained and, with it as a guide, instruction was given as indicated by check marks:

- |   |   |
|---|---|
| <input type="checkbox"/> Mounting and dismounting thrower | <input type="checkbox"/> Lubricating entire thrower                                     |
| <input type="checkbox"/> Proper use of thrower            | <input type="checkbox"/> How to adjust for ground clearance including runner adjustment |
| <input type="checkbox"/> Proper use of snow chute         |   |

The customer's signature below certifies that the above equipment was delivered to him in a satisfactory condition and that he received instruction as to its proper operation and maintenance.

Signed \_\_\_\_\_  
Customer

Signed \_\_\_\_\_  
Dealer

By \_\_\_\_\_

By \_\_\_\_\_

**INTERNATIONAL  
DANCO**

**INTERNATIONAL  
DANCO**

**INTERNATIONAL  
DANCO**

**INTERNATIONAL  
DANCO**

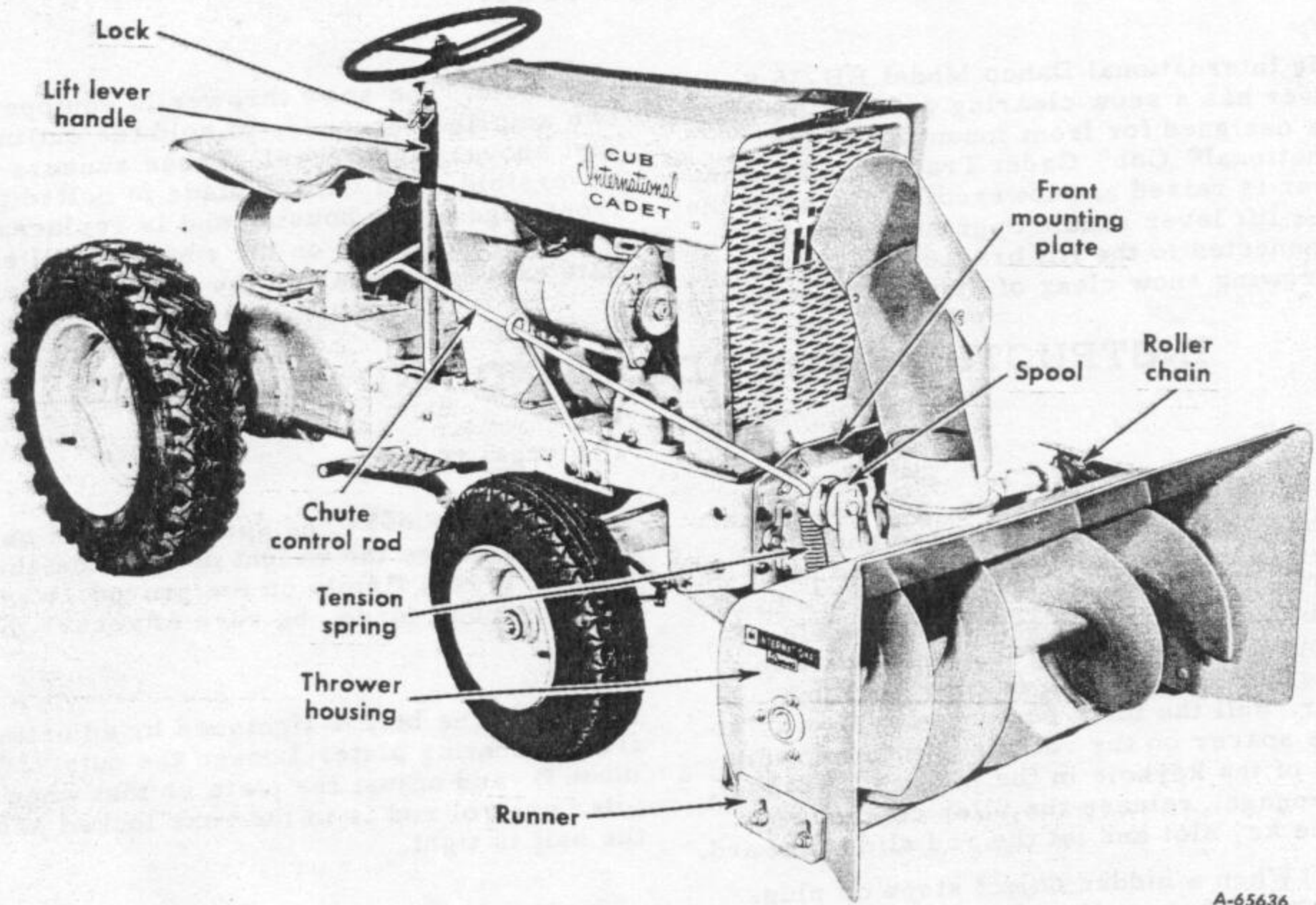

A-65636

Illust. 1

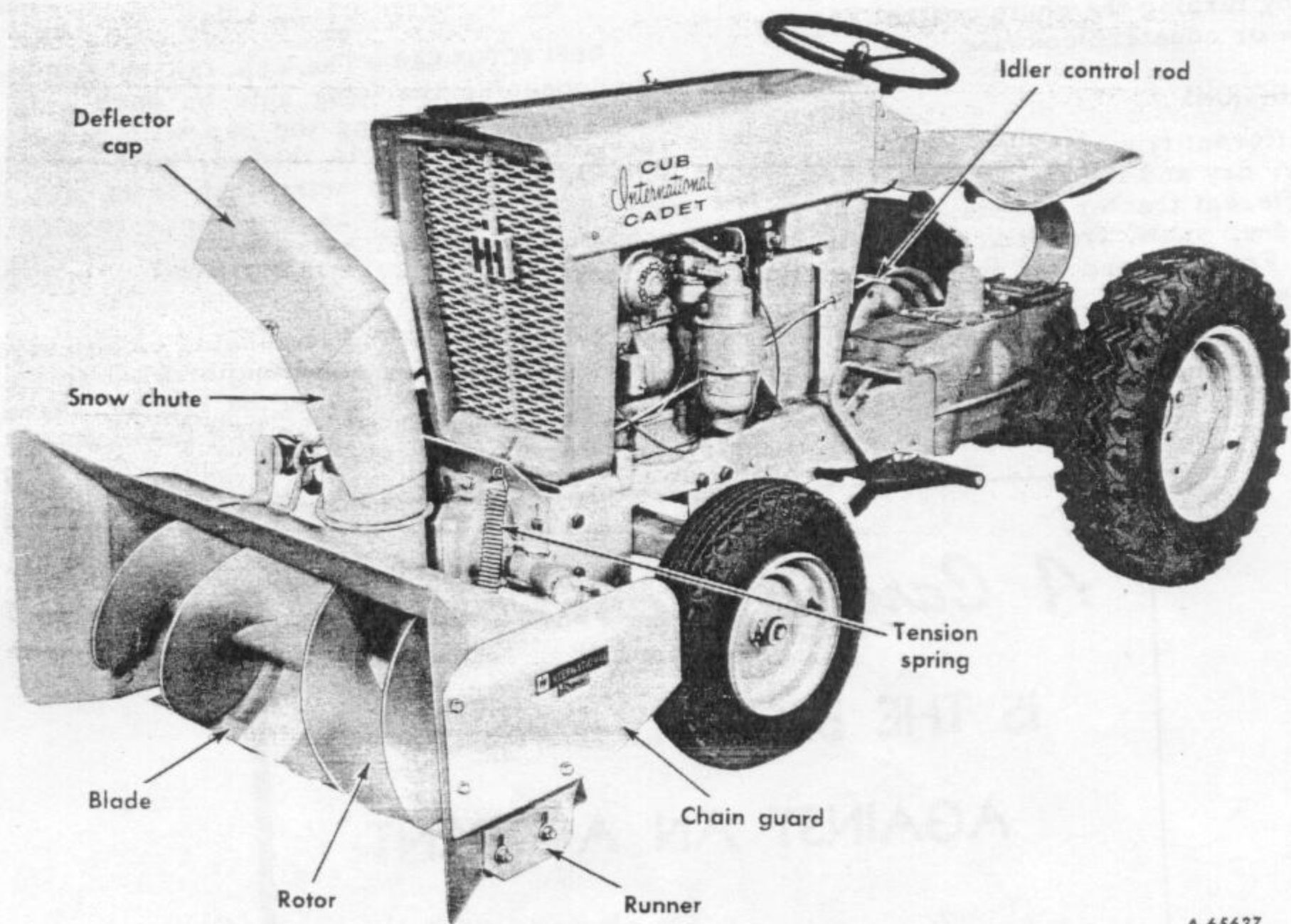

A-65637

Illust. 2



## INTRODUCTION

The International Danco Model BB-36 Snow Thrower has a snow clearing width of 36 inches and is designed for front mounting on the International® Cub® Cadet Tractor. The snow thrower is raised and lowered by means of the tractor lift lever handle operating a solid lift rod connected to the lift bracket. It is used for throwing snow clear of driveways, side-

walks etc. The snow thrower is equipped with two adjustable runners to hold the cutting edge just above ground level. These runners are reversible. The cutting blade is bolted to the front edge of the housing and is replaceable. Proper adjustment on the runners will eliminate excessive wear on the cutting blade.

## INSTRUCTIONS FOR ADJUSTING AND OPERATING

### OPERATING

To raise the snow thrower, pull the lift lever handle (Illustr. 1). To lower the snow thrower, push the handle to a forward position. The snow thrower can be set "free to float" by depressing the trip lever handle release button and securing it in this position with the lock (Illustr. 1). To engage the snow thrower, pull the idler control rod (Illustr. 2) so that the spacer on the rod locks in the lower portion of the keyhole in the mounting bracket. To disengage, release the idler control rod from the key slot and let the rod slide forward.

**NOTE:** When a hidden object stops or plugs the rotor, disengage the idler control rod as quickly as possible; this will prevent excessive wear on the belt.

The snow chute (Illustr. 2) can be rotated 180 degrees by turning the chute control arm clockwise or counterclockwise.

### SNOW CONDITIONS

The different types of snow, such as wet and heavy, dry and light and also depth requires different tractor speeds. For wet and heavy or deep snow, travel at a very low rate of speed. For light and dry snow, speed may be increased.

 **CAUTION!** Exercise extreme care when operating the snow thrower at high speeds, otherwise, the driver could be unseated in a collision with hidden objects.

### ADJUSTMENTS

**TENSION SPRINGS** - The springs should be adjusted to where the weight of the snow thrower will let it ride firmly on the ground. When an adjustment is made, be sure to secure the jam nuts.

**BELT** - The belt is tightened by adjusting the front mounting plate. Loosen the nuts "J" (Illustr. 9) and adjust the plate so that when the idler control rod is in the rear locked position, the belt is tight.

**ROLLER CHAIN** - The roller chain can be tightened by the adjustment bolt "K" (Illustr. 11) and the lock nut on the rear of the small sprocket mounting bracket.

**DEFLECTOR CAP** - The cap can be adjusted by loosening the wing nuts on each side of the chute. Lowering the cap will reduce the distance the snow is thrown. **NOTE:** Do not lower the cap any more than is necessary in heavy wet snow as this tends to clog the chute.

**RUNNERS** - The runners should be adjusted to slightly below the housing bracket so that the blade will not ride on the ground, therefore, clearing the cracks in sidewalks and driveways, etc.

*A Careful Operator*

IS THE BEST INSURANCE

AGAINST AN ACCIDENT

—National Safety Council.

## LUBRICATION

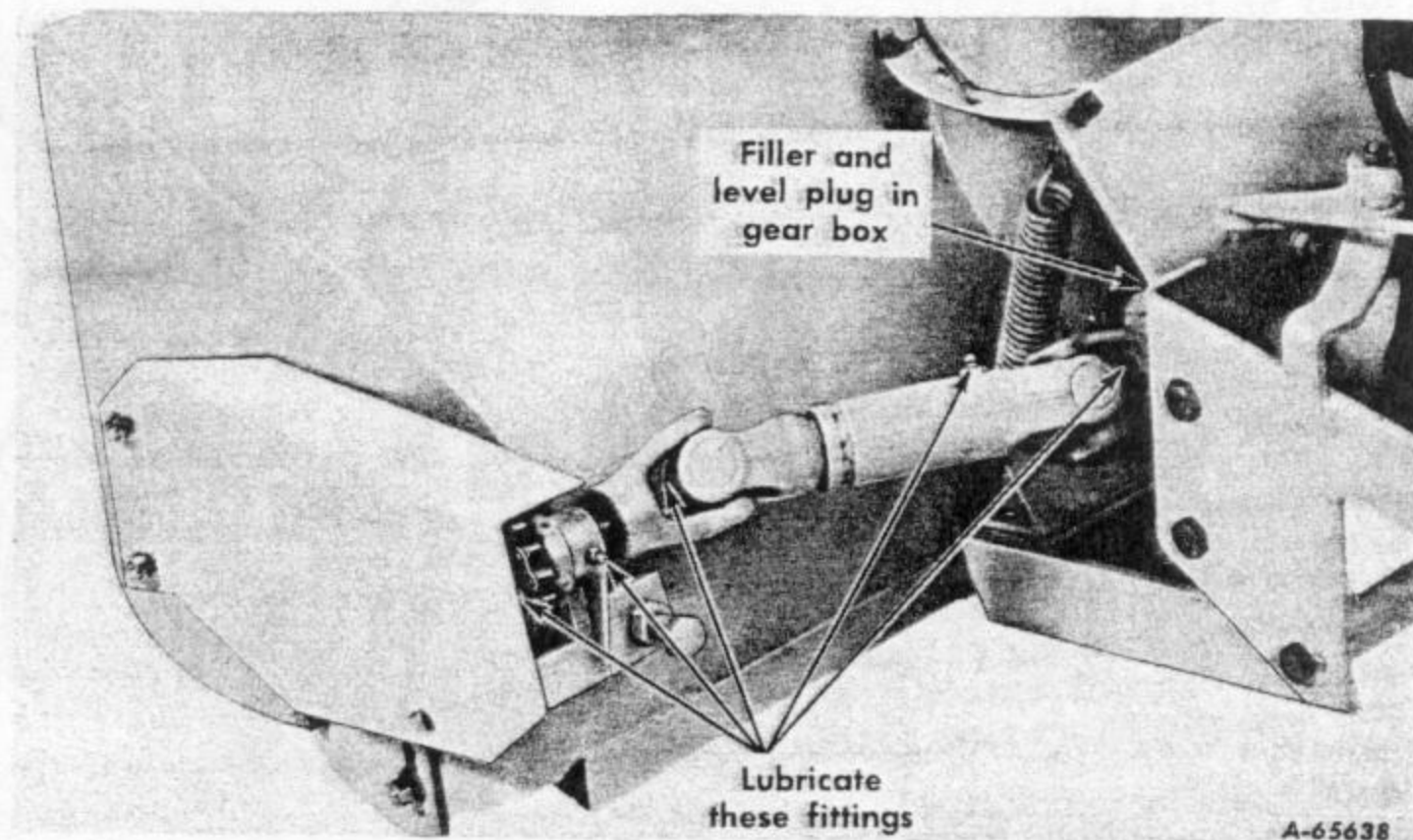

Illustr. 3

Fill the right-angle gear box with SAE-140 transmission oil to the level plug. Check the oil level occasionally to see that the gear case is filled up to the level plug. Also see Illustr. 9.

Lubricate the universal drive assembly each time the snow thrower is used. Use a pressure lubricating gun.

Lubricate the transfer shaft through the two lubrication fittings in the rear of the small sprocket mounting bracket each time the snow thrower is used. Use a pressure lubricating gun.

The rotor shaft bearings and the idler bearing are sealed; they do not require lubrication.

## INSTRUCTIONS FOR SETTING UP

Arrange the parts so that they will be convenient for setting up the snow thrower.

Bolts must be used in the holes in which they are found, or in the parts to which they are attached, unless otherwise shown.

Wherever the terms "left" and "right" are used, it should be understood to mean from a position behind and facing the machine.

## SUBASSEMBLIES

1. Bolt the idler to the idler arm by inserting a 5/8 x 1-3/4" bolt through the arm towards the rear of the tractor. Then place the bushing and the idler on the bolt, and secure in place with a 5/8" plain washer, lock washer, and nut. See *Illustr. 4*.

2. Place the square key in the key slot of the input shaft of the gear box; then slide the large sheave on the shaft. Do not secure at this time. See *Illustr. 4*.

3. Place the link through the small hole in the idler arm and secure with a 1/4" flat washer and a 1/8 x 3/4" cotter pin. See *Illustr. 4*.

4. Install the bellcrank to the left side plate arm by using the 1/2 x 5/8" clevis pin, plain washer and cotter pin, making certain that the long arm of the bellcrank extends to the left of the tractor and the short arm forward. See *Illustr. 4*.

5. Place the chute over the spout on the thrower housing. Assemble with the three clips at "A" and "B" (*Illustr. 5*) below the ring on the chute, using 1/4 x 1/2" NC carriage bolts, washers and hex-nuts. Revolve the chute to make certain that it does not bind, but do not tighten the bolts at this time.

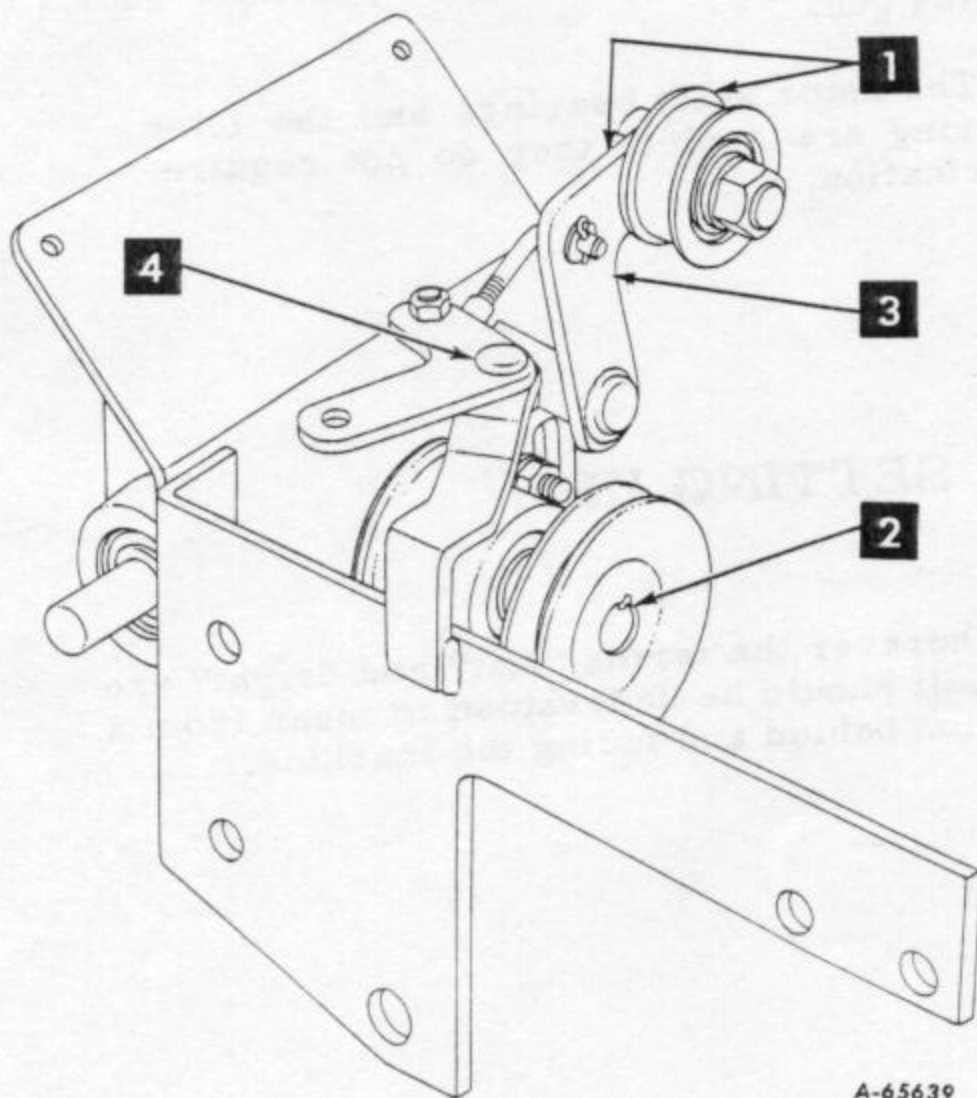

*Illustr. 4*

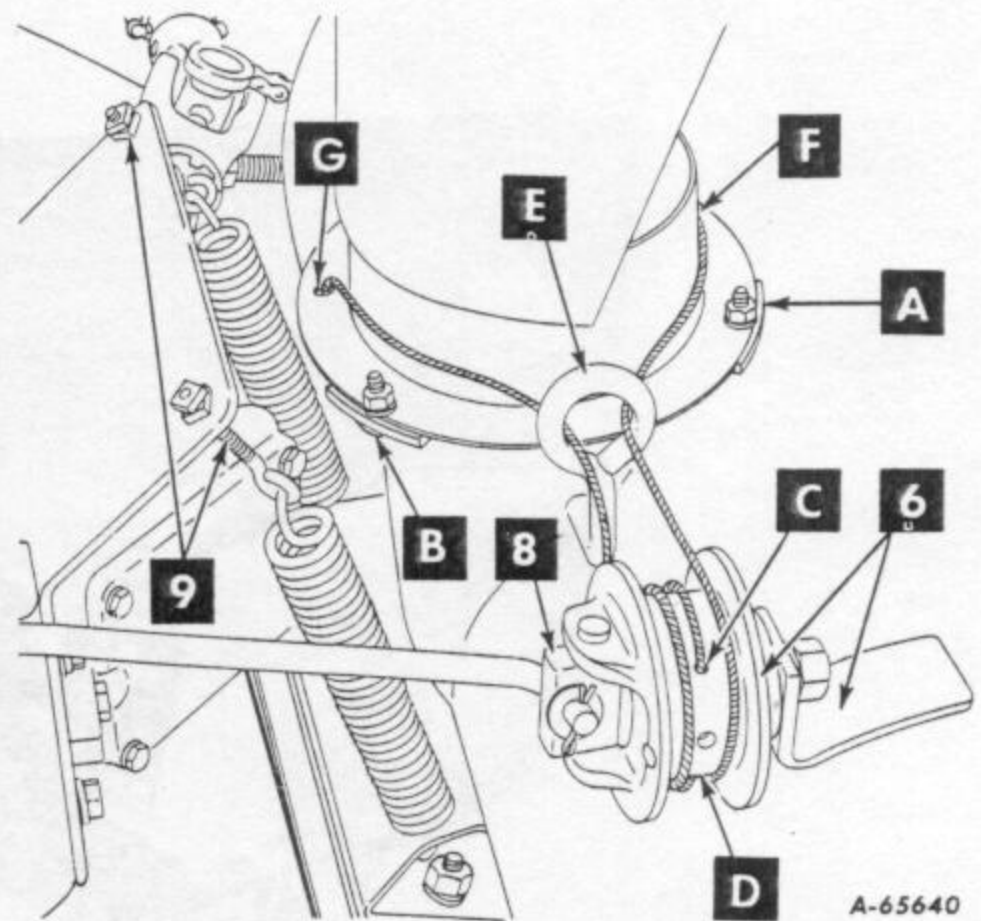

*Illustr. 5*

6. Install the spool on the thrower housing by inserting a 1/2 x 2" hex-hd. bolt (started from inside the spool) through a plain washer, bushing and the spool. Secure to the thrower housing bracket with a 1/2" lock washer and nut.

7. Insert the control lines through the holes "C" and "D" in the spool. Wind each line around the spool one full turn but in opposite directions. Then insert the ends of the lines through the eye "E" on the thrower housing. Before proceeding be sure the snow chute faces directly forward. The line that comes off the top of the spool is to be strung through hole "F" in the front of the snow chute. The line that comes off the spool from the bottom is to be strung through hole "G" at the rear of the chute. Pull the line in the front of the chute tight and place it between the clip at "A" and the ring on the chute outside of the carriage bolt; then tighten the carriage bolt securely. The line at the rear of the chute is to be pulled tight and secured by the clip at "B" in the same manner.

8. Secure the cross in the spool by using a 5/16 x 2-3/16" clevis pin, washer and 1/8 x 3/4" cotter pin.

9. Insert the two 1/4 x 2" eye bolts through the holes on the front mounting plate, securing with two 1/4" nuts on each eye bolt. See *Illustr. 5*.

Continued on next page.

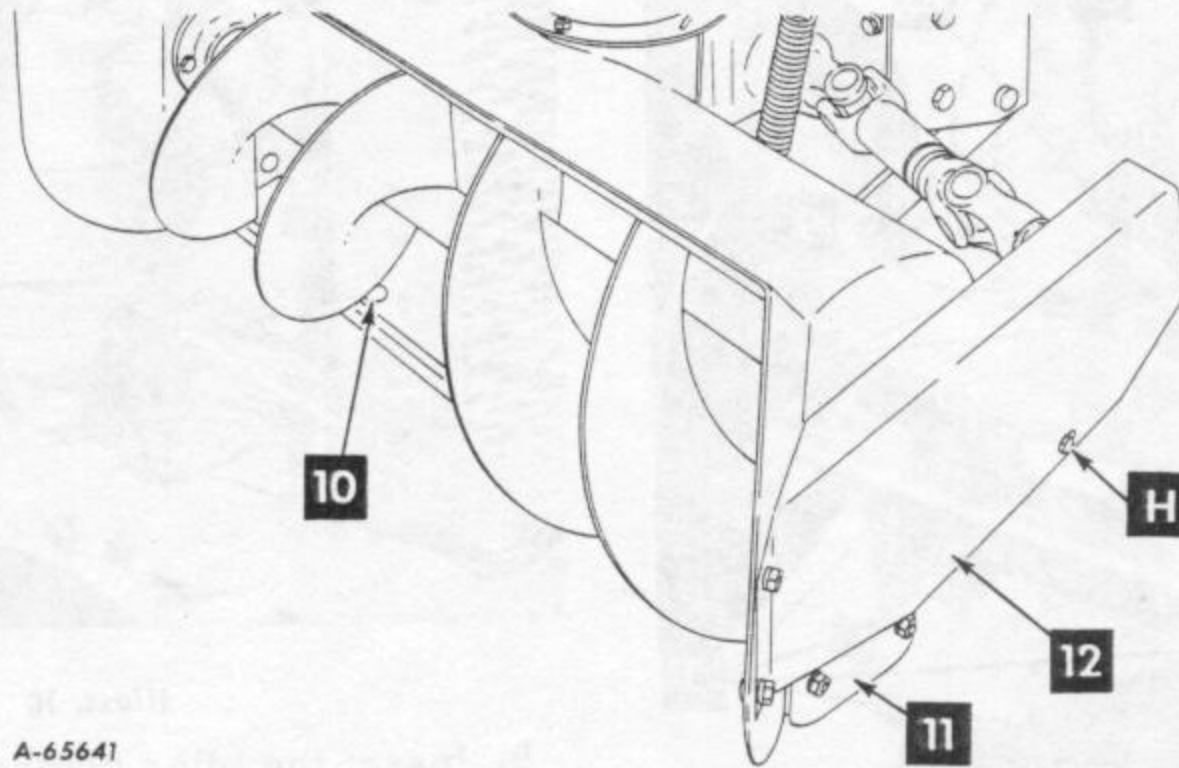

A-65641

Illustr. 6

10. Mount the blade to the thrower housing by inserting the 5/16 x 1/2" carriage bolts, first through the housing then through the blade. Secure with lock washers and nuts. See Illustr. 6.

11. Install the runners to the thrower housing by inserting 3/8 x 3/4" carriage bolts out through the housing. Secure with flat washers, lock washers and nuts. Position the runners slightly below the blade. See Illustr. 6.

12. Mount the chain guard by inserting 5/16 x 1/2" carriage bolts out through the housing and the chain guard and inserting a 5/16 x 3/4" cap screw through the chain guard into the mounting lug at "H" on the side of the housing. Secure all three bolts with lock washers and nuts. See Illustr. 6.

1. Insert the lift rod through the hole in the tractor frame on the front and connect it to the lift lever handle. Secure with a plain washer and 1/8 x 3/4" cotter pin. See Illustr. 7.

2. Bolt the right side plate to the tractor frame with 1/2 x 1-1/4" bolts, lock washers and nuts. Attach the rod guide to the rear two holes of the right side plate with two 1/2 x 1-1/4" bolts and lock washers. See Illustr. 8.

ATTACHING THE SNOW THROWER TO THE TRACTOR

After the subassemblies have been completed, proceed as follows in securing the snow thrower to the tractor.

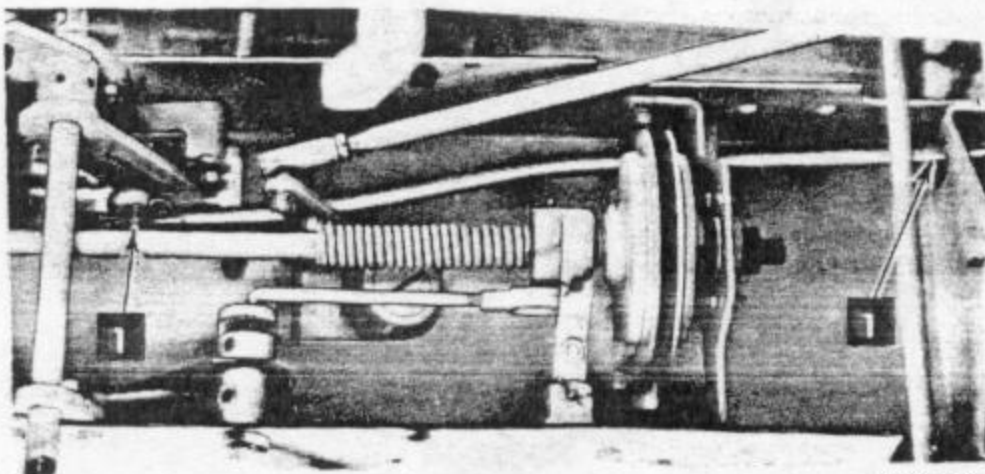

A-63704

Illustr. 7

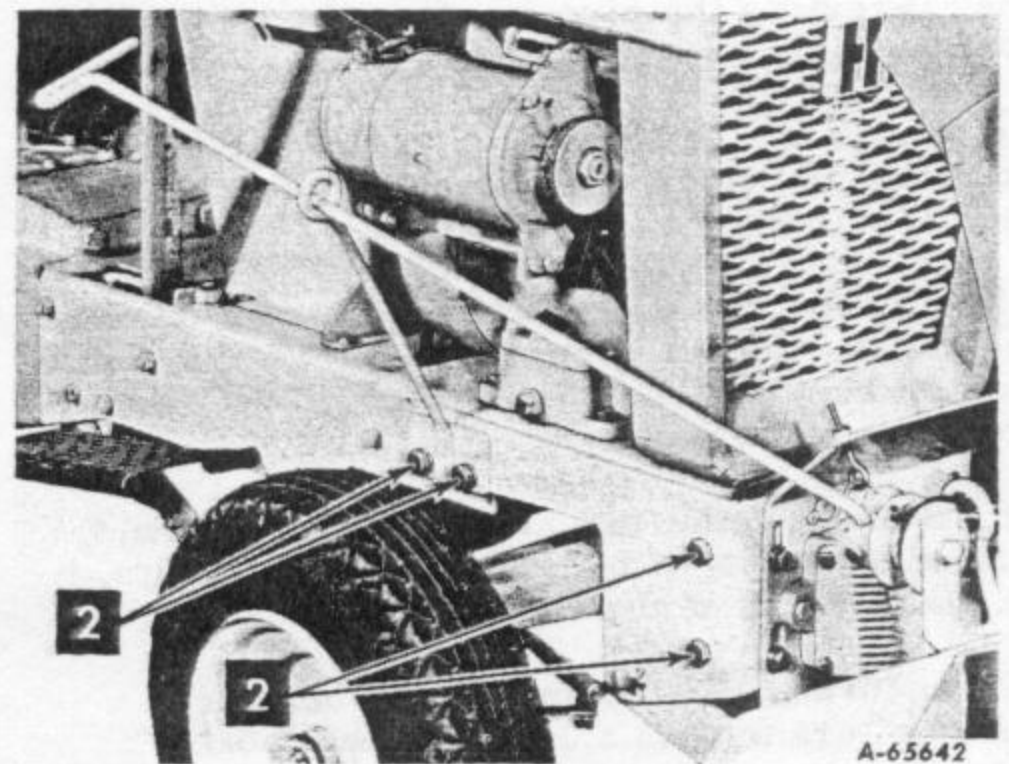

A-65642

Illustr. 8

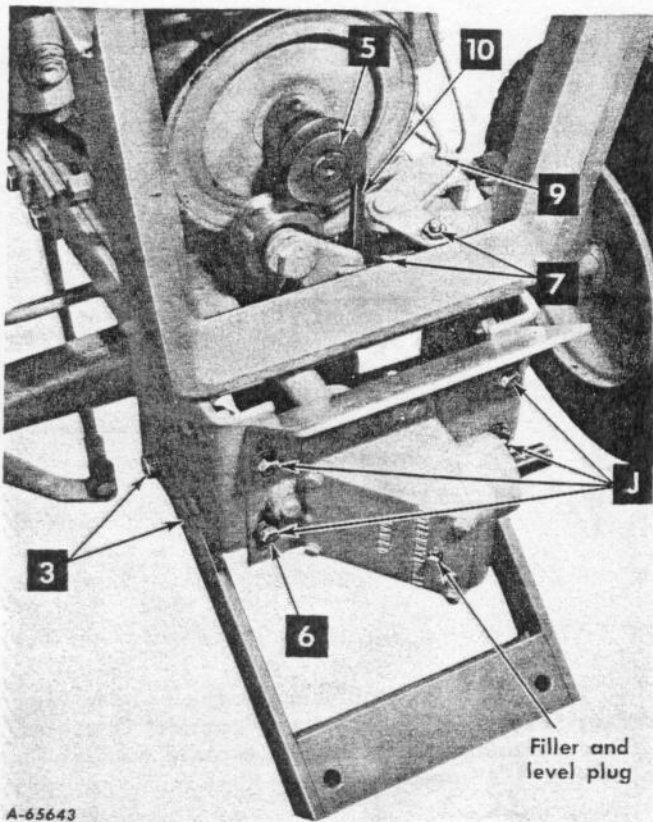

Illustr. 9

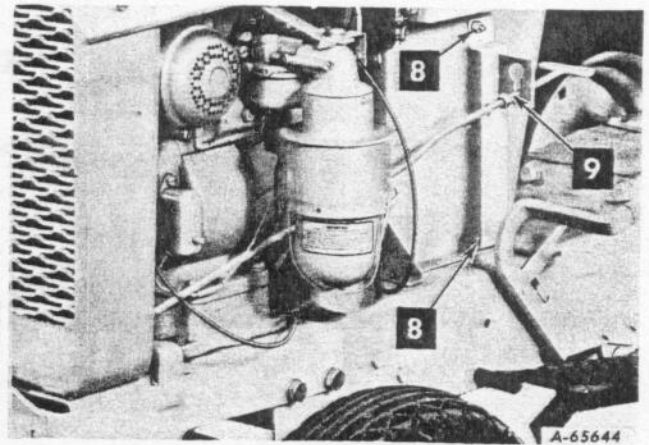

Illustr. 10

9. Insert the idler control rod through the key slot (Illustr. 10) and secure to the long arm of the bellcrank with a flat washer and 1/8 x 3/4" cotter pin. See Illustr. 9.

10. Install the belt on the two sheaves with the idler running on the back side of the belt; then align and secure both sheaves with their set screws. NOTE: The belt should run in the center of the idler. See Illustr. 9.

11. Install the universal assembly (Illustr. 11) on the output shaft of the gear box with a 3/16" key and set screw. Then insert a 3/32 x 1-1/4" cotter pin into the hole in the output shaft and spread the cotter pin. Slide the thrower housing assembly into position in front of the tractor. Install the other end of the universal assembly on the transfer shaft with 3/16" key and set screw; then insert a 3/32 x 1-1/4" cotter pin into the hole in the shaft and spread the cotter pin. Slide the housing on to the lift bracket and secure with two 1/2 x 3" hex-hd. bolts, lock washers and nuts. See Illustr. 11 and 12.

Continued on next page.

3. Insert the pivot shaft through the lift bracket and in the bottom hole of the right side plate and secure with a 3/16 x 1-1/4" cotter pin. Then mount the left side plate at the same time, inserting the pivot shaft in the bottom hole. See Illustr. 9 and 11.

4. Raise the lift bracket and slip the lift rod into place and secure with a plain washer and 1/8 x 3/4" cotter pin. See Illustr. 11.

5. Slip the small drive sheave on the engine crank shaft. Do not secure the drive sheave at this time. See Illustr. 9. The tractor grille may have to be removed.

6. Bolt the front mounting assembly (Illustr. 9) to the side plates with the four 3/8 x 1" bolts, lock washers, and nuts.

7. Secure the ball joint to the short arm on the bellcrank with a 1/4" nut and lock washer.

8. Mount the idler control rod bracket (Illustr. 10) to the left side of the tractor steering sector housing with a 1/4 x 3/4" bolt through the throttle cable slot. Secure the bottom of the bracket with the rear bolt of the tractor steering sector housing.

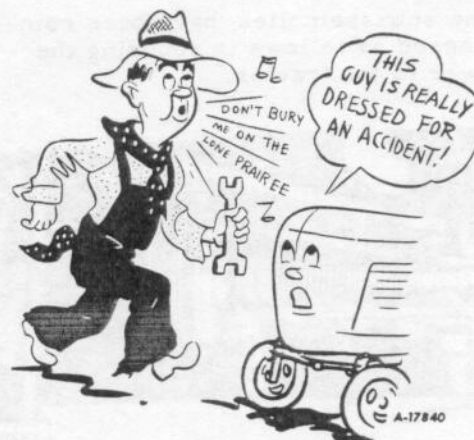

Loose or "floppy" clothing should not be worn by the operator because of the danger of it wrapping on or getting into the moving parts.

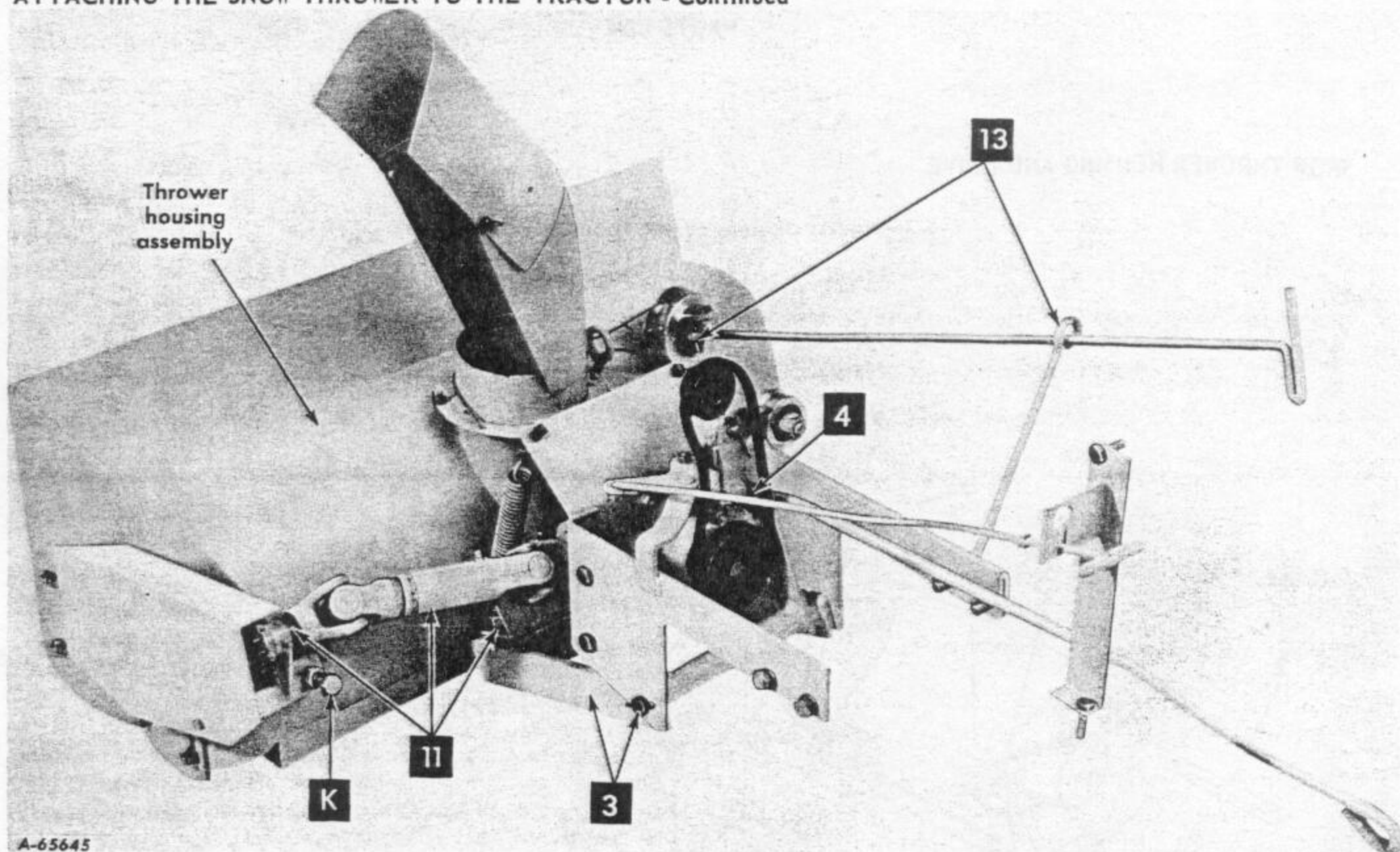

Illustr. 11

View showing snow thrower removed from tractor.

12. Insert the springs into each side of the thrower housing mounting bracket. Lift the front of the housing so that the springs can be hooked in the eye bolts extending from the front mounting bracket.

13. Insert the chute control arm through the rod guide from the rear and secure to the spool cross with a plain washer and 1/8 x 3/4" cotter pin. See Illustr. 11 and 12.

NOTE: Replace the tractor grille if it had been removed previously.

After the snow thrower has been mounted on the tractor, refer to "Adjustments" in the Instructions for Adjusting and Operating.

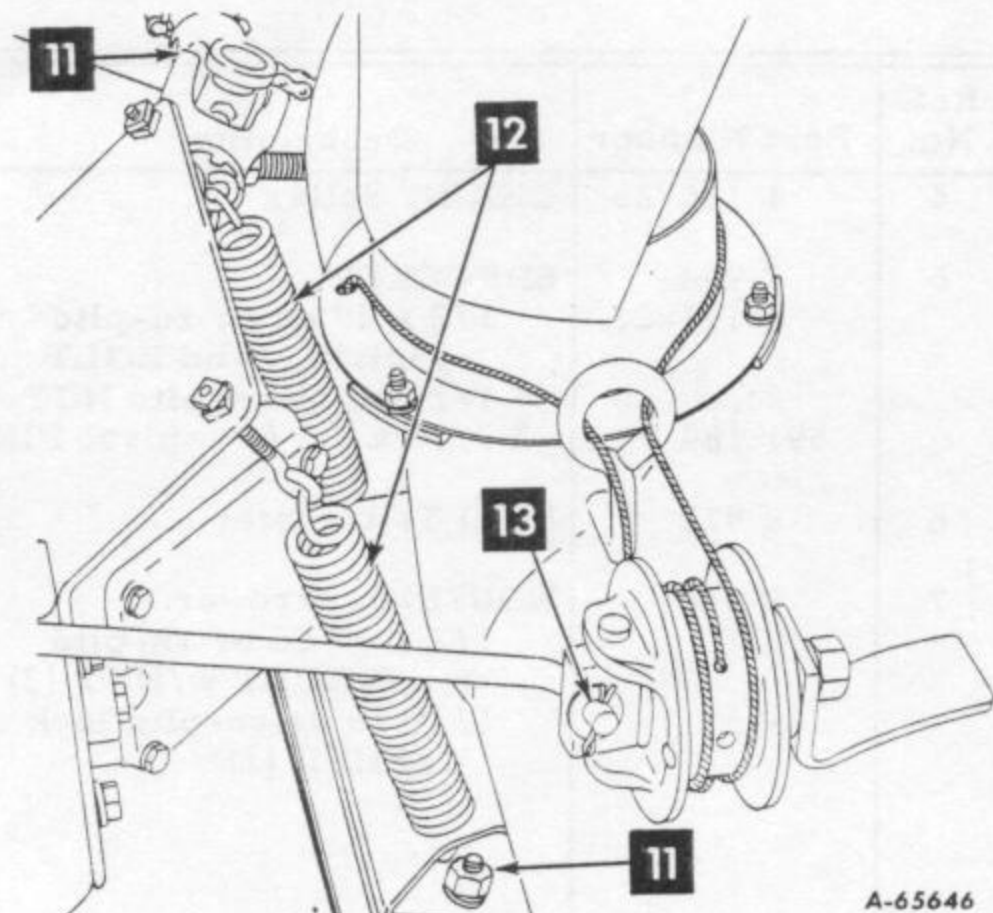

Illustr. 12

#### DISASSEMBLY INSTRUCTIONS

1. Put blocks under the snow thrower housing to remove the tension on the springs.
2. Remove the cotter pins at both ends of the lift rod and remove the rod from the underside of the tractor.
3. Remove the cotter pin from the idler arm.
4. Remove the front mounting plate assembly, the drive belt, the pivot shaft, and the side plates.
5. Remove the cotter pin from the idler control rod.

# PARTS LIST

## SNOW THROWER HOUSING AND DRIVE

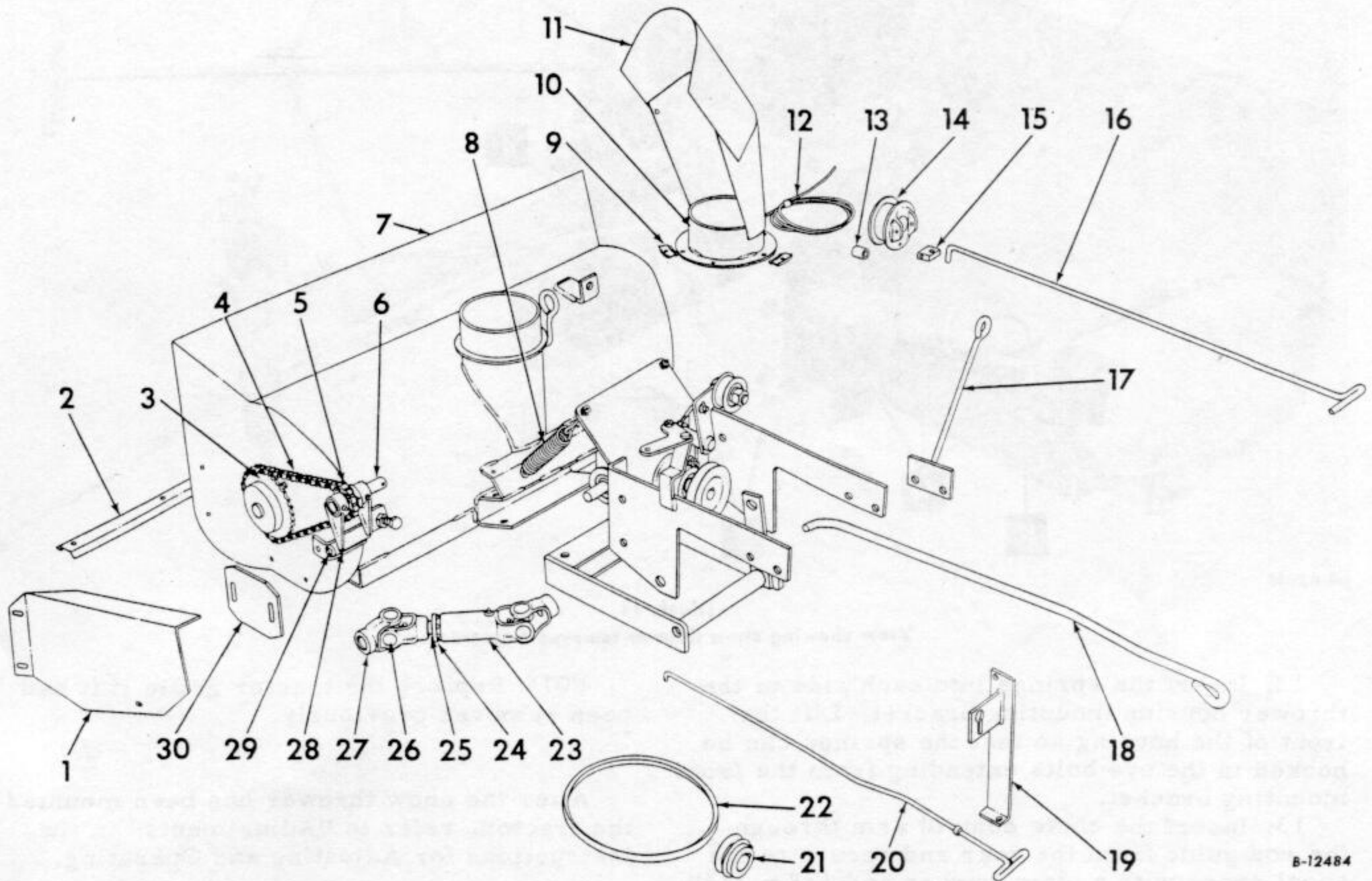

B-12484

Ref. No.	Part Number	Description	Ref. No.	Part Number	Description
1	3 012	GUARD, chain 5/16 x 1/2" cd or zn-pltd crg BOLT w/NUT (2) 5/16" cd or zn-pltd NUT 5/16 x 3/4" cd or zn-pltd cap SCREW 5/16" lock WASHER (3) 5/16 x 3/4" x 16 ga cd or zn-pltd WASHER (3)	4	1 126-26	CHAIN, roller
2	2 989	BLADE 5/16 x 1/2" cd or zn-pltd crg BOLT w/NUT (5) 5/16" cd or zn-pltd lock WASHER (5)	5	2 984 1 111-23	SPROCKET 1/2 x 2" cd or zn-pltd special hex-hd BOLT 1/2" cd or zn-pltd NUT 3/16 x 1-1/4" spirol PIN
3	2 982 617 941 R1	SPROCKET 5/16 x 2" cd or zn-pltd spirol PIN	6	591 184 R1 2 972	SHAFT, transfer
			7	2 948	HOUSING, thrower 1/2 x 3" cd or zn-pltd mach BOLT w/NUT (2) 1/2" cd or zn-pltd lock WASHER (2)

Continued on next page.

PARTS LIST

SNOW THROWER HOUSING AND DRIVE - Continued

Ref. No.	Part Number	Description	Ref. No.	Part Number	Description
8	3 018 3 002	SPRING, tension (2) 1/4" cd or zn-pltd eye BOLT (2) 1/4" cd or zn-pltd NUT (2)	19	3 000	BRACKET, rear 1/4" cd or zn-pltd NUT 1/4 x 3/4" cd or zn-pltd cap SCREW 1/4" cd or zn-pltd lock WASHER
9	3 001	CLIP, chute holder (3) 1/4" cd or zn-pltd NUT (3) 1/4 x 1/2" cd or zn-pltd cap SCREW (3) 1/4" cd or zn-pltd lock WASHER (3)	20	2 997	ROD, idler control 1/8 x 3/4" cd or zn-pltd cotter PIN 1/4 x 1/2" x .049 ga cd or zn-pltd WASHER
10	2 949-A	CHUTE, snow	21	1 177-16	SHEAVE, top 3/8 x 3/8" cup-pt allen set SCREW
11	2 949-2 126 032	CAP, deflector 3/16" cd or zn-pltd wing NUT (2) 3/8" cd or zn-pltd lock WASHER	22	1 176-38	BELT, A-25
12	2 994	CABLE, swivel control	23	2 981-1	YOKE and TUBE ASSEMBLY, tractor half
13	2 992	BUSHING, tubing 1/2" cd or zn-pltd NUT 1/2 x 2" cd or zn-pltd cap SCREW 1/2" cd or zn-pltd lock WASHER		2 741-320 102 592	mounting universal KEY 3/32 x 1-1/4" cotter PIN 3/8 x 3/8" cup-pt allen set SCREW
14	2 990	SPOOL, swivel	24	2 981-8	CAP, retainer
15	2 991	CROSS 1/8 x 3/4" cotter PIN 5/16 x 2-3/16" dld-std-hd PIN 5/16 x 3/4" x 16 ga cd or zn-pltd WASHER	25	2 981-7	RETAINER, grease
16	2 993	ARM, control 1/8 x 3/4" cotter PIN 3/8 x 3/4" x 16 ga cd or zn-pltd WASHER	26	2 981-6	KIT, universal joint service (2)
17	2 999	BRACKET, support control arm 1/2 x 1-1/4" cd or zn- pltd mach BOLT (2) 1/2" cd or zn-pltd lock WASHER (2)	27	2 981-4	YOKE and SHAFT ASSEMBLY, thrower half
18	3 008	ROD, lift 1/8 x 3/4" cd or zn-pltd cotter PIN (2) 1/2 x 1-1/8" x .083 ga cd or zn-pltd WASHER (2)		2 741-320 102 592	mounting universal KEY 3/32 x 1-1/4" cotter PIN 3/8 x 3/8" cup-pt allen set SCREW
			28	2 970 273 354	BRACKET, sprocket mounting 3/16" straight drive lubrication FITTING (2) 1/8 x 3/4" cotter PIN (2) mounting PIN
			29	2 983	
			30	359 955 R91	BEARING, needle (2)
				2 988	RUNNER (2) 3/8 x 3/4" cd or zn-pltd crg BOLT w/NUT (4) 3/8" cd or zn-pltd lock WASHER (4)
				3 013	PLATE, deflector 5/16" cd or zn-pltd NUT (2) 5/16 x 1/2" cd or zn-pltd cap SCREW (2) 5/16" cd or zn-pltd lock WASHER (2)



PARTS LIST

BELLCRANK, GEAR BOX, AND IDLER

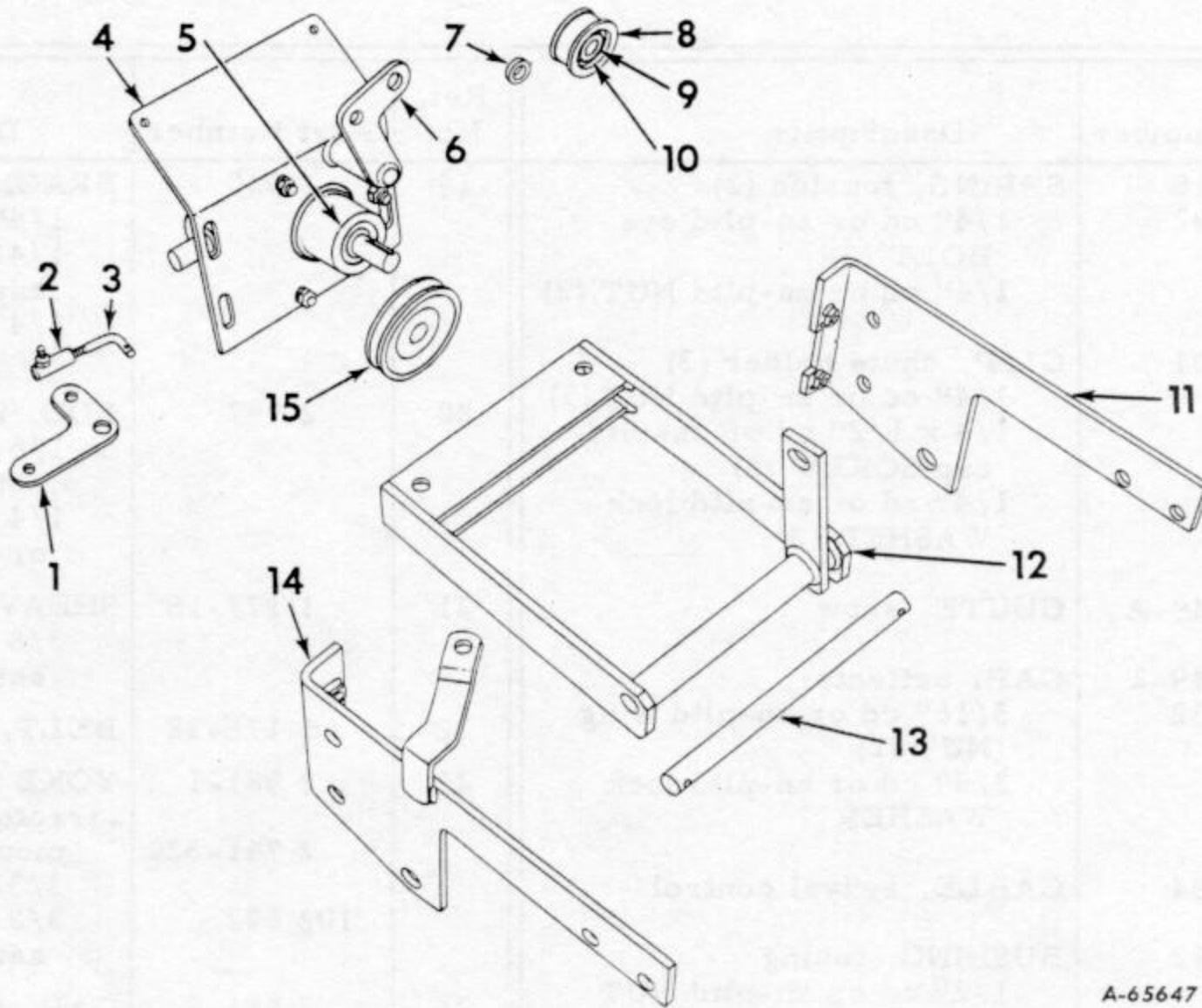

A-65647

Ref. No.	Part Number	Description	Ref. No.	Part Number	Description
1	2 998	BELLCRANK 5/32 x 1" cd or zn-pltd cotter PIN	5	2 952	BOX, gear 5/16" cd or zn-pltd NUT (3) 5/16 x 1-1/4" cd or zn- pltd cap SCREW (3) 5/16" cd or zn-pltd lock WASHER (3)
	33 778 A	1/2 x 7/8" dld-std-hd PIN 17/32 x 1-1/16" x 13 ga cd or zn-pltd WASHER			Consists of the following parts -
2	13 096 D	JOINT, 1/4" ball		2 140-13	BEARING, ball (4)
3	3 017	LINK 1/4" cd or zn-pltd NUT 1/8 x 3/4" cd or zn-pltd cotter PIN 1/4" cd or zn-pltd lock WASHER 1/4 x 1/2" x .049 ga cd or zn-pltd WASHER		3 009	COVER, gear box cover GASKET
				2 720	1/8 NPT PLUG
				444 687	1/4 x 3/4" cd or zn- pltd cap SCREW (4) 1/4" cd or zn-pltd lock WASHER (4)
4	3 005	PLATE, front 3/8 x 1" cd or zn-pltd mach BOLT w/NUT (4) 3/8" cd or zn-pltd lock WASHER (4) 3/8 x 3/4" x 16 ga cd or zn-pltd WASHER (4)		2 713	GEAR, bevel
				2 712	GEAR, bevel pinion
				516 010 R1	RING, retaining (4)
				2 971	SHAFT, input
				2 741-311	3/16 x 3/16 x 11/16" KEY

Continued on next page.

PARTS LIST

BELLCRANK, GEAR BOX, AND IDLER - Continued

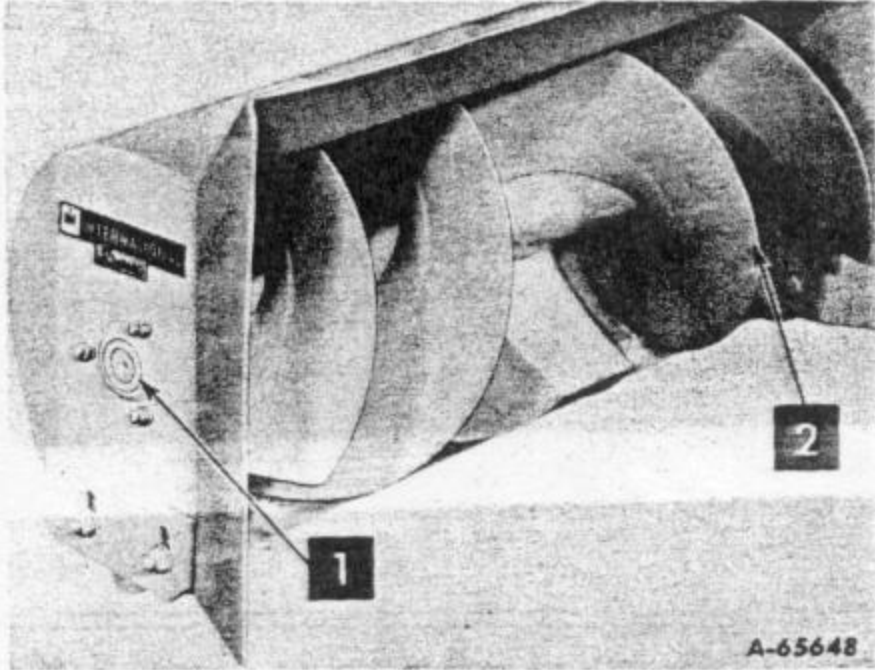
Ref. No.	Part Number	Description	Ref. No.	Part Number	Description
6	2 987	ARM, idler 5/32 x 1" cd or zn-pltd cotter PIN	15	1 177-17 2 741-316 102 592	SHEAVE, lower 3/16 x 3/16 x 1" lower sheave KEY 3/8 x 3/8" cup-pt allen set SCREW
7	2 658	SPACER	<p>ROTOR</p>  <p style="text-align: right;">A-65648</p>		
8	2 977	IDLER w/BEARING			
9	571 395 R91	BEARING			
10	133 213 R1	RING, snap (2) 5/8" cd or zn-pltd NUT 5/8 x 1-3/4" cd or zn- pltd cap SCREW 5/8" cd or zn-pltd lock WASHER 41/64 x 7/8 x 9/32" SPACER			
	2 658				
11	3 003	PLATE, side RH 1/2 x 1-1/4" cd or zn- pltd mach BOLT w/NUT (2) 1/2" cd or zn-pltd lock WASHER (2)			
12	3 006	BRACKET, lift			
13	3 007	SHAFT, pivot 3/16 x 1-1/4" cd or zn- pltd cotter PIN (2)			
14	3 004	PLATE, side LH 1/2 x 1-1/4" cd or zn- pltd mach BOLT (4) 1/2" cd or zn-pltd NUT (2) 1/2" cd or zn-pltd lock WASHER (4)			
			1	1 181-10	BEARING, flange (2) 5/16 x 3/4" cd or zn-pltd crg BOLT w/NUT (6) 5/16" cd or zn-pltd lock WASHER (6)
			2	2 950	ROTOR

