



OPERATOR'S MANUAL

SETTING UP INSTRUCTIONS
PARTS LIST

Rotary Mower (38-inch)

for

INTERNATIONAL[®]
CUB[®] CADET
Tractor

INTERNATIONAL HARVESTER COMPANY

180 North Michigan Ave.

Chicago 1, Illinois, U.S.A.

TO THE OWNER

The purpose of this manual is to assist you in realizing the benefits you anticipated when you purchased this International Harvester product. Literally thousands of people have contributed to the design and production of this product and its delivery to you. They have an interest in its successful performance and have provided this manual to give you the benefit of the experience they have gained through years of field testing and normal usage of this and similar products.

The way you operate and the care you give this product will have much to do with its successful performance. This manual has been carefully prepared and the information arranged and illustrated to make it as easy as possible for you to find the information you wish. It will pay you to read the entire manual carefully before operating and keep it handy for future reference. Your International Harvester Dealer will be glad to answer any further questions you may have on the operation or care of this product.

It is the policy of International Harvester Company to improve its products whenever it is possible and practical to do so. We reserve the right to make changes or add improvements at any time without incurring any obligation to make such changes on products sold previously.

All illustrations and descriptive matter in this publication apply to International Harvester products sold under the International, McCormick, McCormick-International, McCormick-Deering, or McCormick-Deering International trade name.

As a member of the National Safety Council, we are privileged to use the Green Cross for Safety to designate not only our interest in Safety, but to point out more clearly the safety precautions in this manual.

Parts Depots are strategically located at 12 points and Transfer Houses at 7 points in the United States. Ample stocks are maintained at all times to assure prompt shipment to your IH dealer to meet your requirements.

Parts Depots in the United States

Albany 1, N. Y.	Broadview, Ill.	Denver 17, Colo.	Portland 8, Oreg.
Atlanta, Ga.	Columbus 16, Ohio	Kansas City 17, Kans.	Richmond 4, Calif.
(East Point, Ga.)	Dallas 22, Tex.	Memphis 6, Tenn.	St. Paul 4, Minn.
Baltimore 3, Md.			

Transfer Houses in the United States

Broadview, Ill.	Kansas City 17, Kans.	Moline, Ill.	Topeka, Kans.
Council Bluffs, Iowa	Memphis 6, Tenn.	St. Paul 14, Minn.	

District Offices in Canada

Calgary, Alta.	Montreal 14, Que.	Regina, Sask.	Vancouver 4, B. C.
Edmonton, Alta.	Ottawa 1, Ont.	Saint John, N. B.	Winnipeg 10, Man.
Hamilton, Ont.	Quebec 8, Que.	Saskatoon, Sask.	Yorkton, Sask.
London, Ont.			

1-14-61.

International Harvester Sales and Service is maintained in all principal countries of the world.

Export address: International Harvester Export Company, Chicago 1, Illinois, U. S. A.

Canadian address: International Harvester Company of Canada, Ltd., Hamilton, Ont., Canada

INTRODUCTION

The center-mounted 38" rotary mower is designed for use on the International Cub Cadet Tractor.

It is sturdily built throughout, having a housing fabricated from heavy sheet steel. The top of the housing is of flat design to give maximum protection from objects emitting from the swinging blades. It extends beyond the tractor wheels to permit cutting close to shrubbery, trees, fences, buildings, drive and walkway edges, etc.

Skid shoes are part of the main frame and aid in preventing the blades from scraping on uneven terrain.

This mower is equipped with a leaf mulcher as regular equipment.

A discharge safety guard which prevents injury to the operator at the discharge opening is provided with the mower.

Raising and lowering of the mower is done by means of the tractor lift lever.

The mower is driven by a belt from the tractor engine main drive shaft. Two cutting blades are securely attached to their spindle drive blocks and are synchronized by a specially constructed timing belt.

The cutting height is adjustable from 1-inch to 4-inches. Throughout this range and regardless of uneven terrain, mower level is maintained by a unique system of parallel linkage.

Gauge wheels are available on special order.

Illustrations are numbered to correspond with the page number on which they are located. Therefore, if reference is made to Illust. 7B, for example, you know the illustration appears on page 7. The letter "B" indicates that it is the second illustration on that particular page.



SAFETY RULES

No minor should be allowed to operate the mower unless properly supervised.

Never place hands or feet under the mower, in the discharge chute, or near any moving parts while the tractor engine is running. Do not work on the mower with the engine running.

Never leave the tractor engine running unattended or permit it to be operated by persons not acquainted with its use and the rules for safe operation.

Be sure all stones, branches, or other objects that might be picked up and thrown by the mower blades are removed before starting to mow.

Do not allow anyone in the area opposite the discharge chute while mowing. Although the area has been supposedly cleared of foreign objects, small objects may have been overlooked and may be discharged by the mower.

Disengage the mower drive before starting the tractor.

A Careful Operator

IS THE BEST INSURANCE

AGAINST AN ACCIDENT

—National Safety Council.

INSTRUCTIONS FOR ADJUSTING AND OPERATING

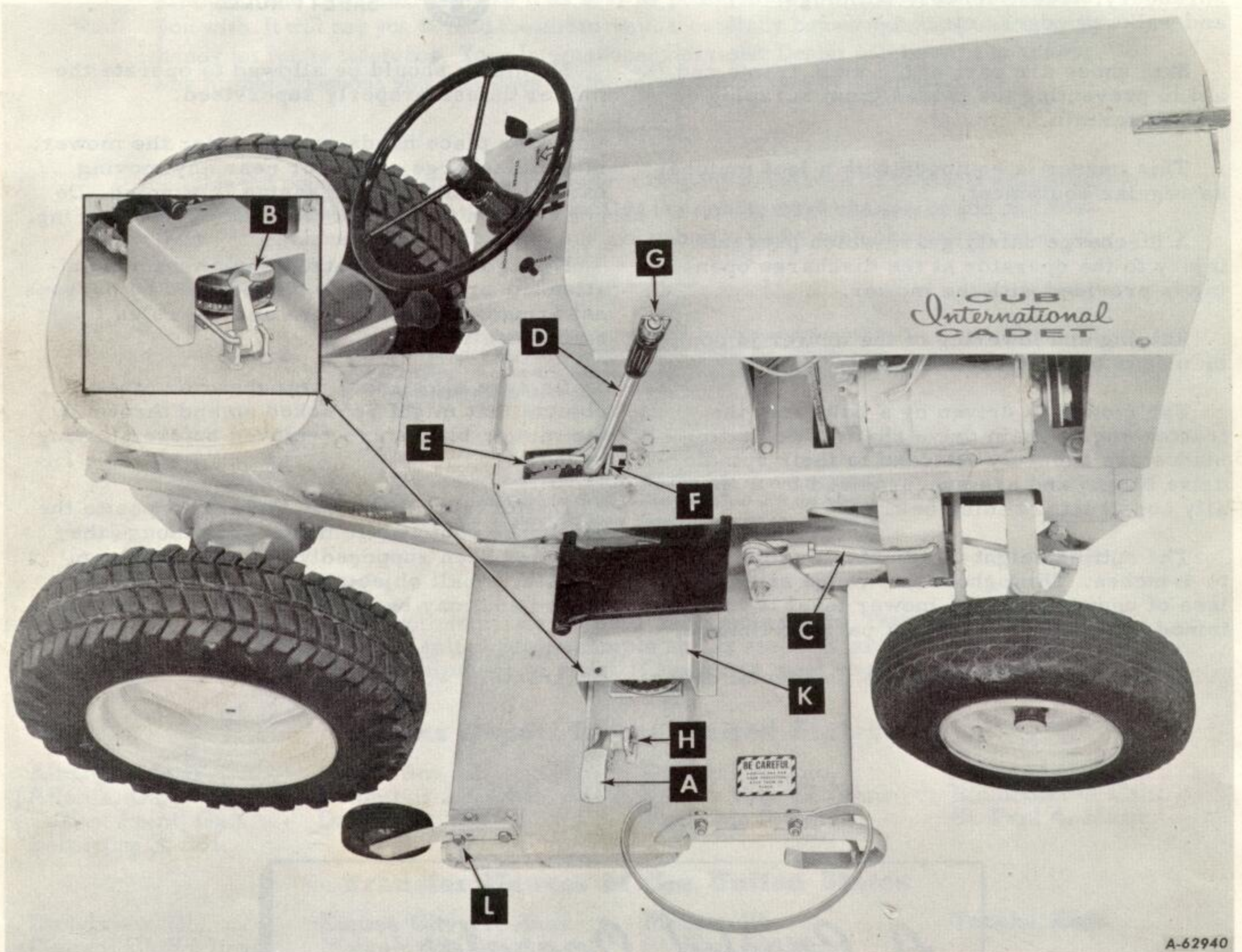

A-62940

Illust. 4A

GENERAL

Check blade timing and the blade drive block cap screws at frequent intervals to be sure the blades are tight and properly timed. Refer to "TIMING THE BLADES", on page 6. At the end of each cutting season check and retighten, if necessary, the eight bolts holding the eccentric bearing housings to the mower. These bolts should be tightened securely.

STARTING AND STOPPING THE MOWER

To start the mower, depress the mower clutch pedal to the right as shown at "A" in Illust. 4A. To stop the mower, raise the clutch pedal as far as possible to the left as shown at "B".

LEVEL ADJUSTMENT

To adjust for proper cutting action, set the mower down on level ground; then remove the upper link rod "C", Illust. 4A from the support and turn the rod so the bottom of the skid shoe at the rear of the mower is 1/4-inch above the ground. Adjust both upper link rods equally so the mower cuts parallel to the ground.

HEIGHT OF CUT

The cutting height is controlled by the lift lever "D" (Illust. 4A) on the tractor.

The cutting height can be adjusted from 1-inch to 4-inches easily and quickly and is maintained at a set level by securing the lift lever in a notch in the quadrant "E", Illust. 4A.

A lift arm stop "F" (Illust. 4A) is provided with the tractor. The stop is used so the mower can be raised, as for an obstacle, and then lowered after the obstacle is crossed,

thereby, maintaining the preset cutting height. Also, by means of the stop, an infinite number of cutting heights are available within the 1-inch to 4-inch range.

When using the lift arm stop, lock the push button "G" on the lift lever to the inoperative position so the mower is free to float up and down.

Raise the mower to the desired cutting height; then adjust the stop so it contacts the lift lever. Tighten the bolt securely.

V-BELT TIGHTENER

Mower V-Belt: To tighten the mower drive short V-belt, remove the clutch pedal pivot pin "H", Illust. 4A and the pedal from the mower and turn the rod into the clevis to shorten. Replace the pedal.

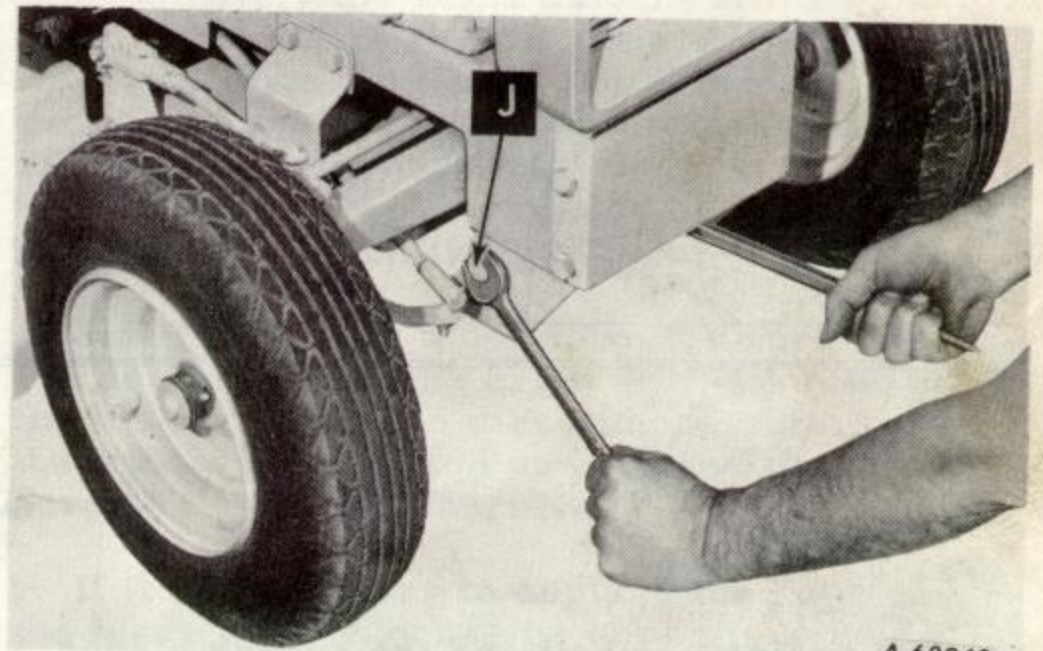

Illust. 5A

Main Drive V-Belt: To tighten the main drive V-belt, loosen the bolt "J", Illust. 5A; then, using a pry bar, adjust the pulley assembly downward, to remove belt slack. Be sure the pulleys are level with the tractor and tighten the bolt securely.

TIMING THE BLADES

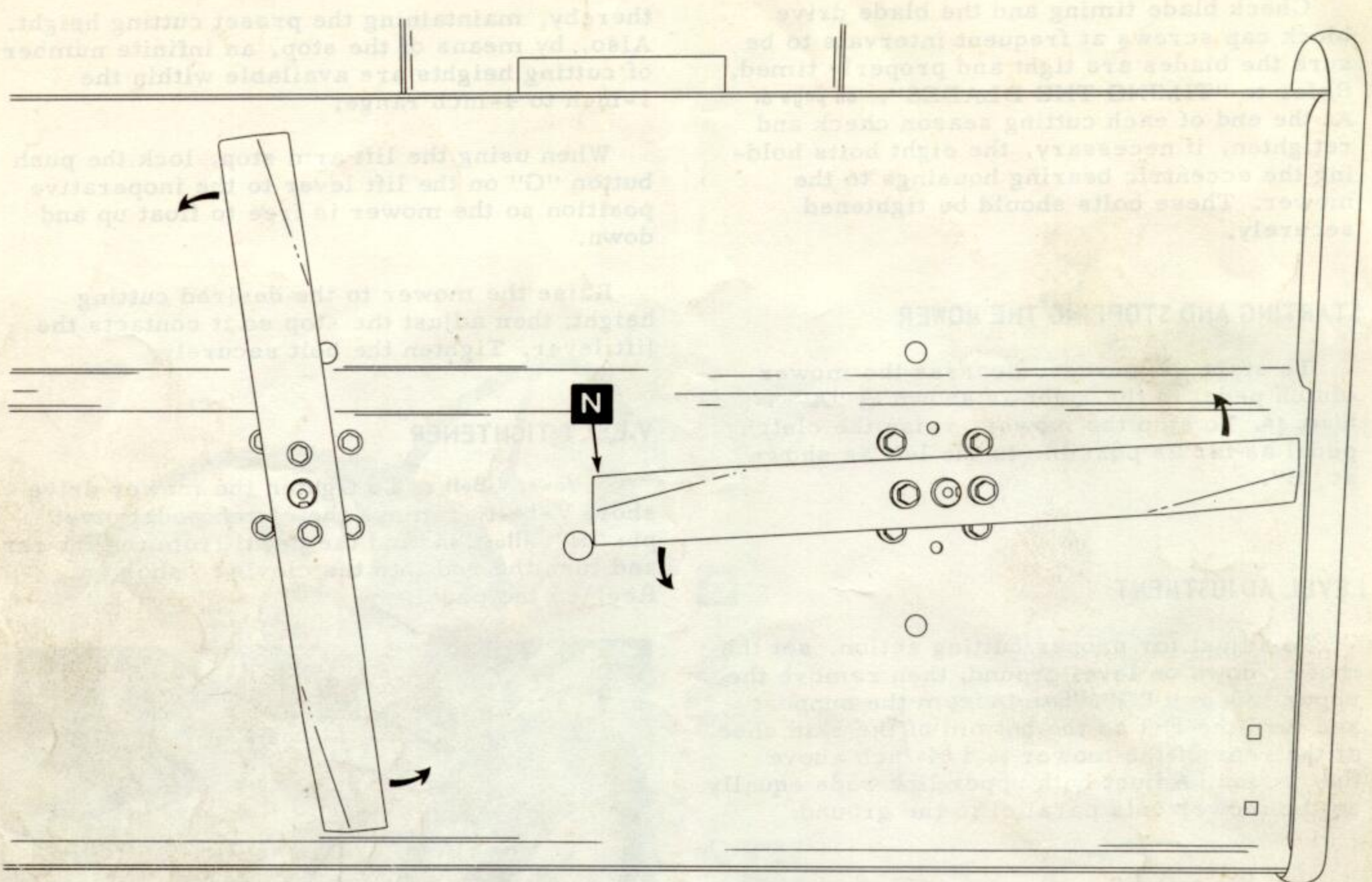

A-62944

Illust. 6A

The timing cog belt and the cutting blades are set at the factory and should not require further adjustment. However, check the blades periodically for correct timing, particularly after an obstruction has been hit.

If an obstruction is hit, stop the mower and raise it to its full height; then look through the discharge opening and check the blades for correct timing.



CAUTION! Never look into the discharge opening while the blades are in motion.

The blades must be at an angle of 90° to each other as shown in Illust. 6A. To time the blades, remove the right pulley shield "K" (Illust. 4A), then slide the cog belt off the right pulley. Turn the pulley until the blade is at an angle of 90° to the other blade; maintain this

relationship and replace the timing cog belt. Replace the pulley shield.

The specially designed and constructed cog belt is made of stretch resistant material and should not require tightening.

If for any reason the cog belt requires tightening, remove the four cap screws from alternate holes in the left eccentric bearing housing on the bottom side of the mower housing and turn the bearing housing one-eighth of a turn in the direction that will tighten the belt; then replace the cap screws. The right eccentric bearing housing can be turned one-quarter of a turn. When tightening the belt, it must deflect a minimum of 1/8-inch under a 10 pound load or the belt is too tight and excessive pulley and belt wear will result. It is recommended that you have your International Harvester dealer tighten the cog belt and replace it when necessary.

GAUGE WHEEL ATTACHMENT (Special)

Gauge wheels are available on special order. They are attached to the rear of the mower on top of the housing at the outer ends. The gauge wheels are used for setting of the cutting height to allow the mower to follow the contour of the ground and aid in preventing scalping of the ground.

The gauge wheels can be adjusted by means of the three holes in the wheel arms. Place bolt "L" (Illust. 4A) in the hole desired. When using the gauge wheels to control the cutting height, lock the push button "G" (Illust. 4A) on the lift lever to the inoperative position so the mower is free to float up and down.

LEAF MULCHER

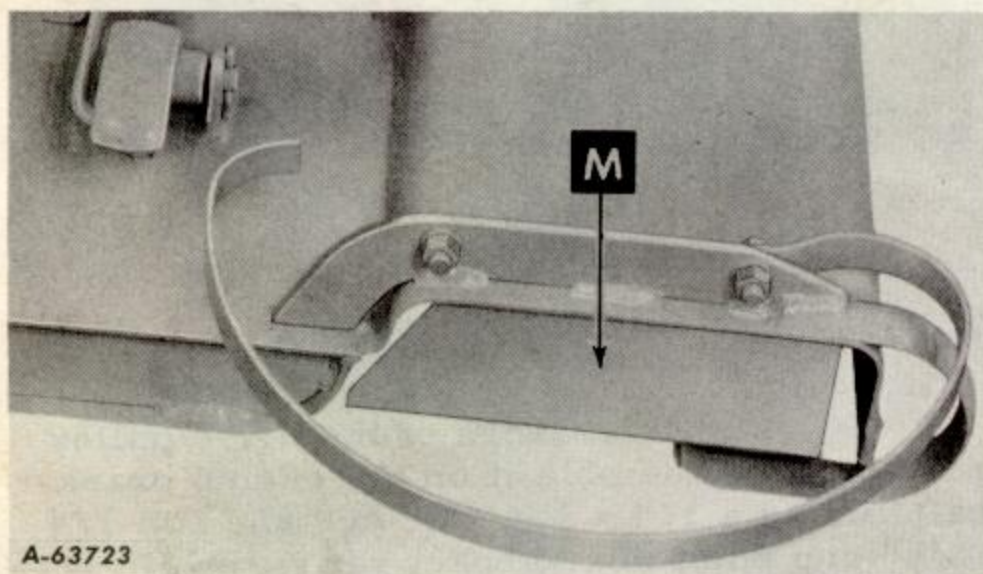

Illust. 7A

A leaf mulcher plate "M" (Illust. 7A) is furnished with the mower. It is bolted to the mower at the discharge opening. The mower is set as low as possible and still allow the leaves to feed under the front of the mower. **DO NOT USE THIS PLATE WHEN MOWING GRASS.** No special cutting blades are required for mulching; the regular blades are used.

MOWING

For best results it is recommended that the first two laps should be cut with the discharge being thrown towards the center. After the first two laps, reverse the direction to throw the discharge to the outside for the balance of cutting. This will give a better appearance to the lawn.

Do not cut the grass too short, as it will give a scalping effect and invite weed growth.

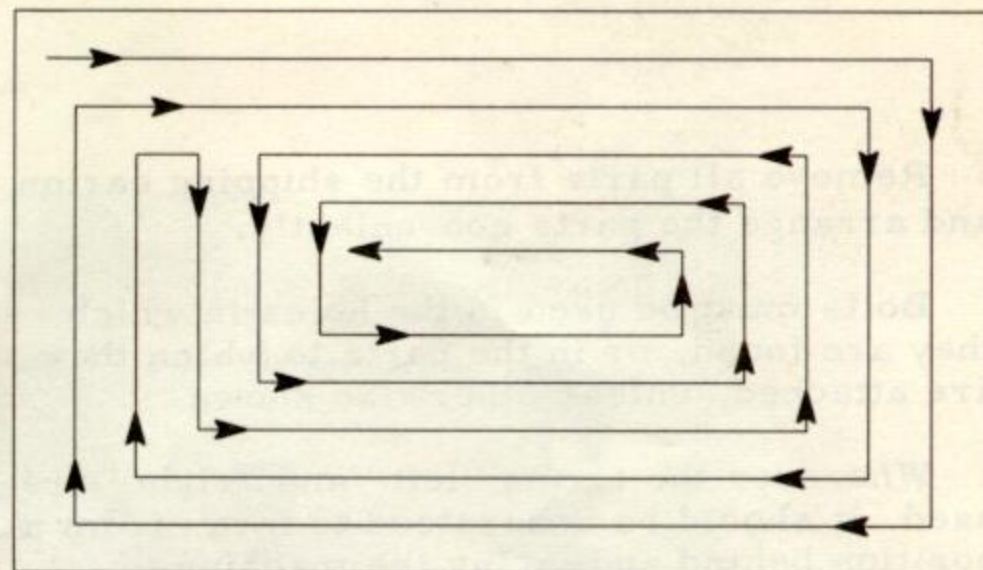

A-62943

Illust. 7B

BLADE CARE

The cutting blades must be kept sharp at all times. The blades can be sharpened on the mower with a few strokes of a file or they can be removed from the mower and sharpened on a grinding wheel. **NOTE:** Always remove approximately the same amount of material from each cutting edge of the blade so excessive blade imbalance does not develop. However, if the cutting edge of the blade is within 3/8-inch of the wind wing "N", Illust. 6A, it is recommended that new blades be installed. New blades are available at your IH dealer.

When replacing the blades, be sure they are assembled on the drive blocks so the cutting edges are in the direction of rotation with the wind wings pointed upward and the cap screws tightened securely.

If it is necessary to replace the keys in the blade drive blocks, be sure the keys do not protrude beyond the blade block. The key should be 15/32" minimum to 1/2" maximum long.

NOTE: If the drive pulley spindles are removed for any reason, they should be tightened to 100 foot-pounds torque when replaced.

CLEANING

Clean the underside of the mower at the end of the mowing season and when the build-up of cut material on the underside is noticed.



CAUTION! Stop the tractor motor before attempting to clean or work on the mower.

SUPPLEMENT TO OPERATOR'S MANUAL
(1 007 477 R2)

ROTARY MOWER
(38-inch)

for

INTERNATIONAL CUB CADET TRACTOR

Prior to the "ASSEMBLY" instructions on page 8, make the following assembly:

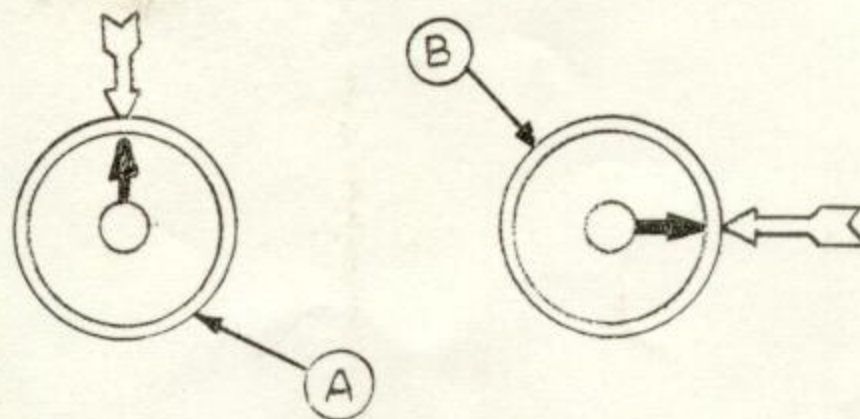

Align the arrows on the cog belt pulleys with the arrows on the mower housing. While maintaining this relationship, place the cog belt on the flanged pulley "A"; then by placing a belt cog between two cogs on the right pulley at "B", turn the belt pulley until the belt rides in place. This procedure will place the cutter blades in the proper position, at right angles to each other.

Place the short V-belt on the mower drive pulley and the left cog belt pulley. See Illust. 8A.

Insert the two 3/8 x 1" hex-hd. machine bolts down through the holes in the left pulley shield and secure with lock washers and nuts. See Illust. 8A. These bolts are used as belt retainers to keep the short V-belt from coming off the pulley when the mower is declutched.

Bolt the shields to the mower, using four 1/4 x 1/2" carriage bolts, lock washers, and nuts. See Illust. 8A.

INTERNATIONAL HARVESTER COMPANY

180 North Michigan Ave.

Chicago 1, Ill. U. S. A.

INSTRUCTIONS FOR SETTING UP

Remove all parts from the shipping carton and arrange the parts conveniently.

Bolts must be used in the holes in which they are found, or in the parts to which they are attached, unless otherwise shown.

Wherever the terms "left" and "right" are used, it should be understood to mean from a position behind and facing the machine.

ASSEMBLY

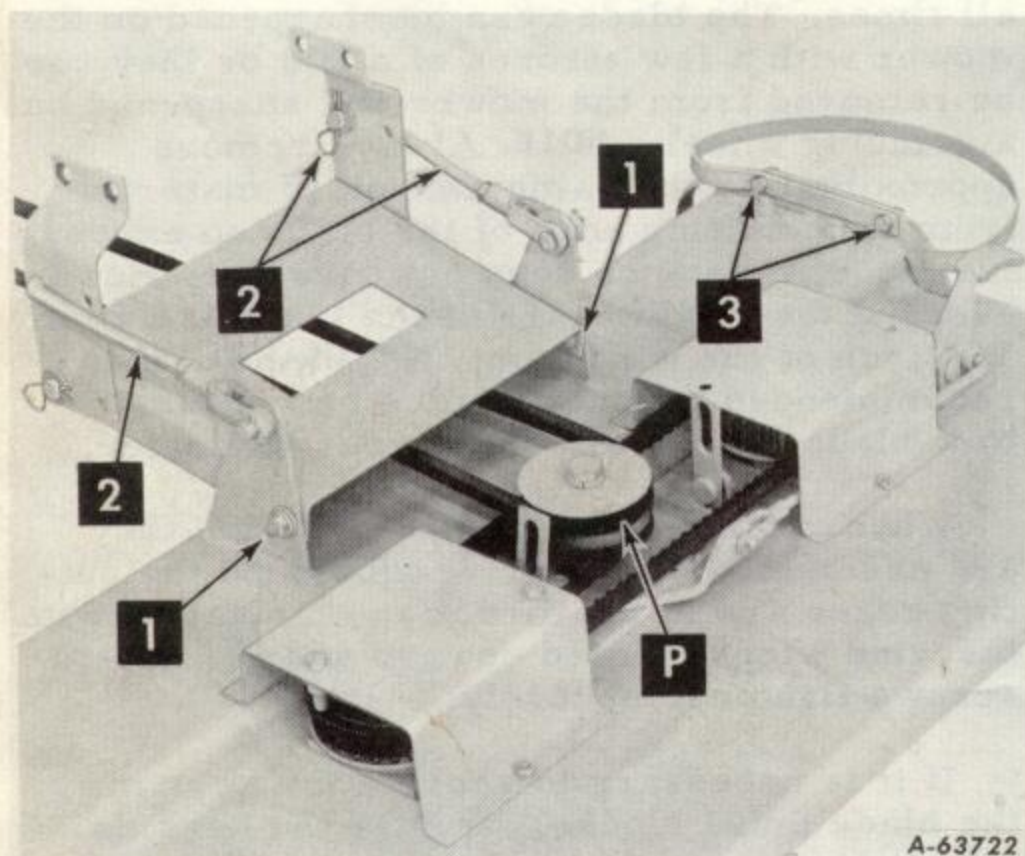

Illust. 8A

1. Bolt the lower parallel link with the supports and the pivot rod to the mower, using two $3/8 \times 1$ " carriage bolts, spacers, $13/32 \times 1$ " x 11 ga. plain washers, lock washers, and nuts.

2. Attach both upper parallel link rods to the supports and secure, using two $17/32 \times 1$ " x 16 ga. plain washers and quick-attachable cotter pins.

3. Bolt the discharge opening safety guard to the mower, using two $3/8 \times 1$ " hex-hd. machine bolts, lock washers, and nuts. Bolt heads must point toward the center of the mower.

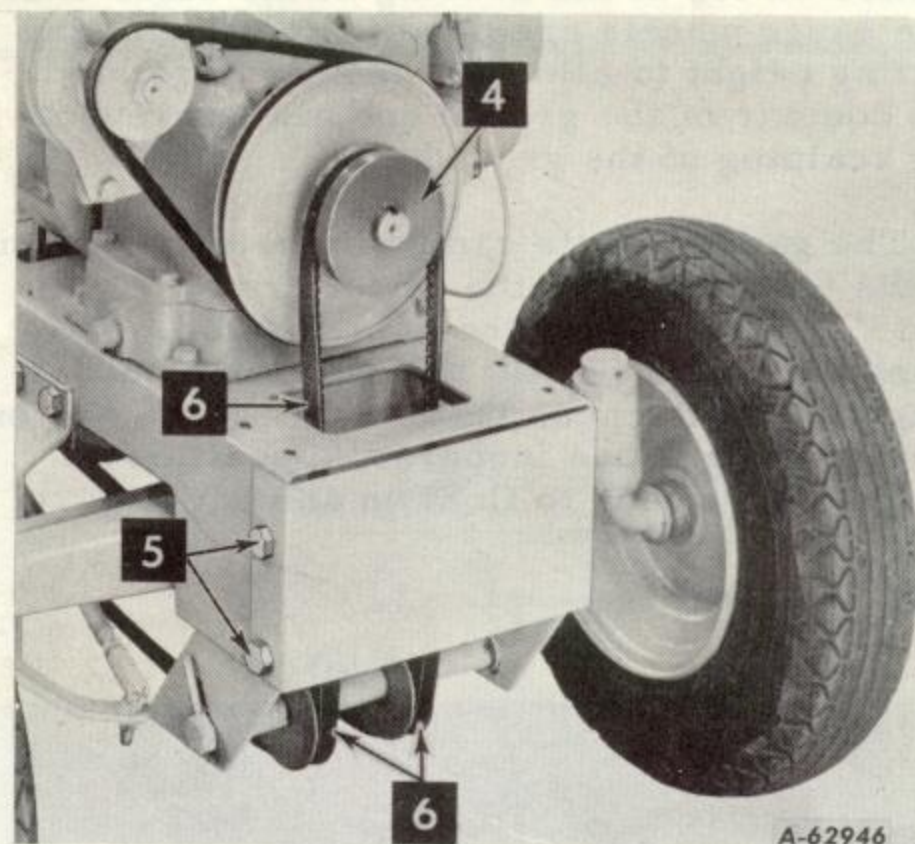

Illust. 8B

4. With the wide flange of the drive pulley to the front, assemble it on the engine crankshaft, using a $1/4 \times 1/4 \times 1$ " key and two $1/4 \times 1/4$ " cup point hex. socket set screws. Secure the cup point set screws with $1/4 \times 1/4$ " flat point hex. socket screws.

Tractors with Electric Starter: Assemble the drive pulley flush against the starter-generator engine pulley as shown.

Tractors without Electric Starter: Assemble the drive pulley so the wide flange face of the pulley is $5/16$ " from the front end of the engine crankshaft.

NOTE: For convenience of assembling the main drive pulley, the hood and grille can be removed.

5. Bolt the belt tightener pulley assembly and the shield to the tractor frame, using four $1/2 \times 1$ " hex-hd. machine bolts and lock washers.

6. Position the mower under the tractor. Place the main drive belt between the pivot rod and the lower parallel link and over the mower drive pulley "P" (Illust. 8A), the belt tightener pulleys, and the engine main drive pulley. Be certain the tightener pulleys are in the top of the adjusting slot.

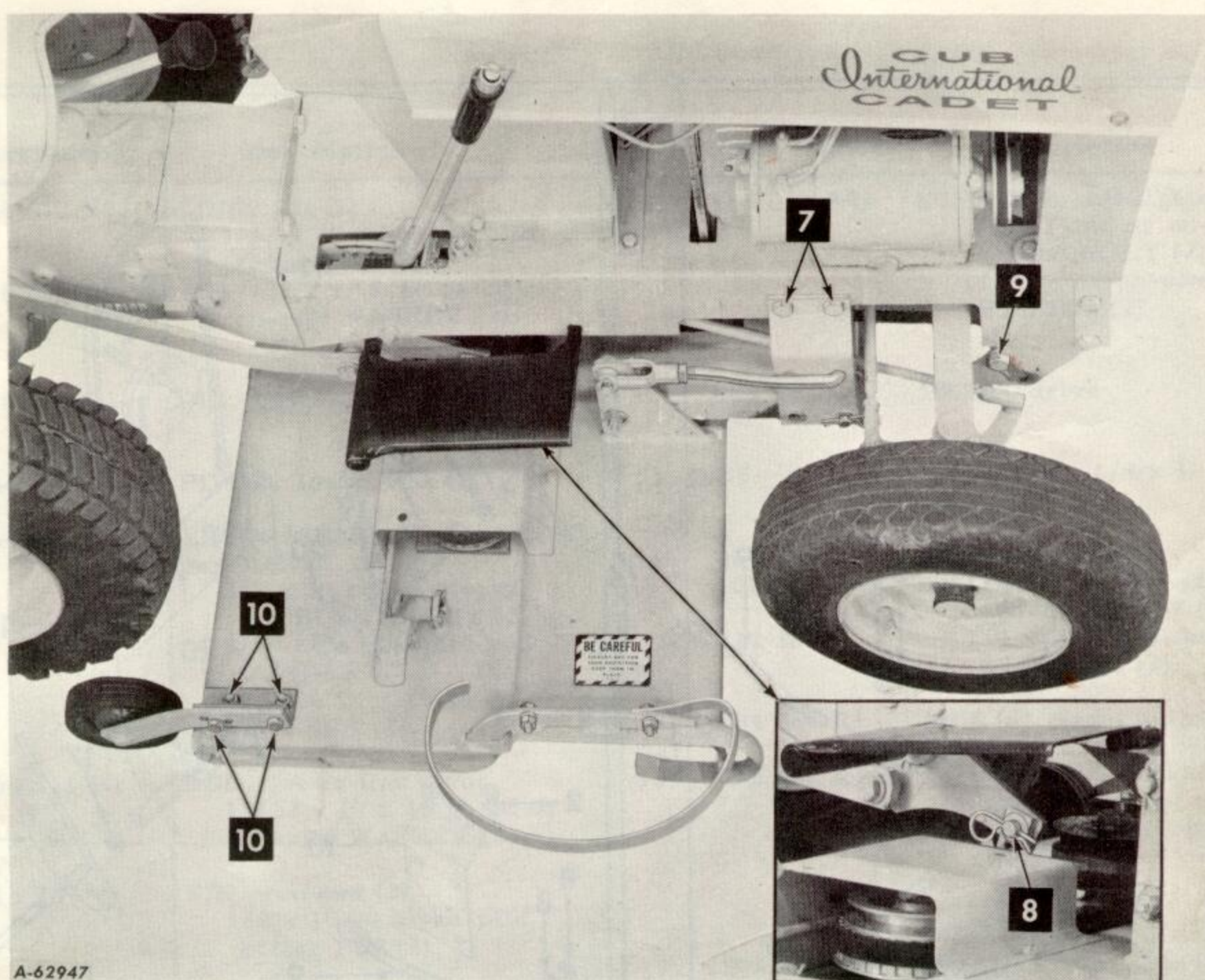

Illust. 9A

7. Bolt the parallel link supports to the tractor frame, using four 1/2 x 1" hex-hd. machine bolts, lock washers, and nuts.

8. Attach the mower to the lift arms and secure, using two 17/32 x 1" x 11 ga. plain washers and quick-attachable cotter pins.

9. Tighten the main drive belt. Also refer to "V-Belt Tightener" on page 5.

Adjust the mower upper link rods as described in "Level Adjustment" on page 5.

10. Mowers with Gauge Wheels: Bolt the angle brackets to the mower, using 3/8 x 3/4" carriage bolts, lock washers, and jam nuts. Place a 17/32 x 1" x 16 ga. plain washer on each gauge wheel arm axle, attach the gauge wheels to the axles with the nylon bearing hub toward gauge wheel arm, and secure, using 17/32 x 1" x 16 ga. plain washers and cotter pins. Then, using the hole in the arm which gives the desired height, bolt the assemblies to the angles on the mower, using 3/8 x 1" cap screws, lock washers, and jam nuts. See Illust. 9A.

PARTS LIST

HITCH AND DRIVE UNIT

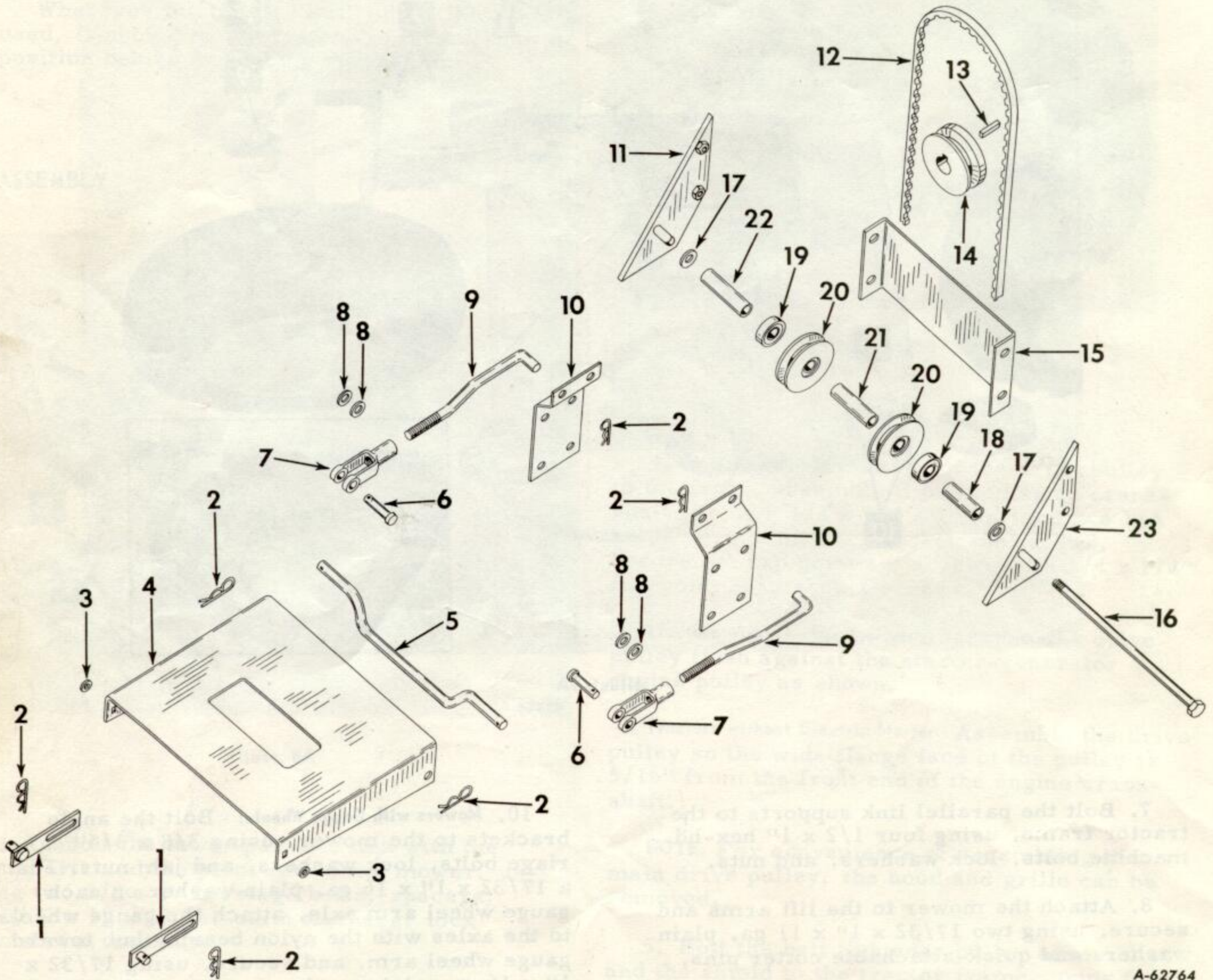

Illustr. 10A

A-62764

PARTS LIST

HITCH AND DRIVE UNIT - Continued

Ref. No.	Part Number	Description	Ref. No.	Part Number	Description
1	464 513 R91 178 373 R1	LINK, lift (2) 3/32 x 1" cd or zn-pltd cotter PIN (2) 17/32 x 1" x 16 ga cd or zn-pltd WASHER (2)	11	465 057 R91	SUPPORT, LH tightener 1/2 x 1" cd or zn-pltd hex-hd BOLT (2) 1/2" cd or zn-pltd lock WASHER (2)
2	610 784 R1	PIN, quick-attachable (6)	12	464 362 R1	BELT, drive
3	464 510 R1	PIVOT, lower link (2)	13	Q 53	KEY, 1/4 x 1/4 x 1" sq- parallel
4	464 507 R91	LINK ASSEMBLY, lower parallel 3/8 x 1" cd or zn-pltd crg BOLT w/NUT (2) 3/8" cd or zn-pltd lock WASHER (2) 13/32 x 1" x 16 ga WASHER (2)	14	464 358 R1 102 569 222 386	PULLEY, engine 1/4 x 1/4" cup-pt hex- soc-hd SCREW (2) 1/4 x 1/4" f-pt hex-soc- hd SCREW (2)
5	464 511 R1	ROD, lower link pivot 17/32 x 1" x 16 ga cd or zn-pltd WASHER (2)	15	464 364 R1	SHIELD, front pulley
6	114 787	PIN, rod end (2) 1/8 x 1" cd or zn-pltd cotter PIN (2)	16	18 030 R11	BOLT w/NUT 5/8 x 10" cd or zn-pltd hex-hd mach 5/8" cd or zn-pltd lock WASHER
7	104 039	CLEVIS, rod end (2)	17	578 274 R1	WASHER, 21/32 x 1" x 11 ga (2)
8	27 927 DA	17/32 x 7/8" x 8 ga WASHER (4)	18	464 360 R1	SPACER, right idler
9	464 512 R1 124 934	ROD, upper link (2) 1/2" UNF cd or zn-pltd jam NUT (2) 17/32 x 1" x 16 ga WASHER (2)	19	582 010 R91	BEARING (2)
10	464 509 R1	SUPPORT, upper parallel link (2) 1/2 x 1" cd or zn-pltd hex-hd mach BOLT (4) 1/2" cd or zn-pltd lock WASHER (4)	20	464 352 R91	PULLEY w/BEARINGS (2)
			21	464 363 R1	SPACER, center idler
			22	464 361 R1	SPACER, left idler
			23	465 058 R91	SUPPORT RH, tightener 1/2 x 1" cd or zn-pltd hex-hd BOLT (2) 1/2" cd or zn-pltd lock WASHER (2)

CUB Ser.# 351550-R7
n Model K1C1S

4-21-61

PARTS LIST

MAIN FRAME AND KNIFE UNIT

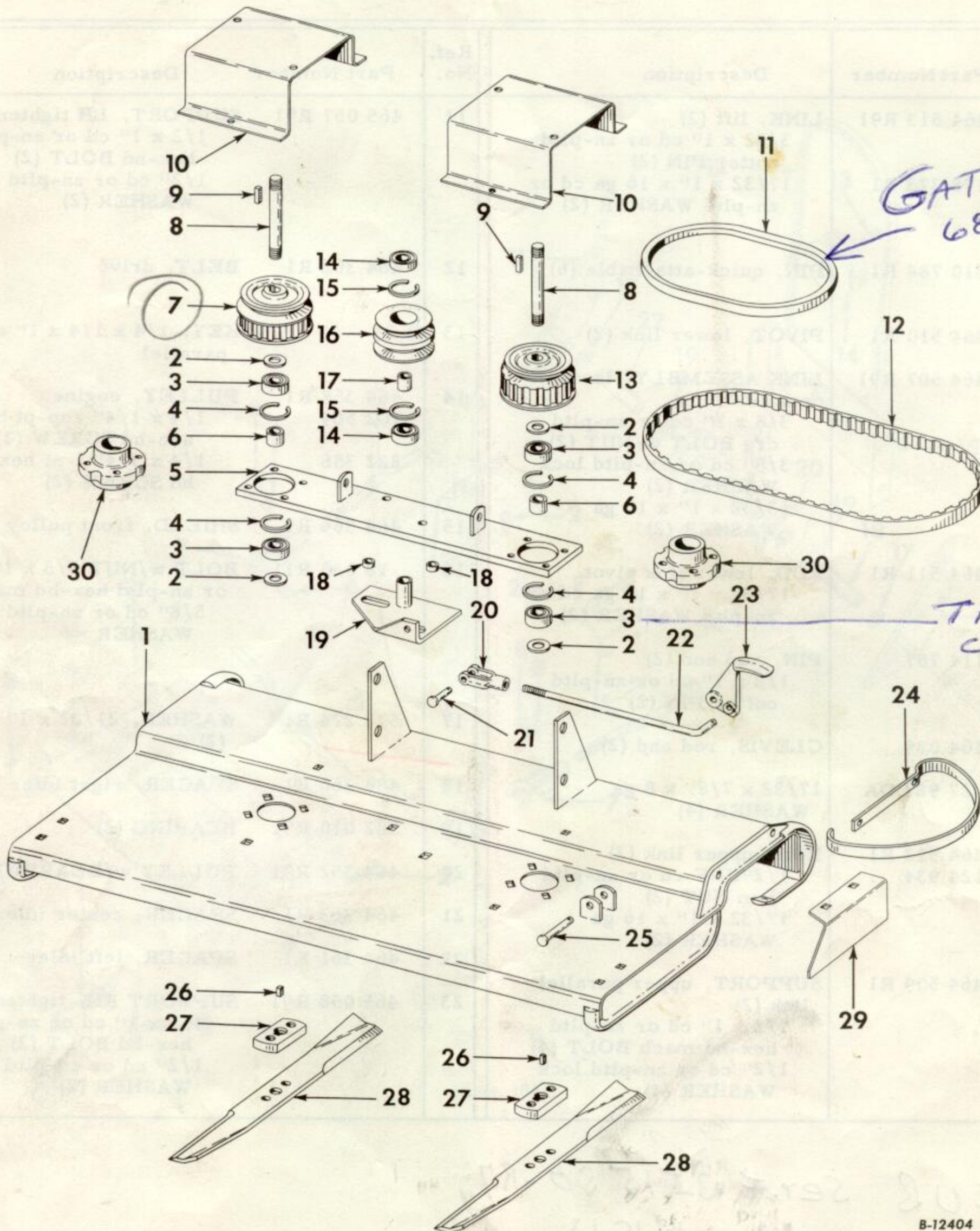

Illust. 12A

B-12404

PARTS LIST

MAIN FRAME AND KNIFE UNIT - Continued

Ref. No.	Part Number	Description	Ref. No.	Part Number	Description
1	464 495 R91	HOUSING, rotor 1/4 x 1/2" cd or zn-pltd crg BOLT w/NUT (4) 1/4" lock WASHER (4)	17	464 357 R1	SPACER, double vee pulley
2	16 066 R1	WASHER, 25/32 x 1-1/2" x 16 ga (4)	18	464 531 R1	SPACER (2)
3	464 347 R91	BEARING (4)	19	464 526 R91	SUPPORT, pulley 3/8 x 1" cd or zn-pltd crg BOLT w/NUT (2) 3/8" cd or zn-pltd lock WASHER (2) 13/32 x 1" x 16 ga WASHER (2)
4	464 346 R1	SNAP RING (4)	20	114 242	CLEVIS, rod end
5	464 340 R91	HOUSING, bearing 3/8 x 7/8" hex-hd cap SCREW (8) 3/8" internal tooth lock WASHER (8)	21	114 784	PIN, clevis rod end 3/32 x 3/4" cd or zn-pltd cotter PIN 11/32 x 3/4" x 16 ga WASHER
6	464 533 R1	SPACER (2)	22	464 530 R1	ROD, clutch
7	464 343 R91	PULLEY ASSEMBLY, spindle drive LH	23	464 529 R1	HANDLE, clutch
8	464 534 R1 17 296 R1	SHAFT, spindle (2) 3/4" UNF cd or zn-pltd esna stop NUT (2)	24	464 506 R1	SHIELD, discharge opening 3/8 x 1" cd or zn-pltd mach. BOLT w/NUT (2) 3/8" lock WASHER (2)
9	235	KEY, 1/4 x 1/4 x 1" sq- parallel (2)	25	D 3 375	PIN, 1/2 x 2-1/8" dld-std- hd 3/16 x 1" cotter PIN
10	464 505 R1	SHIELD, pulley (2) 3/8 x 1" cd or zn-pltd hex-hd BOLT (2) 3/8" cd or zn-pltd NUT (2) 3/8" lock WASHER (2)	26	235	KEY, 1/4 x 1/4 x 1/2" sq- parallel (2)
11	464 351 R1	BELT, spindle drive	27	464 349 R1	BLOCK, blade drive (2)
12	464 348 R1	BELT, timing (regular)	28	464 350 R1	BLADE, rotor (2) 1/2 x 3/4" hex-hd cap SCREW (4) 1/2" internal tooth lock WASHER (4)
12	464 860 R1	BELT, timing (heavy duty)			
13	464 345 R1	PULLEY, spindle drive RH			
14	582 010 R91	BEARING (2)	29	464 859 R1	MULCHER, leaf 3/8 x 3/4" cd or zn-pltd crg BOLT w/NUT (2) 3/8" cd or zn-pltd lock WASHER (2)
15	464 356 R1	SNAP RING (2)			
16	464 355 R1	PULLEY, double vee 5/8" UNF x 3" cd or zn- pltd hex-hd cap SCREW 5/8" cd or zn-pltd lock WASHER	30	464 341 R1	HOUSING, bearing (2)

PARTS LIST

GAUGE WHEEL ATTACHMENT

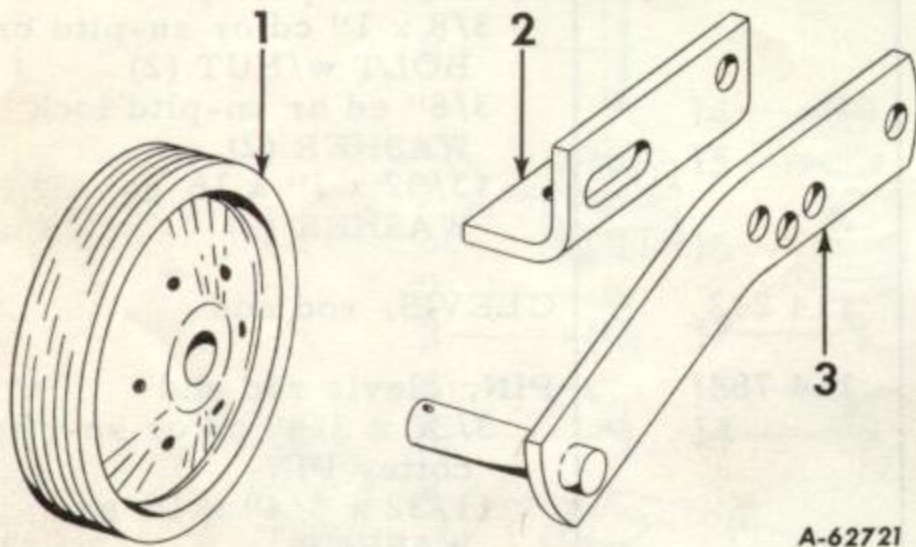

Illust. 14A

Ref. No.	Part Number	Description
1	464 521 R1	WHEEL, gauge (2) 1/8 x 1" cd or zn-pltd cotter PIN (2) 17/32 x 1" x 16 ga WASHER (6)
2	464 524 R1	BRACKET, gauge wheel LH
2	464 525 R1	BRACKET, gauge wheel RH
	124 829	3/8 x 3/4" cd or zn-pltd crg BOLT (4) 3/8" cd or zn-pltd jam NUT (4) 3/8" cd or zn-pltd lock WASHER (4)
3	464 516 R91	ARM, gauge wheel LH
3	464 517 R91	ARM, gauge wheel RH
	124 829	3/8" cd or zn-pltd jam NUT (4) 3/8 x 1" cd or zn-pltd hex-hd cap SCREW (4) 3/8" cd or zn-pltd lock WASHER (4)

Play Safe

INSIST ON  PARTS

WHEN you bought your International Harvester tractor or machine, you made a good choice—you have a machine that deserves good care and good service. When wear and tear make new parts necessary, remember why you bought an International Harvester *Quality* Product. You bought quality to be sure of performance. Don't handicap your equipment by careless selection of replacement parts.

PLAY SAFE! Go to the International Harvester dealer for IH parts. The IH trademark is your guarantee of quality, your best assurance that your International Harvester equipment will continue to give you top-grade performance, no matter what you ask of it.



Installing Instructions

SPINDLE SHAFT AND BEARING PACKAGE
(470 849 R91)

for

Rotary Mower
(38-inch)

for

INTERNATIONAL®

CUB CADET®

Tractor

INTERNATIONAL HARVESTER COMPANY

180 North Michigan Ave.

Chicago 1, Illinois, U.S.A.



Accidents can be prevented with your help

No accident-prevention program can be successful without the wholehearted co-operation of the person who is directly responsible for the operation of equipment.

To read accident reports from all over the country is to be convinced that a large number of accidents can be prevented only by the operator anticipating the result before the accident is caused and doing something about it. No power-driven equipment, whether it be transportation or processing, whether it be on the highway, in the harvest field or in the

industrial plant, can be safer than the man who is at the controls. If accidents are to be prevented—and they can be prevented—it will be done by the operators who accept a full measure of their responsibility.

It is true that the designer, the manufacturer, the safety engineer can help; and they will help, but their combined efforts can be wiped out by a single careless act of the operator.

It is said that "*the best kind of a safety device is a careful operator.*" We ask you to be that kind of an operator.

As a member of the National Safety Council, we are privileged to use the Green Cross for Safety to designate not only our interest in Safety, but to point out more clearly the safety precautions in this manual.

NATIONAL SAFETY COUNCIL



The Symbol of Quality Products

Backed By A Dealer Organization
Equipped To Give You —

Service Where You Need It

District Offices in the United States

Aberdeen, S. Dak.
302 First Ave., S.W.
P.O. Box 490
Tel. Baldwin 5-6200

Amarillo, Tex.
714 East 10th St.
P.O. Box 1071
Tel. Drake 3-8373

Atlanta 3, Ga.
580 Whitehall St., S. W.
P.O. Box 4838
Atlanta 2, Ga.
Tel. Murray 8-4440

Baltimore 5, Md.
6501 Quad Ave.
Tel. Edmondson 6-4700

Billings, Mont.
20 South Broadway
P.O. Box 2515
Tel. 4-4144

Birmingham 4, Ala.
931 North 24th St.
P.O. Box 2573
Birmingham 2, Ala.
Tel. Alpine 1-6274

Broadview, Ill.
1301 West 22nd St.
P.O. Box 126
Tel. Fillmore 3-3800

Camden, N. J.
Suckle Ave. and
National Rd.
Pennsauken 11, N. J.
P.O. Box 1928
Camden 1, N. J.
Tel. Normandy 5-3500

Cedar Rapids, Iowa
4401 Sixth St. Road, S.W.
P.O. Box 589
Tel. Empire 5-6921

Charlotte 6, N. C.
1315 No. Graham St.
P.O. Box 2029
Charlotte 1, N. C.
Tel. Edison 4-2851

Columbus 4, Ohio
3700 Sullivant Ave.
P.O. Box 2797
Tel. Broadway 9-7392

Dallas 15, Tex.
1809 South Lamar St.
P.O. Box 5145
Dallas 22, Tex.
Tel. Riverside 2-3413

Denver 16, Colo.
4233 East 46th Ave.
P.O. Box 5028
Denver 17, Colo.
Tel. Florida 5-4481

Des Moines 16, Iowa
1901 East University Ave.
P.O. Box 1437
Des Moines 5, Iowa
Tel. Amherst 6-1191

Fargo, N. Dak.
700 First Ave., North
P.O. Box 591
Tel. Adams 5-6436

Grand Island, Nebr.
2400 West Second St.
Tel. Dupont 2-1300

Harrisburg, Pa.
1017 Maclay St.
P.O. Box 84
Tel. Cedar 8-5277

Houston 11, Tex.
4619 Navigation Blvd.
P.O. Box 1420
Houston 1, Tex.
Tel. Walnut 3-2841

Indianapolis 7, Ind.
1065 W. Washington St.
Tel. Melrose 9-1491

Jacksonville 1, Fla.
1986 West Beaver St.
P.O. Box 869
Tel. Elgin 6-8451

Kansas City 15, Kans.
3201 McCormick Road
Tel. Finley 2-7200

Lansing 6, Mich.
1800 Grand River Ave.
P.O. Box 1316
Lansing 4, Mich.
Tel. Ivanhoe 5-2215

Lexington, Ky.
1105 Eastland Drive
P.O. Box 481
Tel. 2-6008

Little Rock, Ark.
3601 W. 65th St.
P.O. Box 2541
Tel. Locust 5-5576

Los Angeles, Calif.
530 N. Baldwin Park Blvd.
P.O. Box 2147
City of Industry, Calif.
Tel. Yorktown 2-3271

Madison 4, Wis.
2320 Darwin Road
P.O. Box 1111
Madison 1, Wis.
Tel. Cherry 9-2181

Mason City, Iowa
25 Nineteenth St., S.W.
P.O. Box 201
Tel. Garden 3-6513

Memphis 6, Tenn.
237 West Olive Ave.
P.O. Box 2864
Memphis 2, Tenn.
Tel. Whitehall 2-3261

Minneapolis, Minn.
2572 University Ave.
St. Paul 14, Minn.
Tel. Midway 6-7301

Minot, N. Dak.
11 Second St., N.E.
Tel. Temple 2-1151

New Orleans 19, La.
501 North Alexander St.
P.O. Box 19285
Tel. Hunter 2-2181

Oakland 8, Calif.
2855 Cypress St.
P.O. Box 4676
Oakland 23, Calif.
Tel. Glencourt 2-2828

Oklahoma City 8, Okla.
5125 W. Reno Ave.
P.O. Box 1337
Oklahoma City 1, Okla.
Tel. Windsor 6-2687

Omaha 2, Nebr.
1201 South 16th St.
P.O. Box 1653
Omaha 8, Nebr.
Tel. Harney 8200

Peoria, Ill.
407 Rock Island Ave.
P.O. Box 1019
Tel. 685-7687

Pittsburgh, Pa.
1000 Ferry St.
Leetsdale, Pa.
Tel. Poplar 6-7600

Portland 22, Oreg.
2001 S.E. Harvester Drive
P.O. Box 5967
Tel. Olive 4-5481

Richmond 30, Va.
1905 Westmoreland St.
P.O. Box 6857
Tel. Elgin 5-7907

St. Louis, Mo.
5902 No. Lindbergh Blvd.
Hazelwood, Mo.
Tel. Pershing 1-0430

St. Paul 14, Minn.
2572 University Ave.
Tel. Midway 6-7301

Salt Lake City 1, Utah
435 W. Fourth South St.
P.O. Box 660
Salt Lake City 10, Utah
Tel. Empire 4-7861

Sioux Falls, S. Dak.
196 East Sixth St.
Tel. Edison 4-9921

Spokane 3, Wash.
715 East Sprague Ave.
P.O. Box 223
Spokane 10, Wash.
Tel. Madison 4-9271

Springfield, Ill.
217 North Ninth Street
P.O. Box 99
Tel. Lakeside 2-4481

Springfield, Mass.
P.O. Box 514
Westfield, Mass.
Tel. Logan 8-8651

Syracuse 1, N. Y.
210 Teall Avenue
P.O. Box 979
Tel. Granite 4-2923

Wichita 19, Kans.
410 E. 37th St. North
P.O. Box 1720
Wichita 1, Kans.
Tel. Temple 8-1495

INTERNATIONAL HARVESTER COMPANY • 180 NORTH MICHIGAN AVENUE • CHICAGO 1, ILLINOIS, U.S.A.
1-14-61.

DO CUT

216 533 9878