

TC-82



INTERNATIONAL®

PARTS CATALOG

**INTERNATIONAL
CUB® CADET
TRACTOR
and
IMPLEMENTS**

INTERNATIONAL HARVESTER COMPANY

180 North Michigan Avenue

Chicago 1, Illinois, U.S.A.

The Importance of ADEQUATE PARTS and SERVICE

The wise purchaser of a new machine gives consideration to the following factors:

1. *Original quality*
2. *Availability of service parts*
3. *Availability of adequate service facilities*

In many cases the machine becomes the only means of performing certain tasks that must be done in a limited period of time. Wear and even breakage of parts are to be expected due to operating conditions. However, the user can still be assured of getting his work done on time if service parts and adequate service facilities are available.

Foresighted International Harvester dealers make every effort to provide good service and maintain a completely adequate stock of service parts.

INSTRUCTIONS FOR ORDERING PARTS

- (a) All parts orders should be sent to the control district office or parts depot when so instructed. Give complete address, state the county and railroad station (when shipping point is different than post office), also whether shipment is to go by parcel post, express, truck, or freight.
- (b) When ordering parts, give the IH part number, including suffix or prefix letters. To facilitate identification of these parts, "Serial Numbers" assigned to machines, if any, should be furnished.
- (c) Parts should be ordered on the standard parts order blank. The parts should be arranged in sequence by part numbers to facilitate service on orders at the control district office or parts depot.
- (d) Claims for shortage or error in the handling of an order for parts must be made upon receipt of goods.

All illustrations and descriptive matter in this publication apply to International Harvester products sold under the International, McCormick, McCormick-International, McCormick-Deering, or McCormick-Deering International trade name.

It is the policy of International Harvester Company to improve its products whenever it is possible and practical to do so.

We reserve the right to make changes or add improvements in the design or construction of parts at any time without incurring the obligation to install such changes on products previously delivered.

CONTENTS

	Page
INTERNATIONAL CUB CADET TRACTOR	5
IMPLEMENTS	
BLADE (42-Inch)	35
HARROW, Peg-Tooth, No. 1	47
MOWER, Rotary	39
TRAILER, No. 1 (Two-Wheel, Latch-Dump)	45

IMPORTANT

REVISION NO. 2

Place these new pages in your Loose-Leaf

TC-82

PARTS CATALOG

FOR

INTERNATIONAL CUB CADET TRACTOR AND IMPLEMENTS

Note—This is a complete revision

Retain your old catalog cover and replace the contents of the TC-82 Parts Catalog, including Revision No. 1, with the complete Revision No. 2.

INTRODUCTION

This catalog contains a complete list of service parts for the International Cub Cadet Tractor. The tractor has a one-cylinder 2-7/8 x 2-1/2 inch (K-161 series) Kohler engine. Also included in this catalog, are lists of service parts for all available implements.

As new equipment is developed and introduced to the territory, or when changes are made on equipment already in catalog form, new or supplementary loose-leaf pages will be issued.

Following is a brief summary of the system used in compiling this catalog. It is to your advantage to carefully study this summary.

(1) General. This catalog is divided into three sections---Introductory pages; Indexes to Units, Illustrations and Parts Lists; and Numerical Index.

(2) Indexes. There are three types of indexes in this catalog, viz.

A. Contents of Implements listed on page 1.

B. Separate Implement Indexes to Units which includes -

- (1) Equipment Illustration.
- (2) Equipment model designation and description.
- (3) Years built.
- (4) Basic units comprising equipment (If applicable).
- (5) Mounting frames or completing packages, adapting a basic implement to specific tractor models (If applicable).
- (6) Attachments.
- (7) Conversion packages.

C. Numerical index of part numbers (excluding standard fasteners) at the end of the catalog.

NOTE - It is important that you refer frequently to the Index to Units. Failure to do so will result in not being able to locate the proper unit.

(3) Illustrations. The "Exploded View" method which is used in this catalog, illustrates the parts in groups or units. This makes it easy to locate parts whether they are ordered by description or by part number. Reference numbers only are shown in each illustration. These numbers correspond to those in the reference number column in the list of parts associated with each "Exploded View". Reference numbers usually start in the upper left-hand corner of the view and continue in clockwise order wherever possible. Unnumbered parts are the same as corresponding parts with

reference numbers shown elsewhere in the illustrations.

CAUTION: Reference numbers should not be used when ordering parts. Always use IH part numbers or description when ordering.

(4) Parts List. The parts lists following the individual machine index to units, are divided into groups or units and consists of -

- (2) Description of units by name and/or number.
- (b) Exploded views of units.
- (c) List of individual service parts and assemblies keyed to the exploded views for easy identification.
- (d) Description of service parts, with information as needed to cover years used supersedece, optional notations, serial numbers (if any) etc.
- (e) Quantity, where necessary, of each individual part used in the unit, where no quantity is indicated it should be understood to mean that only (1) is used

In some instances, "Key to Units" references are used following the description of items to explain peculiarities. The references (Unit A) correspond with the legend at the beginning of the parts list.

When complete units or individual parts of a unit are "closed-off" and/or replaced by new parts, the "Years Used" information which is peculiar to the production dates of the equipment is shown as part of the unit heading for complete units, or following the description for individual parts of a unit. For example: a part which shows "58- " will work on equipment built 1958 and since. A part which shows "1958" will work only on equipment built in that year. A part which shows "57-58" will work only on equipment built 1957 and 1958, both years inclusive.

Assemblies are shown in the unit lists together with their component parts wherever these assemblies cannot adequately be identified with a reference number in the illustration. In some cases the individual parts of an assembly are not available for service because disassembly of the components is considered impractical. Such parts are marked with the symbol "§".

Whenever the terms "right" or "left" and "front" or "rear" are used, it should be understood to mean from a position behind and facing the equipment.

Pneumatic tires and tubes shown in this catalog are not supplied as service parts. These items should be purchased locally.

(5) Parts Numbers. The policy governing part numbers is outlined in the pamphlet "What is a Parts Number?" which has been distributed throughout the company operations.

(6) Miscellaneous Parts. In a great many instances parts which appear in an "Exploded View", such as standard bolts, screws, nuts, etc., are not identified by a reference number. These parts are known as COMMON HARDWARE items and appear in abbreviated nomenclature and are shown indented under the major items with which they are used. They should be ordered separately as they are not component parts of the pieces they attach.

The following rules are established to govern the listing of attaching parts:

The part numbers of commonly available hardware items are omitted. Other common hardware items are shown with part numbers to facilitate identification. Design hardware items will continue to be listed by part number and description. WARNING: Do not substitute standard hardware parts for them.

Standard bolts used in International Harvester Products are manufactured under standards known as Unified National Coarse Thread (U. N. C.) and Unified National Fine Thread (U. N. F.) with the number of threads per inch for diameters as shown below:

Diameter of Bolt	No. of Threads per inch (U. N. C.)	No. of Threads per inch (U. N. F.)
1/4"	20	28
5/16"	18	24
3/8"	16	24
7/16"	14	20
1/2"	13	20
9/16"	12	18
5/8"	11	18
3/4"	10	16
7/8"	9	14
1"	8	14
1-1/8"	7	12
1-1/4"	7	12
1-3/8"	6	12
1-1/2"	6	12

All Carriage, Machine and Plow BOLTS, NUTS, and cap, machine and set SCREWS will be considered furnished with National Coarse Thread unless otherwise specified. Machine BOLTS and cap SCREWS will be considered "hex-hd", unless otherwise specified. The number of threads per inch will be eliminated

All NUTS will be considered "hex." unless otherwise specified.

All WASHERS will be considered "Plain" unless otherwise specified. The "ID", "OD" and "No." identity will be eliminated. The inside dimension will be listed first, followed by the outside diameter and the thickness.

All lock WASHERS will be considered "Medium" type unless specified as "Light" or "Heavy".

All Cotter PINS will be considered "Extended-Prong" unless otherwise specified.

All groov PINS will be considered "Standard-Groove" unless otherwise specified.

All common RIVETS will be considered "Annealed" unless otherwise specified:

All countersunk-head tubular RIVETS will be considered "Copper-Plated Steel" unless otherwise specified.

All oval-head tubular RIVETS will be considered "Brass".

(7) Abbreviations. The abbreviations used in this catalog are explained in the list of abbreviations on page 4.

(8) Serial Numbers and Letters. The engine serial number is stamped on a plate on the left side of the engine.

The chassis (or tractor) serial number for these tractors, which starts with No. 501, is stamped on the right side of the reduction gear housing.

The chassis serial numbers for these tractors run consecutively regardless of the tractor model, however, no attempt is made to have the engine and chassis serial numbers correspond.

Customers should be urged to supply the chassis serial numbers, when ordering parts.

LIST OF ABBREVIATIONS

A period after the abbreviation is used only when the abbreviation form spells a common English word.

al	aluminum	in.	inch or inches
aly-stl	alloy steel	lb	pound, pounds
amp	ampere, amperes	lentil-hd	lentil head
anl	annealed	LH	left hand
approx	approximately	lkg	locking
assy	assembly	mach	machine
att	attachment	MI	malleable iron
bd-hd	binding head	NC	National Coarse Thread
b-hd	button head	NF	National Fine Thread
brs	brass	ni	nickel
brz	bronze	ni-pltd-stl	nickel plated steel
cd-pltd	cadmium plated	No.	number
cd-pltd-stl	cadmium plated steel	NPT	National pipe thread
cr-pltd	chromium plated	OC	outside circumference
cr-pltd-stl	chromium plated steel	OD	outside diameter
CI	cast iron	ov-hd	oval head
csk	countersunk	oz	ounce
csk-hd	countersunk head	parkerized-stl	parkerized steel
cl-rec-hd	clutch recess head	pkg	package
cone-pt	cone point	pltd	plated
contd	continued	pt	point
cop	copper	PTO	power take-off
cop-pltd	copper plated	rd-end	round end
c-pin	cotter pin	rd-hd	round head
cres	corrosion-resistant-steel (stainless)	rd-pt	round point
cr-rec-hd	cross recess head	reg	regular
cre	corrosion resisting	RH	right hand
crg	carriage	RPM	revolutions per minute
cup-pt	cup point	SAE	Society of Automotive Engineers
cyl	cylinder, cylinders	sf	semi-finished
dia	diameter	slt-hd	slotted head
dld	drilled	slt-bd-hd	slotted binding head
dld-f/c-pin	drilled for cotter pin	slt-fil-hd	slotted fillister head
dld-f/lkg-wire	drilled for locking wire	slt-f-hd	slotted flat head
dog-pt	dog point	slt-hex-hd	slotted hexagon head
f/	for	slt-pan-hd	slotted pan head
fil-hd	fillister head	slt-rd-hd	slotted round head
fin-nk	fin neck	sq	square
f-csk-hd	flat countersunk head	sq-hd	square head
f-fil-hd	flat fillister head	sq-nk	square neck
f-hd	flat head	std	standard
f-pt	flat-point	std-hd	standard head
flex	flexible	stl	steel
ft	foot (or feet)	T	teeth
ga	gauge	thd	thread
hd	head	unfin	unfinished
hdls	headless	wagon-box-hd	wagon box head
hex.	hexagon	w/	with
hex-hd	hexagonal-head	w/brz	with bronze
hex-soc-hd	hexagon socket head	w/hex.	with hexagon
hp	horsepower	w/o	without
hv	heavy	zn	zinc
ID	inside diameter	zn-ct	zinc coated
		zn-pltd	zinc plated



A-62740

International Cub Cadet Tractor equipped with Retractable Starter (Left front view)



A-62741

International Cub Cadet Tractor equipped with Electric Starter (Right front view)

INDEX TO UNITS

DESCRIPTION	Page	DESCRIPTION	Page
AXLE, FRONT		ENGINE—Continued	
AXLE, Front.....	25	STARTER	
KNUCKLES, Steering.....	25	Electric.....	11
AXLE, REAR		Retractable.....	11
AXLE, Rear.....	26	TANK AND FITTINGS, Fuel.....	12
BRAKES		THROTTLE.....	11
BRAKES AND CONNECTIONS.....	28	VALVES.....	10
CLUTCH		ENGINE CONTROLS AND INSTRUMENT PANEL	
CONTROLS AND CONNECTIONS, Clutch.....	18	CONTROLS, Engine.....	33
DRAWBAR AND HITCHES		PANEL, Instrument.....	33
DRAWBAR, Fixed.....	29	FRAME, REAR AND DRIVING MECHANISM	
HANDLE AND CONNECTIONS, Implement.....	29	CASE, Transmission.....	20
HITCH, Three-Point.....	29	DIFFERENTIAL.....	20
ELECTRICAL SYSTEM		HOUSING, Reduction.....	20
HOLDER, Battery.....	15	SHIFT MECHANISM, Gear.....	23
IGNITION AND STARTING.....	16	TRANSMISSION.....	22
MOTOR—GENERATOR (Delco-Remy).....	14	MISCELLANEOUS EQUIPMENT	
REGULATOR, Voltage (Delco-Remy).....	15	DECALCOMANIAS.....	34
ENGINE		SEAT AND SUPPORTS	
AIR INTAKE.....	10	SEAT.....	30
BAFFLES AND SHROUD.....	10	SUPPORT.....	30
BREATHER AND VENT.....	10	SHEET METAL AND GRILLE	
CAMSHAFT.....	10	FENDERS.....	32
CARBURETOR.....	10	FRAME.....	31
CHOKE CLIP.....	11	GRILLE.....	31
CRANKCASE.....	11	HOOD.....	31
CRANKSHAFT.....	11	PLATFORMS.....	32
DIPSTICK.....	11	SUPPORTS, Foot.....	31
EXHAUST.....	12	STEERING MECHANISM	
FLYWHEEL.....	12	CONNECTIONS, Steering Gear.....	24
GASKET SET.....	13	GEAR, Steering.....	24
GOVERNOR.....	12	LINK, Steering Gear Drag.....	24
HEAD, Cylinder.....	11	WHEELS	
IGNITION.....	12	WEIGHTS, Rear Wheel.....	27
NAME PLATE.....	13	WHEELS	
PAN, Oil.....	13	Front.....	27
PISTON.....	13	Rear.....	27
ROD.....	13		

SERVICE ENGINES

- 28 498 E ENGINE ASSEMBLY (KOHLER K-161-T)
(Equipped with Retractable Starter)
 $\frac{3}{8}$ x $1\frac{1}{8}$ " cd-pltd hex-hd cap SCREW (4)
 $\frac{3}{8}$ " cd-pltd lock WASHER (4)
- 28 542 E ENGINE ASSEMBLY (KOHLER K-161-S)
(Equipped with Electric Starter)
 $\frac{3}{8}$ x $1\frac{1}{8}$ " cd-pltd hex-hd cap SCREW (4)
 $\frac{3}{8}$ " cd-pltd lock WASHER (4)

ENGINE

ENGINE ASSEMBLY

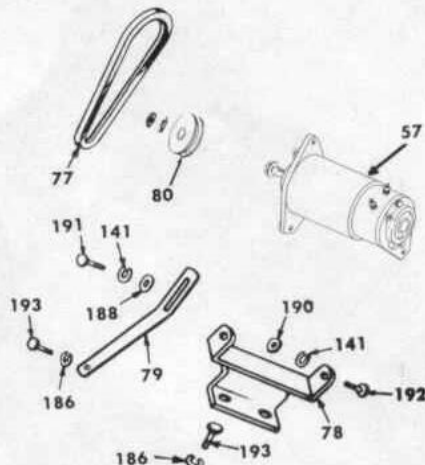
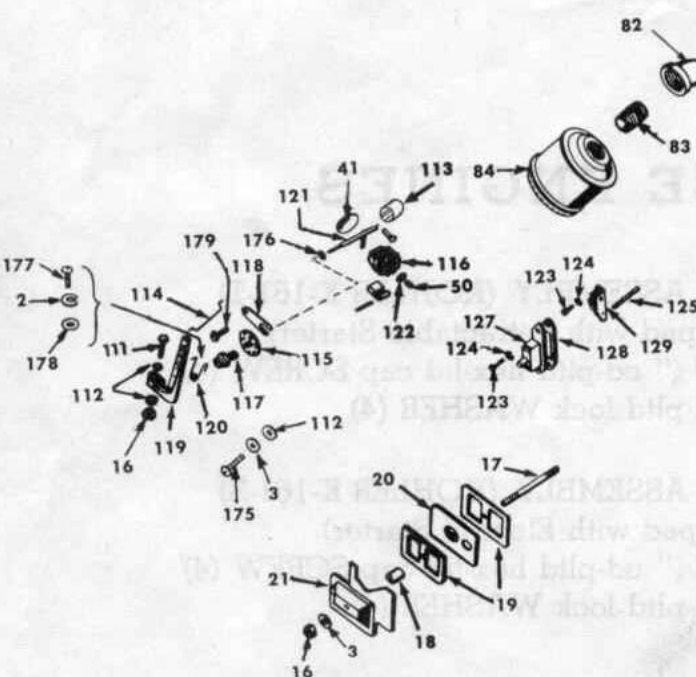
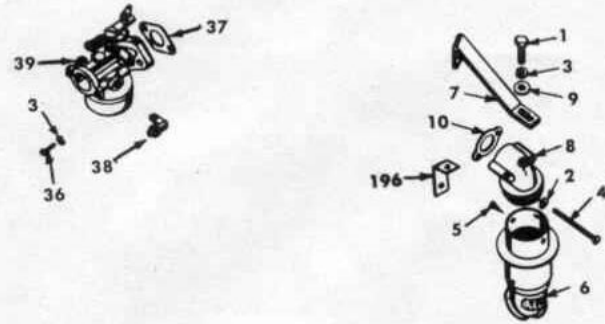

ENGINE

ENGINE ASSEMBLY - CONTINUED

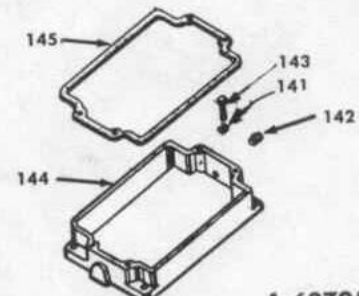
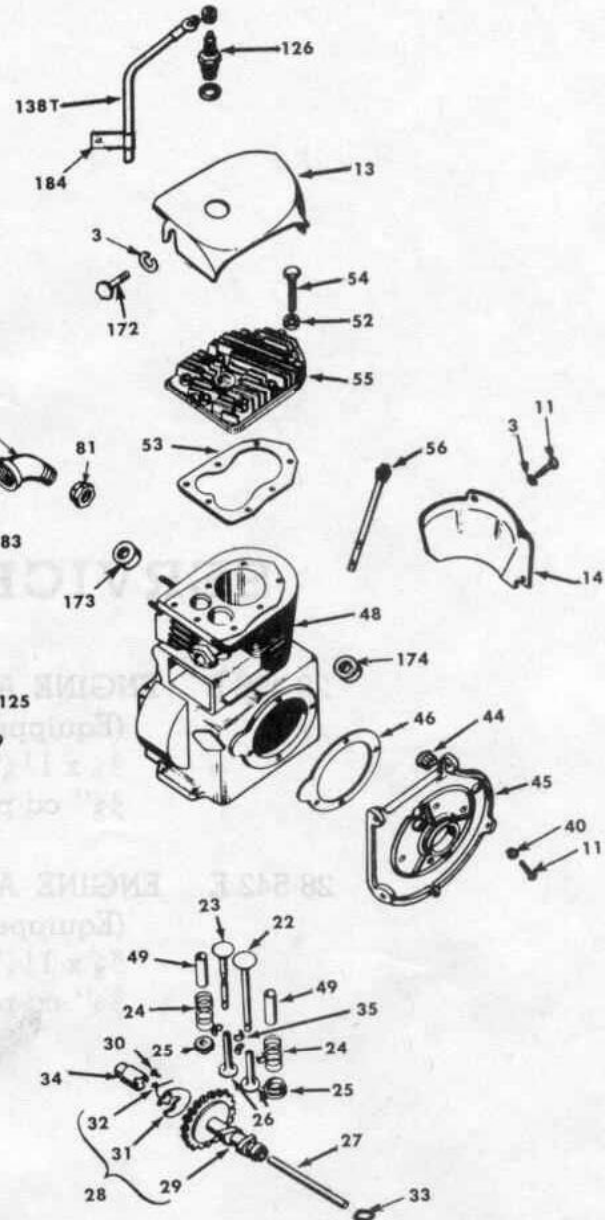

A-62795

ENGINE

ENGINE ASSEMBLY - CONTINUED

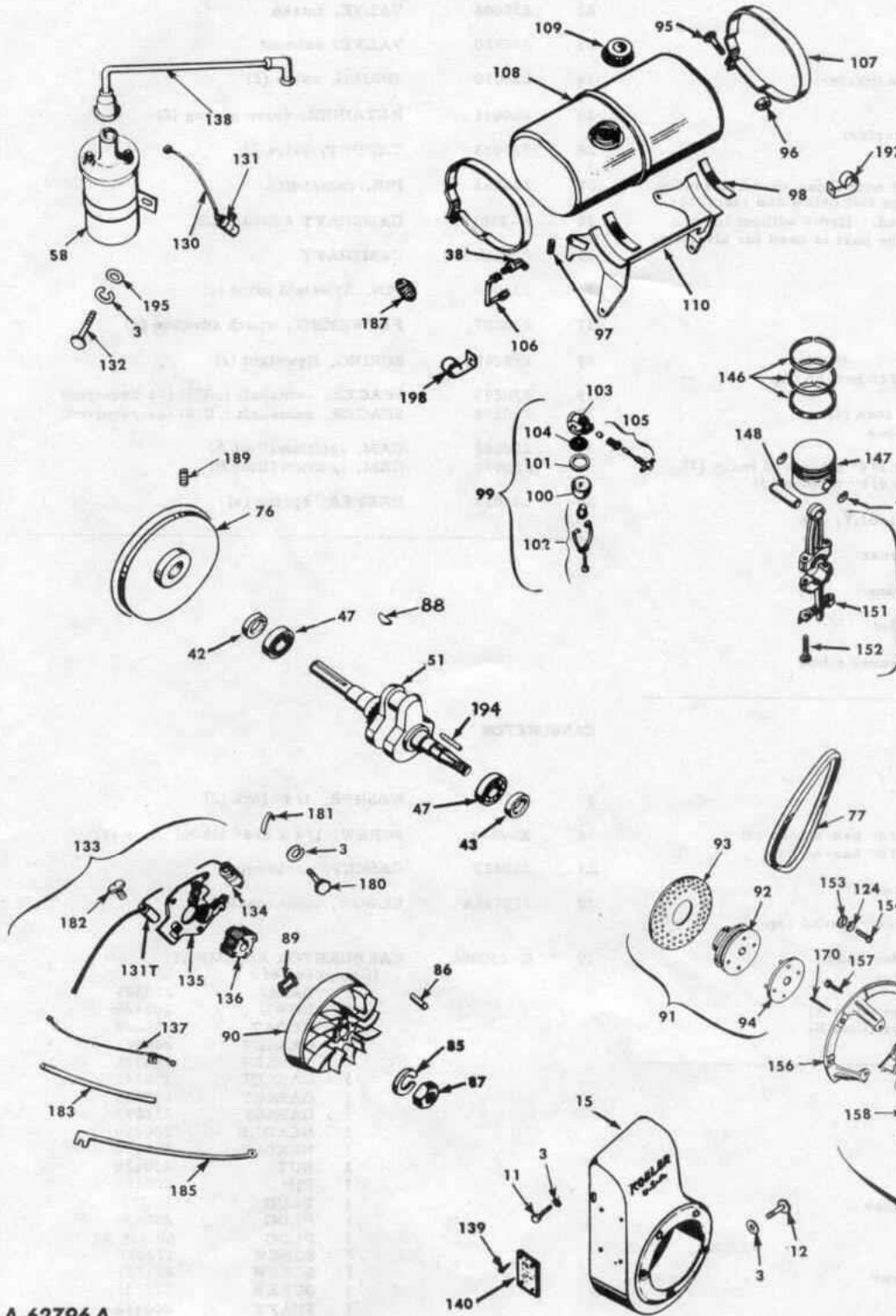

A-62796 A

ENGINE

ENGINE ASSEMBLY - CONTINUED

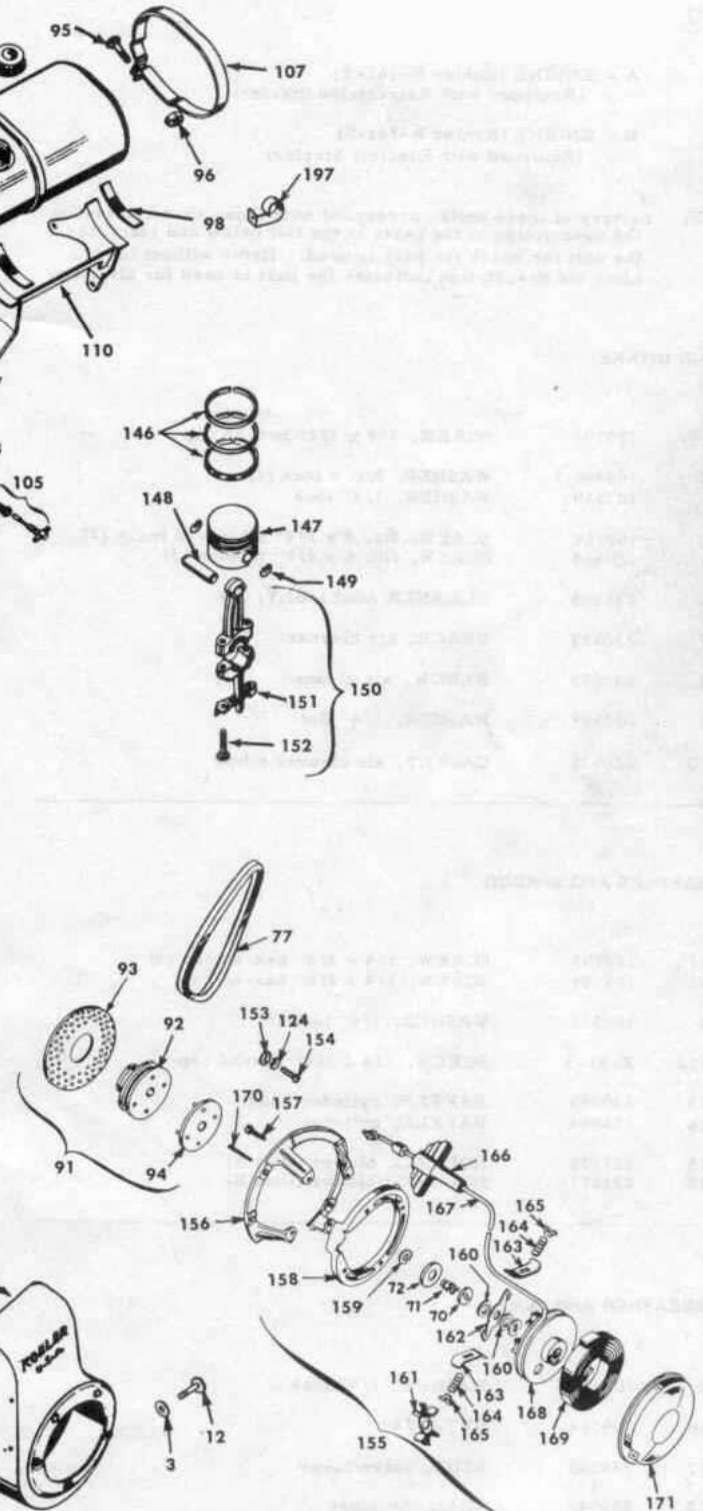

ENGINE



REF. NO.	PART NUMBER	DESCRIPTION
----------	-------------	-------------

ENGINE ASSEMBLY

(X) - KEY TO UNITS

- A - ENGINE (Kohler K-161-T)
(Equipped with Retractable Starter)
- B - ENGINE (Kohler K-161-S)
(Equipped with Electric Starter)

(X) - Letters of these units correspond with those shown following the description of the parts in the list below and identifies the unit for which the part is used. Items without letters after the description indicates the part is used for all units.

AIR INTAKE

1	179791	SCREW, 1/4 x 1/2" hex-hd cap
2	106496	WASHER, No. 8 lock (2)
3	103319	WASHER, 1/4" lock
4	100760	SCREW, No. 8 x 3/4" slt-rd-hd mach (2)
5	120454	SCREW, No. 6 x 3/8" tapping (3)
6	231305	CLEANER ASSEMBLY, air
7	230539	BRACE, air cleaner
8	230553	ELBOW, air cleaner
9	103339	WASHER, 1/4" flat
10	220537	GASKET, air cleaner elbow

BAFFLES AND SHROUD

11	179795	SCREW, 1/4 x 3/4" hex-hd cap (4)
12	179789	SCREW, 1/4 x 3/8" hex-hd cap
3	103319	WASHER, 1/4" lock (6)
172	X-98-3	SCREW, 1/4 x 3/4" hex-hd cap
13	230049	BAFFLE, cylinder head
14	230054	BAFFLE, cylinder
15	231275	HOUSING, blower (Unit A)
15	231277	HOUSING, blower (Unit B)

BREATHER AND VENT

3	103319	WASHER, 1/4" lock
16	109084	NUT, 1/4"
17	230043	STUD, valve cover
18	230046	SEAL, breather
19	230048	GASKET, valve cover (2)
20	A-230066	BREATHER ASSEMBLY
21	A-230774	COVER, valve

ENGINE



REF. NO.	PART NUMBER	DESCRIPTION
----------	-------------	-------------

CAMSHAFT AND VALVES

22	230008	VALVE, intake
23	230710	VALVE, exhaust
24	230010	SPRING, valve (2)
25	230011	RETAINER, valve spring (2)
26	230013	TAPPET, valve (2)
27	230053	PIN, camshaft
28	A-230155	CAMSHAFT ASSEMBLY
29	230016	CAMSHAFT
30	230080	PIN, flyweight pivot (2)
31	230087	FLYWEIGHT, spark advance (2)
32	275267	SPRING, flyweight (2)
33	230293	SPACER, camshaft (.005) (as required)
33	230294	SPACER, camshaft (.010) (as required)
34	230188	CAM, ignition (Unit A)
34	230690	CAM, ignition (Unit B)
35	240013	KEEPER, spring (4)

CARBURETOR

3	103319	WASHER, 1/4" lock (2)	
36	X-98-3	SCREW, 1/4 x 3/4" slt-hd mach (2)	
37	210223	GASKET, carburetor	
38	220146A	ELBOW, compression	
39	C-230500	CARBURETOR ASSEMBLY (Composed of -	
	1	BALL	200385
	1	BOWL	200435
	1	FLOAT	200408
	1	GASKET	200371
	1	GASKET	200372
	1	GASKET	200375
	1	GASKET	200423
	1	GASKET	231293
	1	NEEDLE	200410
	1	NEEDLE	200431
	1	NUT	200420
	1	PIN	200426
	1	PLUG	D-271
	1	PLUG	200434
	1	PLUG	68 457 R1
	1	SCREW	173260
	4	SCREW	421721
	1	SCREW	275231
	1	SHAFT	200412
	1	SHAFT	200419
	1	SPRING	200381
	1	SPRING	200382
	1	SPRING	200383
	1	VALVE	200361
	1	VALVE	200417)

ENGINE



REF. NO.	PART NUMBER	DESCRIPTION
CRANKCASE		
11	179795	SCREW, 1/4 x 3/4" hex-hd cap (4)
40	103339	WASHER, 1/4" flat (4)
41	X-230-11	PLUG, expansion
42	X-271-12	OIL SEAL, crankshaft rear
43	X-271-17	OIL SEAL, crankshaft front
44	432482	BUTTON, plug
45	230062	PLATE, bearing
46	230071	GASKET, bearing plate
47	ST 685	BALL BEARING, crankshaft (2)
48	A-231266	CRANKCASE ASSEMBLY (Composed of - 2 GUIDE 230007 1 INSERT 230110 1 INSERT 230265 1 SHAFT 230125-S)
49	230007	GUIDE, valve (2)
50	230125-S	SHAFT, governor
173	230110	INSERT, exhaust valve seat
174	230265	INSERT, exhaust valve seat

CRANKSHAFT

51	230395	CRANKSHAFT
----	--------	------------

CYLINDER HEAD

52	220534	WASHER, 5/16" flat (7)
53	230024	GASKET, cylinder head
54	230175	SCREW, 5/16 x 1-1/2" hex-hd cap (6)
54	230992	SCREW, 5/16 x 1-5/8" hex-hd cap
55	230402	HEAD, cylinder

DIPSTICK

56	A-231271	DIPSTICK ASSEMBLY
----	----------	-------------------

**RETRACTABLE STARTER
(For Unit A)**

124	106497	WASHER, No. 10 lock (5)
153	446160	WASHER, No. 10 flat (5)
154	110500	SCREW, No. 10 x 1/2" slt-rd-hd mach (5)
77	376 230 R1	BELT, drive (Kohler 231265)
155	A-231268	STARTER ASSEMBLY, recoil

ENGINE



REF. NO.	PART NUMBER	DESCRIPTION
RETRACTABLE STARTER - CONTINUED (For Unit A)		
156	231299	FLANGE, starter mounting
157	110489	SCREW, mach (4)
158	230789	FLANGE, middle
159	230790	RING, retainer
72	230791	WASHER, break retainer
71	220613	SPRING, break
70	220614	WASHER, break (2)
160	220615	WASHER, fiber (2)
161	A-220616	SHOE ASSEMBLY, friction (2)
162	220617	LEVER, brake
163	220618	PLATE, friction shoe (2)
164	220619	SPRING, friction shoe (2)
165	220620	PLATE, spring retainer (2)
166	220621	HANDLE, starter
167	230792	CORD, starter
168	230793	ROTOR, starter
169	230794	SPRING, rewind
170	230795	PIN, centering
171	230796	COVER, starter

THROTTLE AND CHOKE CLIP

196	231286	BRACKET, choke cable (Unit B)
197	231284	CLIP, cable harness (Unit B)
198	231285	CLIP, cable

**ELECTRIC STARTER
(For Unit B)**

141	103320	WASHER, 5/16" lock (3)
186	103321	WASHER, 3/8" lock (3)
188	103340	WASHER, 5/16" flat
189	102581	SCREW, 5/16 x 3/8" set (2)
190	102634	NUT, 5/16" (2)
191	179816	SCREW, 5/16 x 3/4" hex-hd cap
192	179819	SCREW, 5/16 x 1-1/8" hex-hd cap (2)
193	179838	SCREW, 3/8 x 7/8" hex-hd cap (3)
194	117222	KEY, square
57	1101951	MOTOR-GENERATOR (Kohler A-231262) (For components see list of parts under details of "MOTOR-GENERATOR")
76	231263	PULLEY, drive
77	376 230 R1	BELT, starter (Kohler 231265)
78	231272	BRACKET, mounting
79	231273	BRACE, adjusting
80	231278	PULLEY, driven

ENGINE

REF. NO.	PART NUMBER	DESCRIPTION
EXHAUST		
81	138 909 R1	NUT, lock
82	230600	ELBOW, street
83	127874	NIPPLE, elbow to muffler
84	230410	MUFFLER, exhaust
FLYWHEEL		
85	103325	WASHER, 5/8" lock
86	X-56-7	PIN, 1/4 x 3/4"
87	103030	NUT, 5/8"
88	X-286-10	KEY, 3/16"
89	230148	WASHER, tension
90	231276	FLYWHEEL
91	A-231269	PULLEY w/SCREEN ASSEMBLY, drive
92	231300	PULLEY
93	231301	SCREEN, pulley
94	231302	RING, pulley plate
FUEL TANK AND FITTINGS		
95	179799	SCREW, 1/4 x 1-1/4" hex-hd cap (2)
96	18 306 R1	NUT, 1/4" elastic stop (2)
97	X-217-6	NIPPLE
98	X-295-2	WEBBING (2)
99	210101A	FILTER ASSEMBLY, fuel
100	210467	BOWL, fuel filter
101	210468	GASKET, fuel filter bowl
102	A-210477	BAIL ASSEMBLY, filter
103	210478	BODY, filter
104	210479	SCREEN, filter
105	A-210480	VALVE ASSEMBLY, fuel filter needle
38	220146A	ELBOW, compression
106	231292	LINE, fuel
107	230160	STRAP, fuel tank (2)
108	230164	TANK, fuel
109	220068	CAP, fuel tank
110	A-230752	BRACKET, fuel tank

ENGINE

REF. NO.	PART NUMBER	DESCRIPTION
GOVERNOR		
111	179797	SCREW, 1/4 x 1" hex-hd cap
2	103496	WASHER, No. 8 lock
3	103319	WASHER, 1/4" lock
178	446160	WASHER, No. 10 flat
112	103339	WASHER, 1/4" flat (3)
176	103339	WASHER, 1/4" flat
177	100750	SCREW, No. 8 x 3/8" slt-rd-hd mach
175	114354	SCREW, 1/4 x 5/8" slt-fil-hd mach
179	145366	SCREW, No. 2 x 3/16" drive
16	109084	NUT, 1/4"
113	X-293-4	BEARING, governor cross shaft needle
114	230078	LINKAGE, governor
115	230149	DISC, regulating
116	A-235157	GEAR, governor
117	230476	BUSHING, governor
118	230477	BRACKET, speed control
119	230494	LEVER, governor
120	230496	SPRING, governor
121	A-230540	SHAFT ASSEMBLY, governor cross
122	230601	SPACER
IGNITION		
180	179793	SCREW, 1/4 x 5/8" hex-hd cap (2 for Unit A)
132	179789	SCREW, 1/4 x 3/8" hex-hd cap (Unit B)
123	110486	SCREW, No. 10 x 3/8" slt-fil-hd mach (4)
124	106497	WASHER, No. 10 lock (4)
3	103319	WASHER, 1/4" lock (2)
195	103339	WASHER, 1/4" flat (2 for Unit B)
125	X-389-2	ROD, breaker
126	220040-S	SPARK PLUG w/GASKET (Champion J-8)
127	A-220136	COVER ASSEMBLY, breaker
128	220174	GASKET, breaker cover
129	A-220474	BREAKER ASSEMBLY (Composed of -
	1	BRACKET 220476
	1	POINT 220475
	1	SCREW 122159
	1	WASHER 106496
	1	WASHER 103339
130	A-230113	LEAD, breaker (Unit A)
130	A-230371	LEAD, breaker (Unit B)
131	230722	CONDENSER (Unit B)
138	A-230723	CABLE, spark plug (Unit B)
58	231281	COIL, ignition (Unit B)
133	C-230089	MAGNETO ASSEMBLY (Unit A)

ENGINE



REF. NO.	PART NUMBER	DESCRIPTION
IGNITION - CONTINUED		
182	131954	SCREW, No. 8 x 1/4" slit-fil-hd mach (3 for Unit A)
181	210293	CLAMP, coil (2 for Unit A)
131T	220082	CONDENSER (Unit A)
134	230075	COIL, magneto (Unit A)
135	230076	STATOR (Unit A)
136	230360	MAGNET, rotating (Unit A)
137	230249	CLIP, cable (Unit A)
183	230334	SLEEVE, cable (Unit A)
138T	A-230782	CABLE, spark plug (Unit A)
184	275183	CLIP, spark plug cable (Unit A)
185	A-231291	LEAD, ground (Unit A)

NAME PLATE

139	145376	SCREW, No. 7 sheet metal (4)
140	231303	NAME PLATE (Unit A)
140	231270	NAME PLATE (Unit B)
187	230858	DECAL, 7 H.P. (2)

OIL PAN

141	103320	WASHER, 5/16" lock (4)
142	103868	PLUG, 1/2" pipe
143	175818	SCREW, 5/16 x 1" hex-hd cap (4)
144	230021	PAN, oil
145	230057	GASKET, oil pan

PISTON AND ROD

146	230467	RING SET (standard)
146	230468	RING SET (.010" oversize)
146	230469	RING SET (.020" oversize)
146	230470	RING SET (.030" oversize)
147	A-230103	PISTON w/PIN and TWO RETAINERS ASSEMBLY (standard)
147	A-230105	PISTON w/PIN and TWO RETAINERS ASSEMBLY (.010" oversize)
147	A-230107	PISTON w/PIN and TWO RETAINERS ASSEMBLY (.020" oversize)
147	A-230109	PISTON w/PIN and TWO RETAINERS ASSEMBLY (.030" oversize)
148	230003	PIN, piston (standard)
148	230033	PIN, piston (.005" oversize)
148	230034	PIN, piston (.010" oversize)

ENGINE



REF. NO.	PART NUMBER	DESCRIPTION
PISTON AND ROD - CONTINUED		
149	230004	RETAINER, piston pin (2)
150	B-230039	ROD ASSEMBLY, connecting (standard)
150	B-230039-10	ROD ASSEMBLY, connecting (.010" undersize)
151	230525	LOCK, connecting rod screw
152	230526	SCREW, connecting rod (2)
GASKET SET		
	230165	GASKET SET, engine

ELECTRICAL SYSTEM



REF. NO.	PART NUMBER	DESCRIPTION
----------	-------------	-------------

MOTOR-GENERATOR
(Delco-Remy)

ELECTRICAL SYSTEM



REF. NO.	PART NUMBER	DESCRIPTION
----------	-------------	-------------

MOTOR-GENERATOR - CONTINUED
(Delco-Remy)

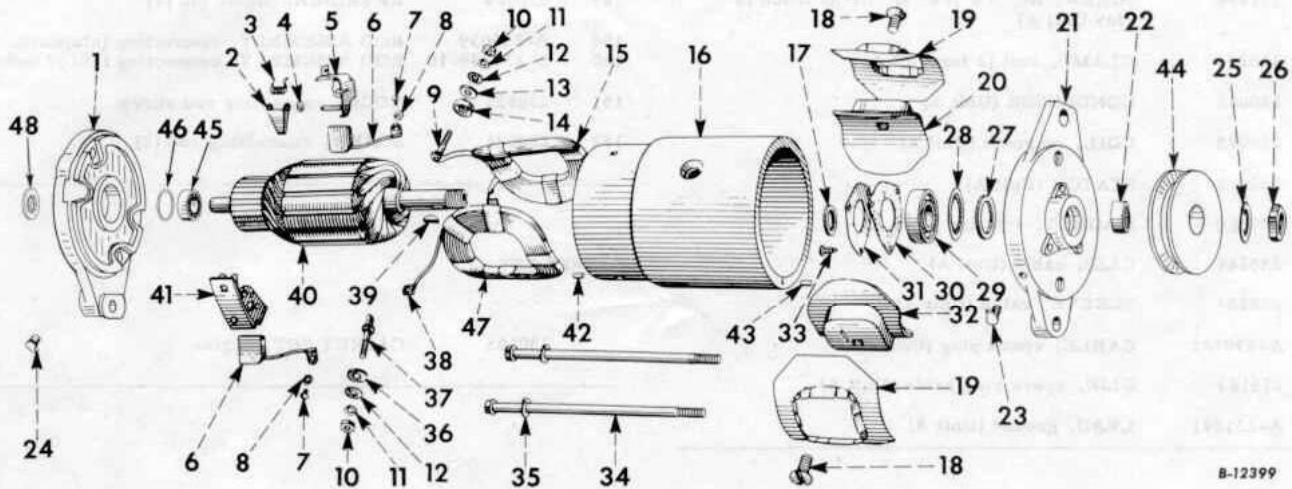

B-12399

	1101951	GENERATOR ASSEMBLY (Kohler A-231262) (12 Volt)
1	1939907	FRAME ASSEMBLY, commutator end (Composed of - 1 CLAMP 1929959 1 DOWEL 809062 § 1 FRAME 1 OILER 125609 1 PLUG 1948326)
2	1878183	ARM, brush (2)
3	1908829	SPRING, brush (2)
4	1857412	WASHER, brush arm space
5	1940421	HOLDER, brush ground
6	1906973	BRUSH (2)
7	132688	SCREW, No. 6 x 1/4" cd-pltd slt-rd-hd mach
7	141541	SCREW, No. 6 x 5/16" blued, slt-rd-hd mach
8	1904377	WASHER, brush lead attaching screw lock (2)
9	1939891	STUD, terminal field
10	121743	NUT, No. 12 cd-pltd (4)
11	1904661	WASHER, field terminal stud lock (4)
12	1881409	WASHER, terminal stud (2)
13	1858753	WASHER, terminal stud insulating
14	1885090	BUSHING, field terminal insulating
14	1939894	BUSHING, field terminal insulating (inside)
15	1955271	COIL, field LH
16		FRAME (Not Serviced Separately)
17	809945	WASHER, drive end space
18	1843646	SCREW, pole shoe (2)
19	1912073	INSULATOR, field coil (2)
20	1911961	SHOE, pole
21	1855960	FRAME w/OILER, PIN ASSEMBLY, drive end
22	1858603	COLLAR, drive end space

23	1880635	OILER, drive end
24	125609	OILER ASSEMBLY, commutator end
25	1888439	WASHER, drive end shaft nut lock
26	1911324	NUT, drive end shaft
27	809961	WASHER, drive end felt
28	819104	PLATE, drive end felt retainer
29	954378	BALL BEARING, drive end
30	1912008	GASKET, drive end retainer plate
31	1911263	PLATE, drive end retainer
32	1939902	SHOE, pole (with notch)
33	1904370	SCREW, drive end retainer plate (3)
34	809763	BOLT, thru (2)
35	120638	WASHER, thru bolt lock (2)
36	1921362	BUSHING, armature terminal insulating
37	1923056	STUD, terminal armature
38	200346	CLIP, terminal to brush
39	124545	KEY, No. 5 Woodruff Aly-stl
40	1945778	ARMATURE
41	1940422	HOLDER, brush insulated
42	809062	PIN, commutator end dowel
43	809593	PIN, drive end dowel
44		PULLEY, motor generator (Kohler 231278)
45	907055	BALL BEARING, commutator end
46	1929959	CLAMP, commutator end bearing
47	1955270	COIL, field - RH (shunt)
48	1948326	PLUG, commutator end bearing well



ELECTRICAL SYSTEM

REF. NO. PART NUMBER DESCRIPTION

VOLTAGE REGULATOR (Delco-Remy) (For Tractors equipped with Electric Starter)

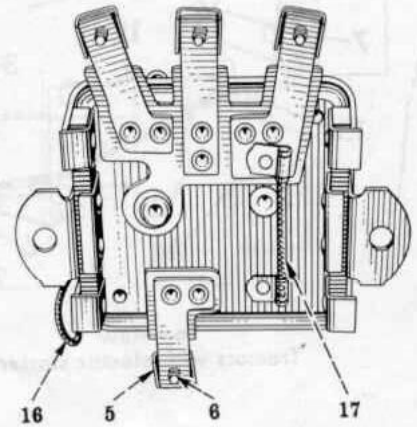
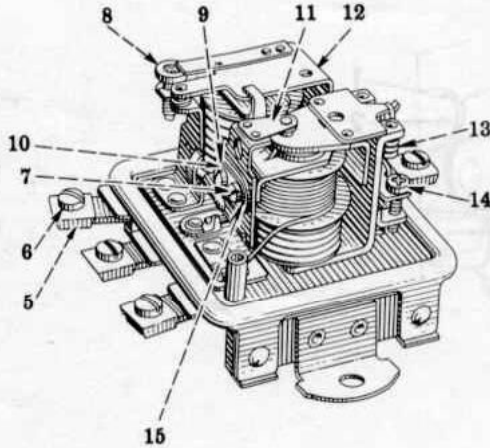
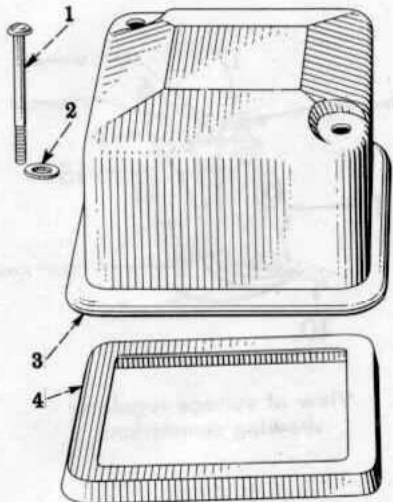

A-33775

1118999	REGULATOR ASSEMBLY, voltage (376 122 R91) (12 volt)
1	1927982 SCREW, cover attaching (2)
2	1935031 WASHER, insulating cover attaching screw (2)
3	1927980 COVER
4	1953902 GASKET, cover
5	1868137 CLAMP, terminal (4)
6	1864099 SCREW, terminal (4)
7	1878516 SCREW, regulator contact attaching (2)
8	1912159 SCREW, adjusting relay armature
9	1878507 WASHER, insulating regulator contact attaching screw (2)
10	1878505 WASHER, regulator contact attaching screw lock (2)
11	1878493 CONTACT and SUPPORT, regulator
12	1939646 ARMATURE, relay 1924764 relay armature SCREW w/WASHER ASSEMBLY (2)
13	1912176 SPRING, regulator armature
14	1944590 SCREW, regulator armature adjusting
15	1922599 INSULATOR, regulator contact attaching screw
16	1927975 LEAD ASSEMBLY, ground
17	1910174 RESISTER, "F" terminal to ground



ELECTRICAL SYSTEM

REF. NO. PART NUMBER DESCRIPTION

VOLTAGE REGULATOR - CONTINUED (Delco-Remy) (For Tractors equipped with Electric Starter)

BATTERY HOLDER

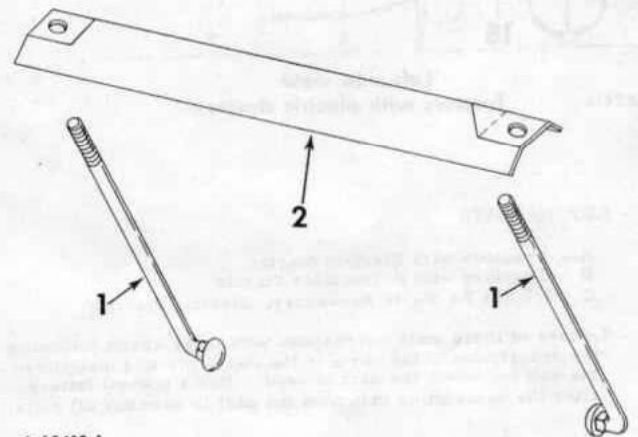

A-62618 A

1	376 294 R2 BOLT, battery hold down clamp (2) 376 137 R1 1/4" type-A-wing NUT (2)
2	376 293 R2 CLAMP, battery hold down

ELECTRICAL SYSTEM

REF. NO.	PART NUMBER	DESCRIPTION
----------	-------------	-------------

IGNITION AND STARTING

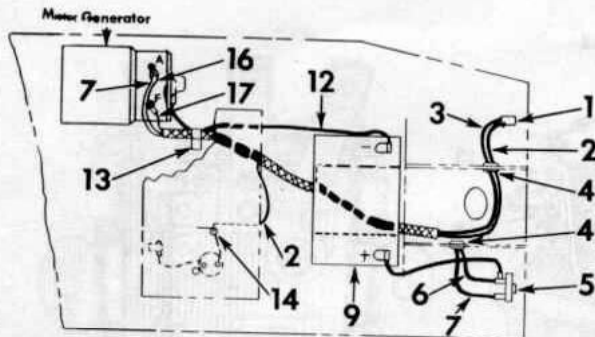

Top view
Tractors with electric starter

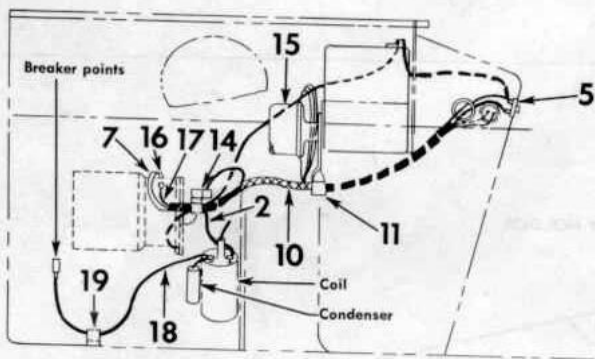

Left side view
Tractors with electric starter

A-62416

ELECTRICAL SYSTEM

REF. NO.	PART NUMBER	DESCRIPTION
----------	-------------	-------------

IGNITION AND STARTING - CONTINUED

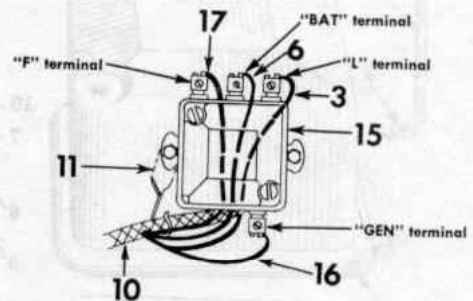

View of voltage regulator
showing connections

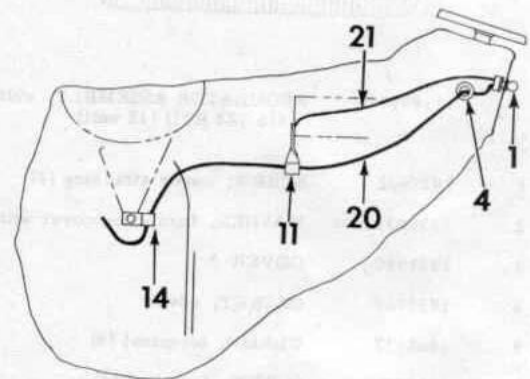

Left side view
Tractors with retractable starter

(X) - KEY TO UNITS

- A - Tractors with Electric Starter
- B - Tractors with Retractable Starter
- C - 377 891 R1 Parts Accessory, Electric Starting

(X) - Letters of these units correspond with those shown following the description of the parts in the list below and identifies the unit for which the part is used. Items without letters after the description indicates the part is used for all units.

1	365 522 R91	SWITCH ASSEMBLY, ignition (Unit A)
	365 502 R1	switch mounting NUT
		No. 6 x 1/4" cd-pltd sltd-rd-hd mach SCREW (2)
	375 431 R1	No. 6 cd-pltd lock WASHER (2)
1	367 168 R91	SWITCH ASSEMBLY, ignition (Unit B)
2		CABLE, ignition coil positive terminal to ignition switch (black) (order HARNESS ASSEMBLY) (Unit A)
3		CABLE, regulator "L" terminal to ignition switch (Light Green) (order HARNESS ASSEMBLY) (Unit A)

4	120 013	GROMMET, cable (2 for Unit A and C) (1 for Unit B)
5	376 295 R91	SWITCH ASSEMBLY, starting (Unit A and C)
		1/4" NUT (2)
		5/16NF cd-pltd jam NUT (2) (For fastening cable to switch)
		1/4 x 3/4" slt-pan-hd mach SCREW (2)
		1/4" lock WASHER (2)
		5/16" cd-pltd lock WASHER (2) (For fastening cable to switch)
	16 559 R1	17/64 x 5/8" x .049 ga. WASHER (2)
6		CABLE, regulator "BAT" terminal to starting switch (gray) (order HARNESS ASSEMBLY) (Unit A)
7		CABLE, generator "A" terminal to starting switch (red) (order HARNESS ASSEMBLY) (Unit A)
8	376 287 R91	CABLE ASSEMBLY, battery to starting switch (Unit A and C)
		5/16" cd-pltd NUT
	16 897 R1	5/16 x 3/4" cd-pltd sq neck crg BOLT
		5/16" cd-pltd lock WASHER

ELECTRICAL SYSTEM

REF. NO.	PART NUMBER	DESCRIPTION
----------	-------------	-------------

IGNITION AND STARTING - CONTINUED

9	376 288 R91	BATTERY (Auto-Lite LU-7) 12 volt (Unit A and C)
10	376 285 R91	HARNESS ASSEMBLY, cable (Unit A and C)
11	363 660 R1	CLIP, cable harness - twister (on RH voltage regulator mounting bolt) 1/4" NUT (Unit B) 1/4 x 1/2" hex-hd cap SCREW (Unit B) 1/4" lock WASHER (Unit B)
	16 558 R1	17/64 x 5/8" x .049 ga WASHER
12	376 286 R91	CABLE ASSEMBLY, battery to ground (Unit A and C) 1/4" cd-pltd NUT 1/4 x 3/4" cd-pltd hex-hd cap SCREW 1/4" cd-pltd lock WASHER
	16 559 R1	17/64 x 5/8" x .049 ga cd-pltd WASHER
13		CLIP, cable harness - angle (on RH lower fuel tank support bolt) (Unit A) (furnished with engine) 17/64 x 5/8" x .049 ga WASHER
14		CLIP, cable (on LH lower fuel tank support bolt) (furnished with engine)
15	376 122 R91	REGULATOR ASSEMBLY, voltage (for components see list of parts under details of VOLTAGE REGULATOR) (Unit A and C) 1/4" cd-pltd NUT (2) 1/4 x 1/2" cd-pltd hex-hd cap SCREW (2) 1/4" cd-pltd lock WASHER (2)
16		CABLE, regulator to "GEN" terminal to generator "A" terminal (light blue) (order HARNESS ASSEMBLY) (Unit A)
17		CABLE, regulator "F" terminal to generator "F" terminal (yellow) (order HARNESS ASSEMBLY) (Unit A)
18		CABLE, ignition coil negative terminal to breaker points (Unit A)
19		CLIP, cable (furnished with engine) (Unit A)
20		CABLE, ignition switch to magneto (Unit B)
21	367 165 R91	CABLE, ignition switch to ground (Unit B)

THE FOLLOWING PARTS WHICH ARE INCLUDED IN THE ELECTRIC STARTING PARTS ACCESSORY (UNIT C) ARE ILLUSTRATED WITH THE ENGINE OR AS INDICATED

376 230 R1	BELT, starter
376 294 R2	BOLT, battery hold down (illustrated with "Battery Holder")
376 137 R1	1/4" type-A-wing NUT (2)
	BRACE, motor-generator adjusting (Kohler 231273) 5/16 x 3/4" cd-pltd hex-hd cap SCREW 3/8 x 7/8" cd-pltd hex-hd cap SCREW 5/16" cd-pltd lock WASHER 3/8" cd-pltd lock WASHER 11/32 x 11/16 x .065 ga cd-pltd WASHER
	BRACKET, motor-generator mounting (Kohler 231272) 3/8 x 7/8" cd-pltd hex-hd cap SCREW (2) 3/8" cd-pltd lock WASHER (2)

ELECTRICAL SYSTEM

REF. NO.	PART NUMBER	DESCRIPTION
----------	-------------	-------------

IGNITION AND STARTING - CONTINUED

		BRACKET, choke cable (Kohler 231286)
	376 293 R2	CLAMP, battery hold down (illustrated with "Battery Holder")
		CLIP, cable harness - angle (Kohler 231284) 17/64 x 5/8" x .049 ga cd-pltd WASHER
	376 298 R1	CLIP, choke cable retainer (illustrated with "Engine Controls and Instrument Panel") No. 8 cd-pltd NUT No. 8 x 3/8" cd-pltd cr-rec-pan-hd mach SCREW No. 8 cd-pltd lock WASHER
	376 299 R91	CONTROL ASSEMBLY, choke (illustrated with "Engine Controls and Instrument Panel")
		KEY, 1/4 x 2.12 parallel (Kohler X-286-12)
	1010951	MOTOR-GENERATOR (Kohler A-231262) 5/16" cd-pltd NUT (2) 5/16 x 1-1/4" cd-pltd hex-hd cap SCREW (2) 5/16" cd-pltd lock WASHER (2)
		PULLEY, drive (Kohler 231263) 5/16 x 3/8" set SCREW (2) (Kohler X-60-41)



CLUTCH



CLUTCH



REF. NO.	PART NUMBER	DESCRIPTION
----------	-------------	-------------

REF. NO.	PART NUMBER	DESCRIPTION
----------	-------------	-------------

CLUTCH CONTROLS AND CONNECTIONS

CLUTCH CONTROLS AND CONNECTIONS - CONTINUED

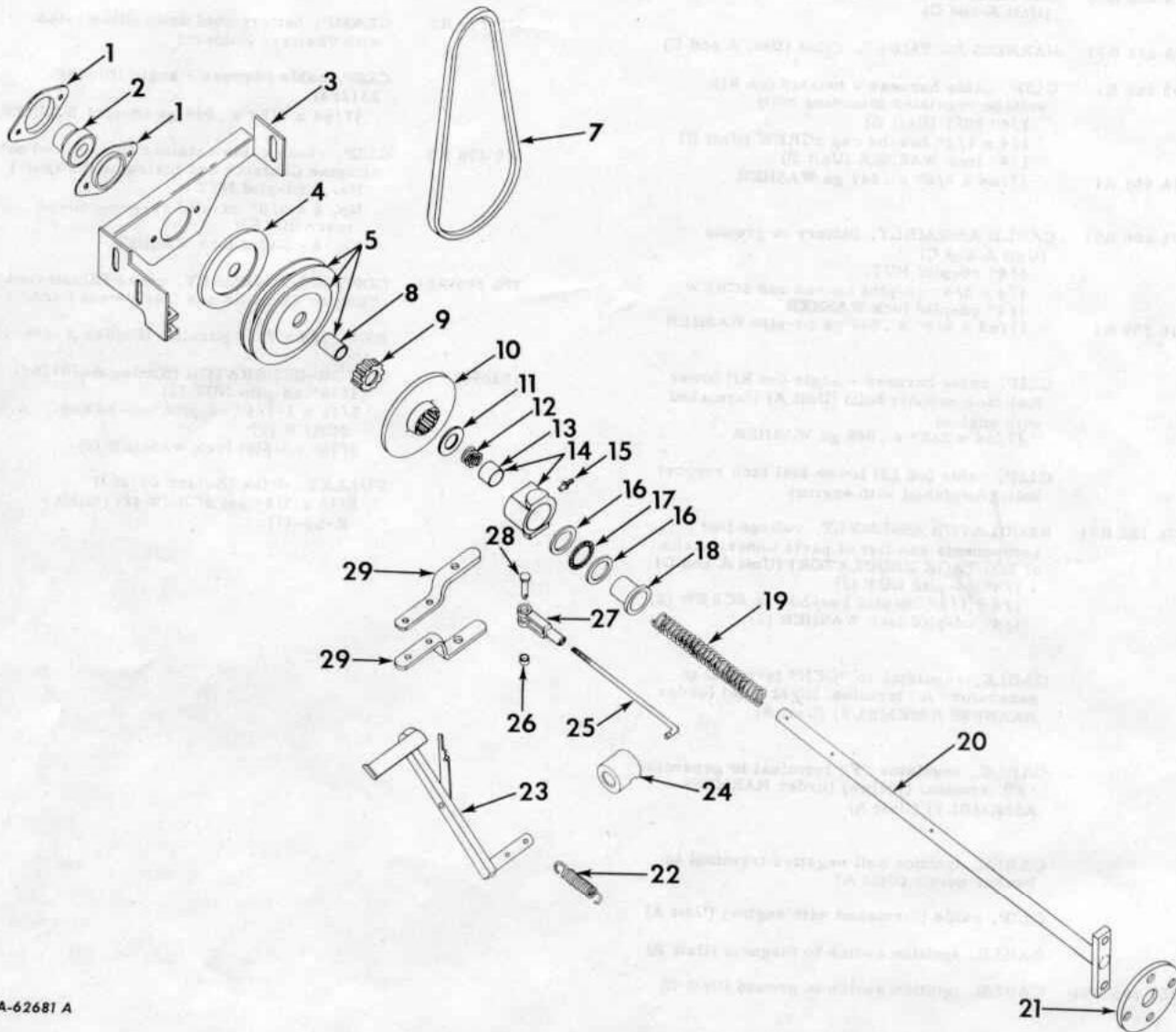

A-62681 A

1	376 272 R1	STAMPING, clutch shaft bearing (2) 1/4" NUT (2) 1/4 x 3/4" hex-hd cap SCREW (2) 1/4" lock WASHER (2)
2	376 271 R91	BEARING, clutch shaft
3	376 269 R11	SUPPORT ASSEMBLY, drive shaft bearing 3/8" NUT (3) 3/8 x 3/4" hex-hd cap SCREW (3) 3/8" lock WASHER (3)
4	376 268 R1 19 716 R1	PRESSURE PLATE, clutch-front 3/16 x 1-3/4" heavy spirol PIN
5	376 264 R11	PULLEY ASSEMBLY, clutch drive
7	376 230 R1	BELT, drive

8	376 265 R1	BUSHING, clutch pulley
9	376 262 R1 364 436 R1	CARRIER, clutch pressure plate 3/16 x 1" spirol PIN
10	376 263 R1	PRESSURE PLATE, clutch-rear
11	376 261 R1	WASHER, pressure plate retaining
12	376 260 R1	SPRING, clutch release
13	376 259 R1	BUSHING, clutch release collar
14	376 258 R11	COLLAR ASSEMBLY, clutch release
15	66 584 D	FITTING, 3/16" straight drive type
16	306 970 R1	WASHER, clutch release thrust bearing (2)

CLUTCH

CLUTCH

REF. NO.	PART NUMBER	DESCRIPTION
----------	-------------	-------------

CLUTCH CONTROLS AND CONNECTIONS - CONTINUED

17	368 372 R91	BEARING, clutch release thrust
18	376 282 R1	SLEEVE, clutch shaft
19	376 281 R1	SPRING, clutch loading
20	376 255 R11	SHAFT ASSEMBLY, clutch
	376 223 R1	flexible coupling NUT (2)
	19 372 R1	1/8 x 7/8" heavy spirol PIN
		3/8 x 1-1/8" hex-hd cap SCREW (2)
		3/8 x 3/4" x .065 ga WASHER (2)
	578 274 R1	21/32 x 1" x 11 ga. WASHER
21	376 257 R1	DISC, flexible coupling
22	370 278 R1	SPRING, pedal return
23	376 273 R11	PEDAL ASSEMBLY, clutch and brake
	102 683	1/4 x 11/16" b-hd RIVET
	378 341 R1	lock w/ratchet spring WASHER
24	376 276 R1	ARM, clutch
	617 938 R1	5/16 x 1-3/8" spirol PIN
25	376 277 R1	ROD, clutch operating
		3/32 x 3/4" cotter PIN
26	376 278 R1	SPACER, operating rod clevis
27	359 988 R1	CLEVIS, 5/16NF adjustable rod end
28	376 280 R1	PIN, operating rod clevis
		3/32 x 3/4" cotter PIN
29	376 279 R1	YOKE, clutch operating (2)
		3/8" NUT
		3/8 x 1" hex-hd cap SCREW
		3/32 x 3/4" cotter PIN
	26 479 D	5/16 x 1-3/16" rod end PIN
		3/8" lock WASHER

REAR FRAME AND DRIVING MECHANISMS

REF. NO.	PART NUMBER	DESCRIPTION
TRANSMISSION CASE, DIFFERENTIAL AND REDUCTION HOUSING - CONTINUED		
1	45 099 D	OIL SEAL, differential bearing retainer (2)
2	376 158 R91	RETAINER w/CUP, ST 974 ASSEMBLY, differential bearing (2) 3/8 x 1" hex-hd cap SCREW (6) 3/8" lock WASHER (6)
3	350 794 R1	SHIM, differential bearing retainer (extra light) (as required)
4	350 795 R1	SHIM, differential bearing retainer (light) (as required)
5	350 796 R1	SHIM, differential bearing retainer (medium) (as required)
6	350 797 R1	SHIM, differential bearing retainer (heavy) (as required)
7	285 723 R1	O-RING, differential bearing retainer (3-1/8 x 3-3/8 x 1/8") (2)
8	ST-974	CUP, differential bearing (2)
9	ST-2049	CONE, differential bearing (2)
10	358 756 R1	BUSHING, actuating toggle
11	351 236 R97	CASE ASSEMBLY, transmission and differential (Composed of - 1 BEARING 357 931 R91 1 BUSHING 358 756 R1 1 CASE 351 530 R7 6 PIN 350 799 R1 1 PIN 355 426 R1 1 PIN 357 215 R1 1 PLUG 103 866 1 PLUG 103 868 1 PLUG 103 869 2 PLUG 172 528 1 PLUG 172 530 1 PLUG 172 557 1 TAG 1 014 232 R1 1/4" sq-hd CI pipe PLUG 1/2" sq-hd CI pipe PLUG 3/4" sq-hd CI pipe PLUG
12	350 799 R1	PIN, transmission case to reduction housing dowel (2)
13	376 225 R1	SPACER, driven reduction gear
14	376 224 R1	GEAR, driven reduction
15	376 226 R1	RETAINER, driven reduction gear 7/16 x 7/8" hex-hd cap SCREW 7/16" lock WASHER
16	376 216 R1	GASKET, reduction housing
17	376 227 R1	HOUSING, reduction 3/4" sq-hd CI pipe PLUG 1/2 x 2-3/4" hex-hd cap SCREW (4) 1/2" lock WASHER (4)
18	376 218 R91	BEARING, reduction drive shaft front
19	376 221 R1	RING, reduction drive shaft bearing snap
20	376 219 R1	RING, reduction drive shaft bearing retaining snap
21	376 215 R91	OIL SEAL, reduction drive shaft

REAR FRAME AND DRIVING MECHANISMS

REF. NO.	PART NUMBER	DESCRIPTION
TRANSMISSION CASE, DIFFERENTIAL AND REDUCTION HOUSING - CONTINUED		
22	376 222 R1 376 223 R1 19 791 R1 617 057 R1 615 029 R1	ARM, coupling coupling arm NUT (2) 1/4 x 1-1/8" spirol PIN 1/4 x 1" spirol PIN 3/8 x 1-1/8" hex-hd cap SCREW (2) 3/8 x 3/4" x .065 ga WASHER (2)
23	551 139 R91	BEARING, reduction drive shaft rear needle
24	376 220 R1	SHAFT, reduction drive
25	172 530	PLUG, 11/16" expansion
26	350 786 R1	CASE, differential 5/16 x 1-1/8" rd-hd RIVET (8)
27	350 788 R1	PIN, differential pinion shaft lock
28	350 785 R91	CASE ASSEMBLY, differential (Composed of - 1 CASE 350 786 R1 1 GEAR 350 787 R1 1 PIN 350 788 R1 8 RIVET 104 100)
29	350 791 R1	GEAR, differential side (16 teeth) (2)
30	350 789 R1	SHAFT, differential pinion
31	350 790 R1	GEAR, differential pinion (10 teeth) (2)
32	350 787 R1	GEAR, differential drive (46 teeth)
33	350 837 R1	GASKET, transmission rear cover plate
34	350 836 R1	PLATE, transmission rear cover 3/8 x 5/8" hex-hd cap SCREW (4)

REAR FRAME AND DRIVING MECHANISMS



REF. NO.	PART NUMBER	DESCRIPTION
----------	-------------	-------------

TRANSMISSION

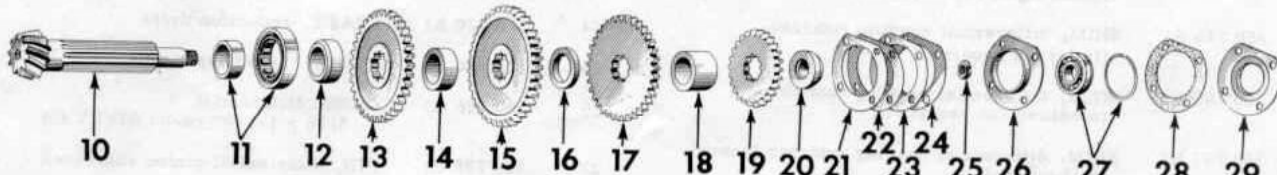
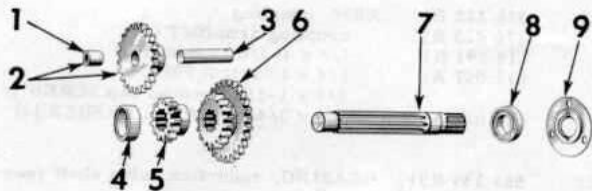

A-62358

1	350 871 R1	BUSHING, reverse idler gear
2	350 870 R11	GEAR, reverse idler (22 teeth)
3	350 869 R1	SHAFT, reverse idler 1/4 x 7/8" hex-hd cap SCREW 1/4" lock WASHER
4	357 931 R91	BEARING, transmission input shaft needle
5	350 867 R1	GEAR, first and reverse speed sliding (13 teeth)
6	364 520 R1	GEAR, second and third speed sliding (16 and 26 teeth)
7	376 212 R1	SHAFT, transmission input
8	ST 541	BEARING, transmission spline shaft front
9	376 213 R1	RETAINER, transmission input shaft bearing 5/16 x 11/16" hex-hd cap SCREW (3)
10	351 531 R1	COUNTERSHAFT (10 teeth) 1/8 x 1-1/8" cotter PIN
11	350 857 R91	BEARING, countershaft rear
12	351 532 R1	SPACER, reverse speed gear and countershaft bearing
13	350 848 R1	GEAR, reverse speed (35 teeth)
14	350 849 R1	SPACER, first and reverse speed gear

REAR FRAME AND DRIVING MECHANISMS



REF. NO.	PART NUMBER	DESCRIPTION
----------	-------------	-------------

TRANSMISSION - CONTINUED

15	350 850 R1	GEAR, first speed (39 teeth)
16	351 533 R1	SPACER, first and second speed gear
17	364 519 R1	GEAR, second speed (36 teeth)
18	350 853 R1	SPACER, second and third speed gear
19	350 854 R1	GEAR, third speed (26 teeth)
20	350 855 R1	SPACER, third speed gear and countershaft bearing
21	350 841 R1	SHIM, countershaft bearing retainer, extra light (.004") (as required)
22	350 842 R1	SHIM, countershaft bearing retainer, light (.007") (as required)
23	350 843 R1	SHIM, countershaft bearing retainer, medium (.015")
24	350 844 R1	SHIM, countershaft bearing retainer, heavy (.030")
25	70 119 D	NUT, countershaft
26	350 839 R1	RETAINER, countershaft bearing
27	ST 668	BEARING, countershaft front
28	350 846 R1	GASKET, countershaft bearing retainer
29	376 211 R1	RETAINER, countershaft bearing 5/16 x 11/16" hex-hd cap SCREW (4)

REAR FRAME AND DRIVING MECHANISMS

GEAR SHIFT MECHANISM

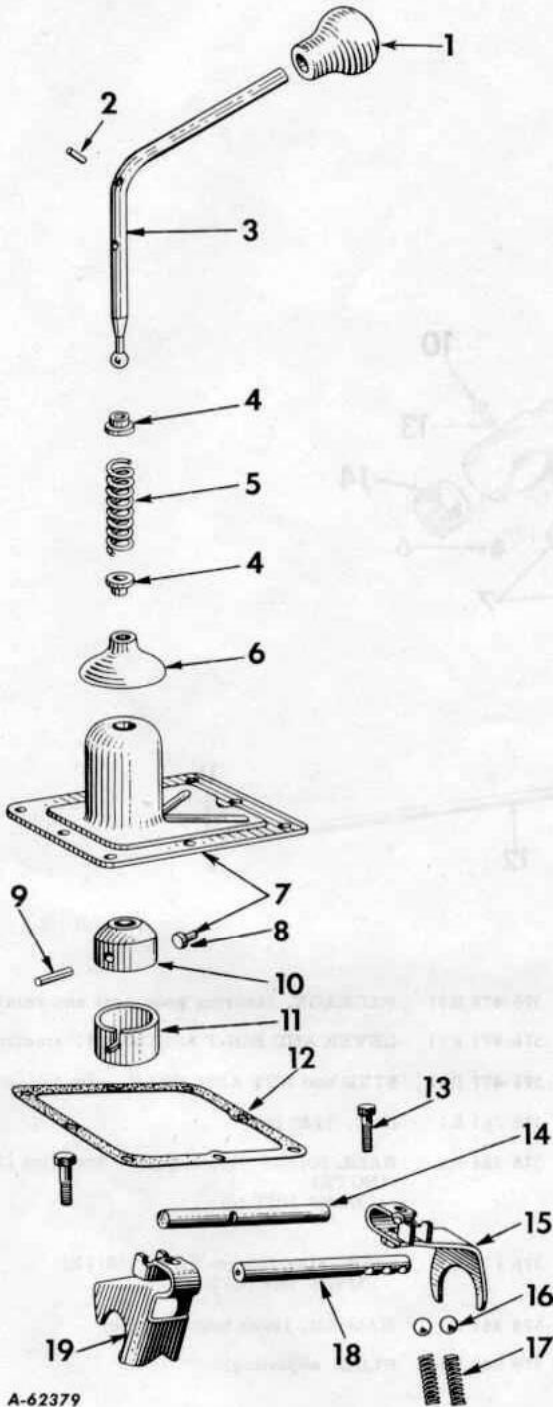

A-62379

REAR FRAME AND DRIVING MECHANISMS

GEAR SHIFT MECHANISM - CONTINUED

REF. NO.	PART NUMBER	DESCRIPTION
1	53 717 DA	KNOB, gear shift lever
2	350 885 R1	PIN, gear shift swivel spring retainer
3	376 214 R1	LEVER, gear shift
4	350 884 R1	RETAINER, gear shift swivel spring (2)
5	350 883 R1	SPRING, gear shift swivel
6	350 882 R1	SHIELD, gear shift lever
7	364 065 R11	HOUSING ASSEMBLY, gear shift lever 5/16 x 5/8" hex-hd cap SCREW (8) 5/16" lock WASHER (8)
8	364 066 R1	PIN, gear shift lever swivel stop
9	553 686 R1	PIN, 3/16 x 1-1/2" roll
10	364 068 R1	SWIVEL, gear shift lever
11	351 547 R1	GUIDE, gear shift lever
12	351 546 R1	GASKET, gear shift lever housing
13	351 543 R1	SCREW, shifter fork (2) 5/16" lock WASHER (2)
14	352 774 R3	ROD, second and third gear shifter
15	353 271 R21	FORK ASSEMBLY, second and third speed shifter
16	D 2 615	BALL, 3/8" chrome stl (rod poppet) (2)
17	350 876	SPRING, gear shifter poppet (2)
18	352 770 R3	ROD, first and reverse gear shifter
19	353 270 R21	FORK ASSEMBLY, first and reverse speed shifter



STEERING MECHANISM

REF. NO.	PART NUMBER	DESCRIPTION
----------	-------------	-------------

STEERING GEAR AND CONNECTIONS

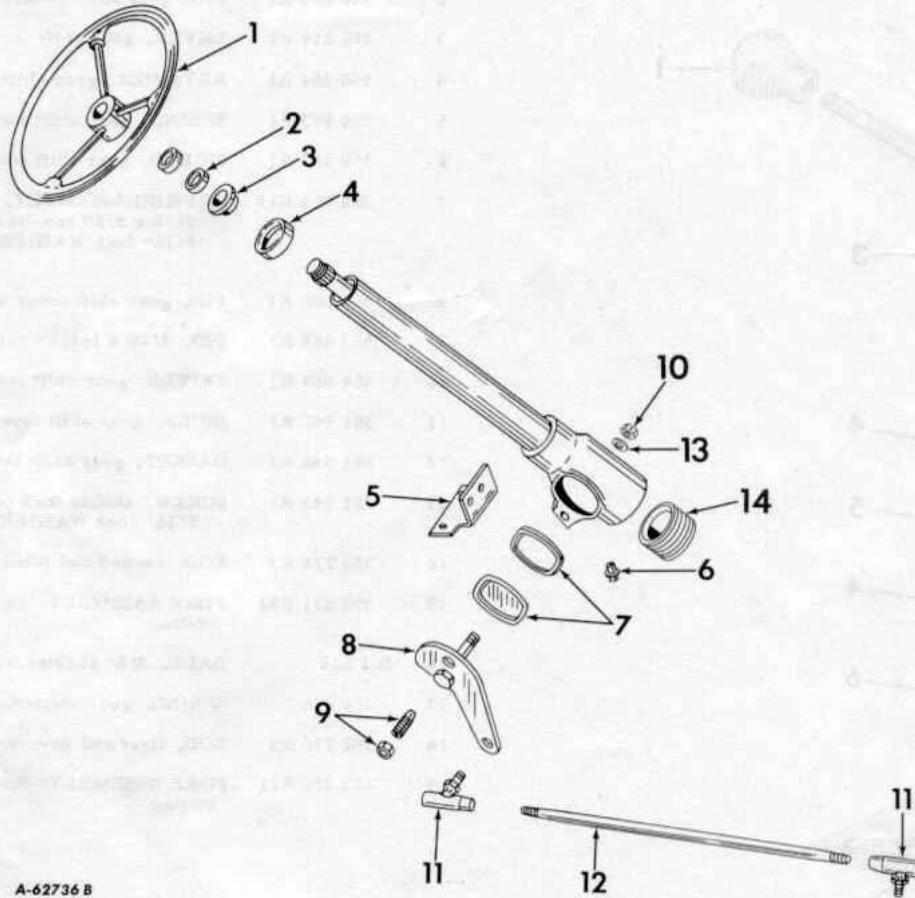

A-62736 B

	376 172 R91	GEAR ASSEMBLY, steering (composed of parts in this unit except as noted)
1	376 176 R1 131 506	WHEEL, steering (NOTE) 5/8NF cd-pltd low crown NUT
2	376 481 R1	SEAL, felt (2)
3	866 105 R1	BEARING, column upper
4	376 480 R1	RETAINER, bearing
5	376 173 R1	BRACKET, steering gear (NOTE) 3/8" NUT (2) 3/8 x 7/8" hex-hd cap SCREW (4) 3/8" lock WASHER (4)
6	273 355	FITTING, 1/4" straight drive type lubrication



STEERING MECHANISM

REF. NO.	PART NUMBER	DESCRIPTION
----------	-------------	-------------

STEERING GEAR AND CONNECTIONS - CONTINUED

7	376 478 R91	PACKAGE, steering gear seal and retainer
8	376 471 R91	LEVER AND BOLT ASSEMBLY, steering gear
9	376 477 R91	STUD and NUT ASSEMBLY, cam follower
10	378 761 R1	NUT, 1/2" jam
11	376 384 R1	BALL JOINT, steering gear drag link (2) (NOTE) 3/8NF NUT (2)
12	376 175 R1	LINK, steering gear drag (NOTE) 3/8NF jam NUT (2)
13	378 351 R1	WASHER, lever bolt (Bronze)
14	379 046 R1	PLUG, adjusting

NOTE - These parts are not included in the Steering Gear Assembly



FRONT AXLE

REF. NO.	PART NUMBER	DESCRIPTION
----------	-------------	-------------

FRONT AXLE AND STEERING KNUCKLES



FRONT AXLE

REF. NO.	PART NUMBER	DESCRIPTION
----------	-------------	-------------

FRONT AXLE AND STEERING KNUCKLES - CONTINUED

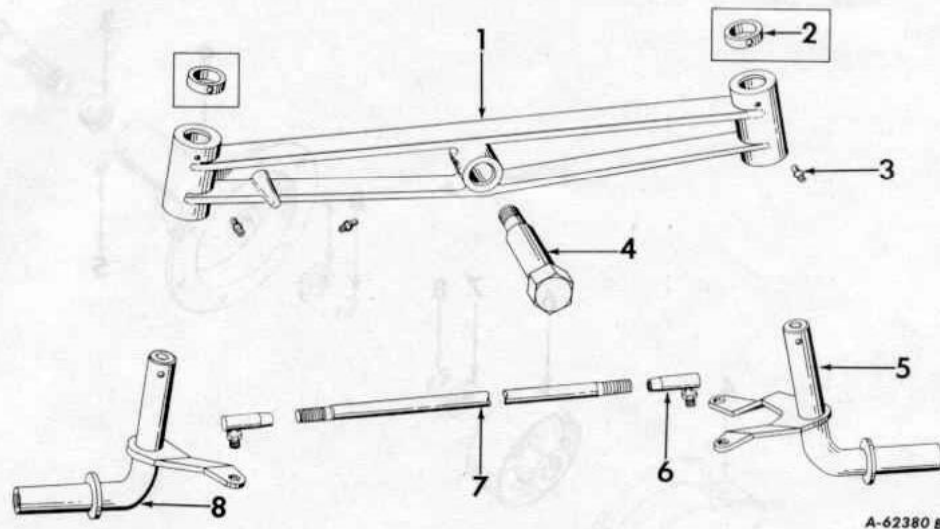

1	376 140 R1	AXLE, front	5	376 143 R92	KNUCKLE ASSEMBLY, RH steering 7/16 x 7/8" hex-hd cap SCREW (2) 15/32 x 1-1/2" x 11 ga WASHER (2)
2	376 147 R1	COLLAR, steering knuckle (2) 501 to 10332	6	376 384 R1	BALL JOINT, tie rod (2) 3/8" NF NUT (2)
	19 746 R1	1/4 x 1-1/4" spirol PIN (2)	7	376 149 R1	TIE ROD 3/8" NF jam NUT (2)
3	273 354	FITTING, 3/16" straight drive type lubrication (3) (optional with 443 566)	8	376 142 R92	KNUCKLE ASSEMBLY, LH steering 7/16 x 7/8" hex-hd cap SCREW (2) 15/32 x 1-1/2" x 11 ga WASHER (2)
3	443 566	FITTING, 3/16" straight drive type lubrication (3) (optional with 273 354)			
4	377 205 R1	BOLT, front axle pivot 9/16NF NUT 9/16" lock WASHER			

REAR AXLE



REF. NO.	PART NUMBER	DESCRIPTION
----------	-------------	-------------

REAR AXLE

REAR AXLE



REF. NO.	PART NUMBER	DESCRIPTION
----------	-------------	-------------

REAR AXLE - CONTINUED

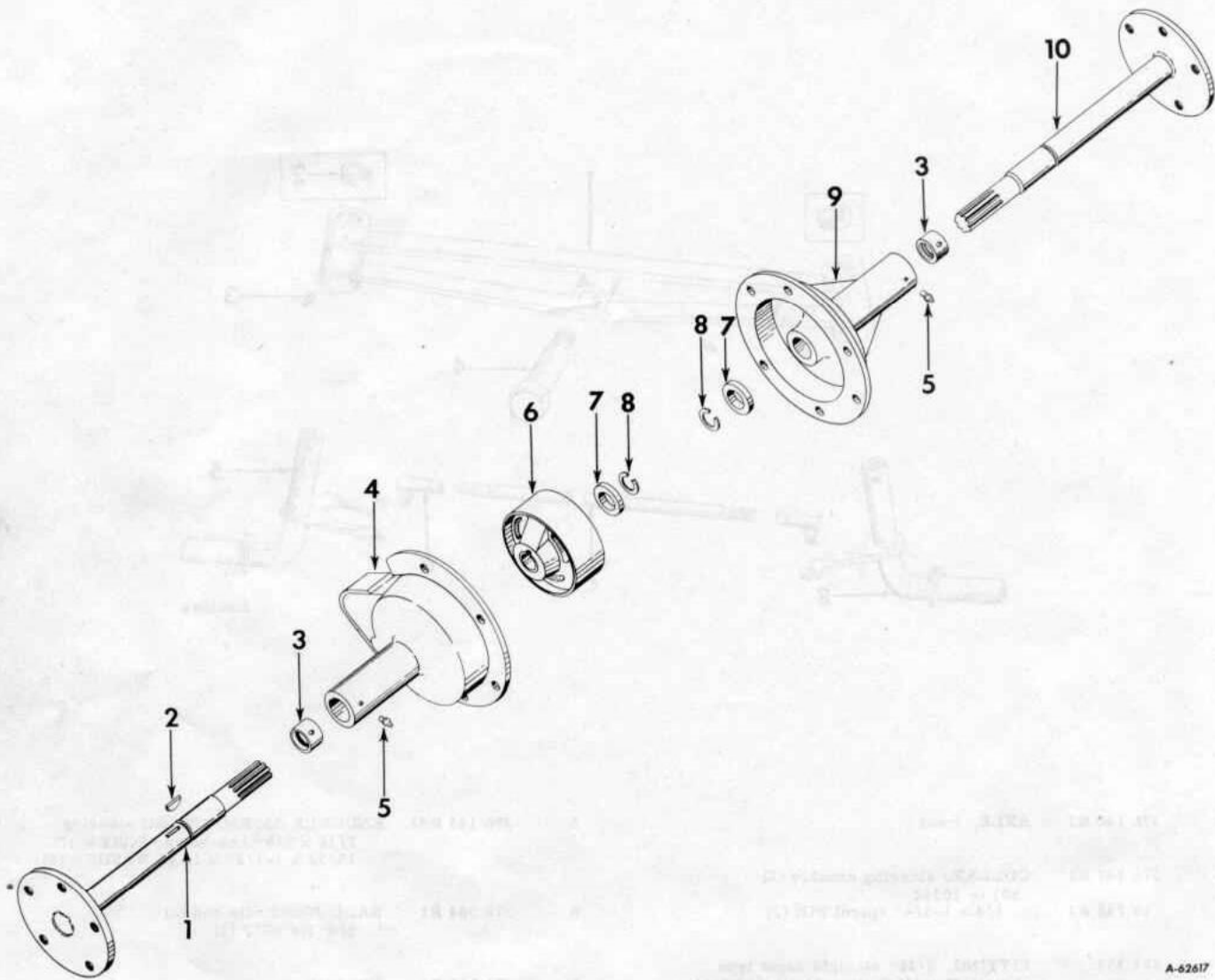

A-62617

1	376 496 R11	AXLE ASSEMBLY, rear LH
2	187 184	KEY, brake drum (No. 127 Woodruff)
3	376 160 R1	BUSHING, rear axle carrier (2)
4	376 159 R11	CARRIER, rear axle LH 3/8 x 1" hex-hd cap SCREW (5)
5	66 584 D	FITTING, 3/16" straight drive type lubrication (2)

6	376 169 R1	DRUM, brake
7	376 167 R1	COLLAR, rear axle (2)
8	454 417 R1	RING, rear axle snap (2)
9	376 161 R11	CARRIER, rear axle RH 3/8 x 1" hex-hd cap SCREW (6)
10	376 496 R11	AXLE ASSEMBLY, rear RH



WHEELS

REF. NO.	PART NUMBER	DESCRIPTION
----------	-------------	-------------

FRONT WHEELS

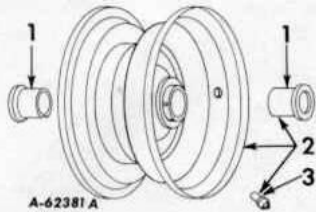

1	376 188 R1	BEARING, front wheel (4)
2	376 187 R91	WHEEL ASSEMBLY, front (w/ 3.75 x 8 rim for 4.80/4.00 x 8 tire) (2)
3	274 508	FITTING, 1/4NF 45° lubrication (optional with 117 175) (2)
3	117 175	FITTING, 1/4NF 45° lubrication (optional with 274 508) (2)

REAR WHEELS

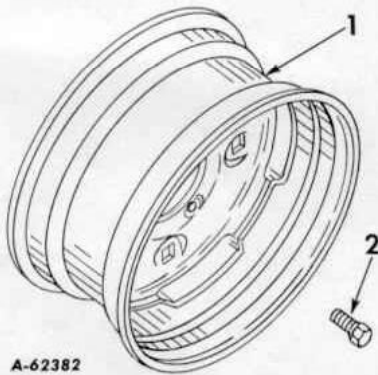

1	376 189 R91	WHEEL ASSEMBLY, rear (w/55A rim for 6-12 tire) (2)
2	351 846 R1	BOLT, rear wheel mounting (10)



WHEELS

REF. NO.	PART NUMBER	DESCRIPTION
----------	-------------	-------------

REAR WHEEL WEIGHTS

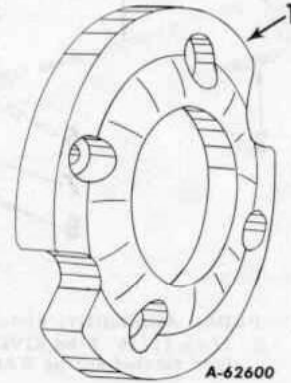

(X) - KEY TO UNITS

- A - Component parts for rear wheel weight (first set)
- B - Component parts for rear wheel weight (second set)

(X) - Letters of these units correspond with those shown following the description of the parts in the list below and identifies the unit for which the part is used. Items without letters after the description indicates the part is used for all units.

1	351 371 R1	WEIGHT, rear wheel (approximately 26 lbs) (2 for Unit A) 1/2" NUT (4)
	15 147 R1	1/2 x 3-1/2" crg BOLT (4) 1/2" lock WASHER (4)
1	351 371 R1	WEIGHT, rear wheel (approximately 26 lbs) (2 for Unit B) 1/2" NUT (4)
	15 286 R1	1/2 x 5-1/4" crg BOLT (4) 1/2" lock WASHER (4)

BRAKES



REF. NO.	PART NUMBER	DESCRIPTION
----------	-------------	-------------

BRAKES AND CONNECTIONS

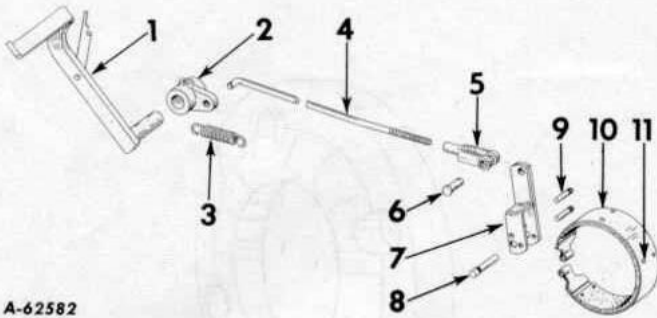

A-62582

1	376 273 R11 102 683 378 341 R1	PEDAL ASSEMBLY, clutch and brake 1/4 x 11/16" b-hd RIVET lock ratchet spring WASHER
2	376 275 R1 617 938 R1	ARM, brake 5/16 x 1-3/8" spirol PIN
3	370 278 R1	SPRING, pedal return
4	376 156 R1	ROD, brake operating
5	104 037	CLEVIS, 5/16NF adjustable rod end
6	103 495	PIN, 5/16 x 31/32" rod end 3/32 x 3/4" cotter PIN
7	376 151 R91	TOGGLE ASSEMBLY, brake band actuating
8	376 154 R1	PIN, brake band pivot
9	376 155 R1	PIN, brake band anchor (2)
10	358 753 R11	BAND ASSEMBLY, brake
11	355 775 R1	RIVET, brake band lining (10)
	358 895 R91	PACKAGE, brake lining (Consists of - 5 1 LINING 358 754 R1 10 RIVET 355 775 R1)

BRAKES



REF. NO.	PART NUMBER	DESCRIPTION
----------	-------------	-------------



DRAWBARS AND HITCHES

REF. NO.	PART NUMBER	DESCRIPTION
----------	-------------	-------------

IMPLEMENT HANDLE AND CONNECTIONS

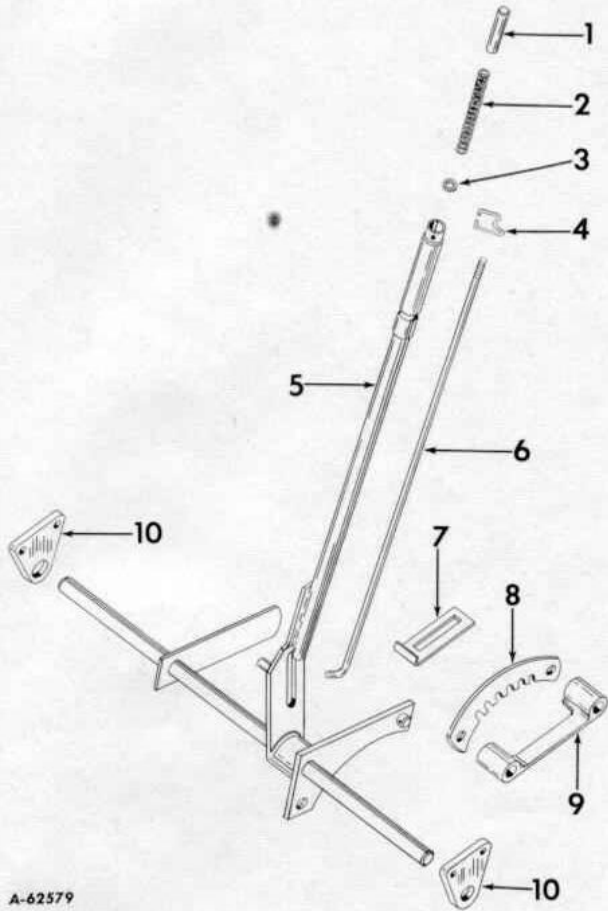

A-62579

- | | | |
|----|--------------------------|--|
| 1 | 376 307 R1 | BUTTON, handle release rod |
| 2 | 359 109 R2 | SPRING, release rod return |
| 3 | 376 308 R1 | RETAINER, release rod return spring |
| 4 | 376 314 R1 | LOCK, release rod |
| 5 | 376 301 R11 | HANDLE ASSEMBLY, lift |
| 6 | 376 306 R1 | ROD, handle release |
| 7 | 376 570 R1
15 010 R1 | STOP, lift handle
1/2 x 1" crg BOLT
1/2" NUT
1/2" lock WASHER |
| 8 | 376 310 R1 | RATCHET, lift |
| 9 | 377 167 R11
15 089 R1 | SPACER ASSEMBLY, lift ratchet
3/8" NUT (2)
3/8 x 2-1/4" crg. BOLT (2)
3/8" external tooth lock WASHER (2) |
| 10 | 376 313 R1 | BRACKET, lift handle shaft (2)
3/8" NUT (4)
3/8 x 1" hex-hd. cap SCREW (4)
3/8" medium lock WASHER (4) |



DRAWBARS AND HITCHES

REF. NO.	PART NUMBER	DESCRIPTION
----------	-------------	-------------

THREE-POINT HITCH AND DRAWBAR

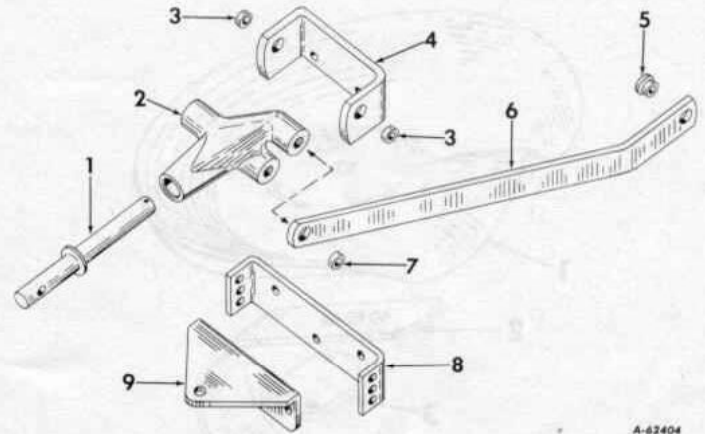

A-62404

ATTACHMENT, three-point hitch
(376 332 R91)

- | | | |
|---|------------|--|
| 1 | | ARM ASSEMBLY, left (Furnish with Implement)
1/8 x 1-1/2" cotter PIN |
| 2 | 376 566 R1 | LEVER, lift
1/2 x 1-1/2" cd-pltd hex-hd cap SCREW (2)
1/2" cd-pltd lock WASHER (2)
17/32 x 1-1/16" x .095 ga cd-pltd WASHER (2) |
| 3 | 376 567 R1 | SPACER, lift lever (2) |
| 4 | 376 333 R1 | BRACKET, upper mounting
3/8 x 1-1/8" cd-pltd hex-hd cap SCREW (2)
3/8" cd-pltd lock WASHER (2) |
| 5 | 376 568 R1 | SPACER, lift link-lower |
| 6 | 376 339 R1 | LINK, lift
1/2" cd-pltd NUT
1/2 x 1-1/2" cd-pltd hex-hd cap SCREW
1/2 x 1-5/8" cd-pltd hex-hd cap SCREW
1/2" cd-pltd lock WASHER (2)
17/32 x 1-1/16" x .095 ga cd-pltd WASHER (2) |
| 7 | 376 567 R1 | SPACER, lift link-upper |
| 8 | 376 634 R1 | BRACKET, lower mounting
3/8 x 1-1/4" cd-pltd hex-hd cap SCREW (3) |
| 9 | 376 157 R1 | DRAWBAR, fixed (NOTE)
3/8 x 1" hex-hd cap SCREW (3)
3/8" lock WASHER (3) |

NOTE - Not included in the Three-Point Hitch Attachment

SEAT AND SUPPORT



REF. NO.	PART NUMBER	DESCRIPTION
----------	-------------	-------------

SEAT

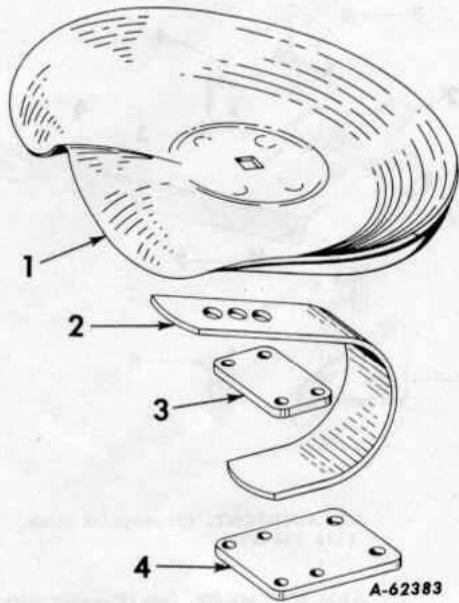

1	376 170 R91 18 707 R1	SEAT ASSEMBLY 1/2 x 1" cd-pltd crg BOLT 1/2" cd-pltd NUT 1/2" cd-pltd lock WASHER
2	376 498 R1	SPRING, seat support
3	376 500 R1	PLATE, spring clamp 3/8NF cd-pltd NUT (4) 3/8NF x 1-3/8" cd-pltd hex-hd cap SCREW (4)
4	376 499 R1	PLATE, spring mounting 1/2 x 1-1/8" cd-pltd hex-hd cap SCREW (2)
	376 472 R1	PAD, detachable seat

SEAT AND SUPPORT



REF. NO.	PART NUMBER	DESCRIPTION
----------	-------------	-------------



SHEET METAL AND GRILLES

REF. NO.	PART NUMBER	DESCRIPTION
----------	-------------	-------------

HOOD, GRILLE, AND FRAME

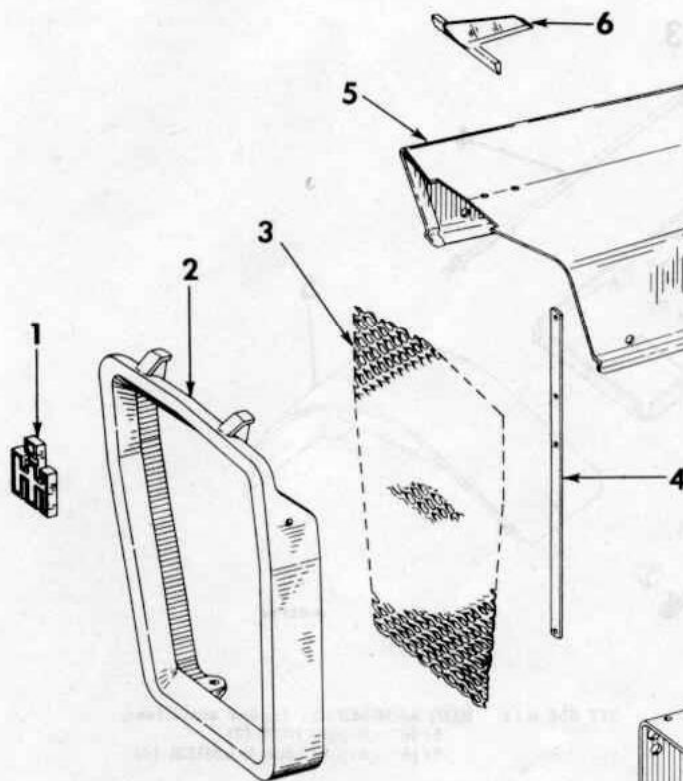

1	368 523 R4 188 926	EMBLEM, IH grille No. 10 x 7/16" cd-pltd hex-hd mach SCREW w/WASHER (2)
2	376 243 R1	GRILLE 1/4" cd-pltd NUT (4) 1/4 x 1-1/8" cd-pltd hex-hd cap SCREW (4) 1/4" cd-pltd lock WASHER (4)
3	376 244 R1	SCREEN, grille
4	376 245 R1	FASTENER, grille screen 1/4 x 1/2" hex-hd cap SCREW (2)
5	376 241 R11 378 531 R1	HOOD ASSEMBLY 1/4" gripco centerlock NUT (2) 1/4 x 1-1/8" hex-hd cap SCREW (2) 9/32 x 5/8" x .062 ga WASHER (2)
6	369 180 R1 423 324	ORNAMENT, hood No. 10 x 7/16" cd-pltd hex-hd mach SCREW w/WASHER (2)



SHEET METAL AND GRILLES

REF. NO.	PART NUMBER	DESCRIPTION
----------	-------------	-------------

HOOD, GRILLE, AND FRAME - CONTINUED

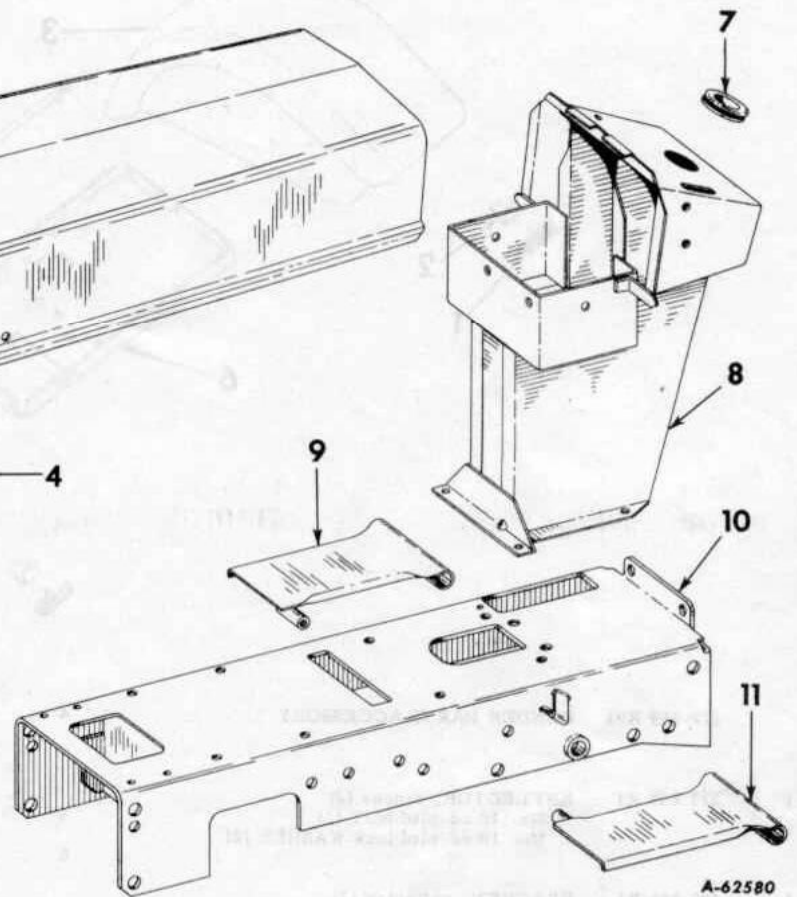

A-62580

7	376 254 R1	GROMMET, instrument panel
8	376 252 R91	PEDESTAL ASSEMBLY 5/16 x 1/2" cd-pltd hex-hd cap SCREW (4) 5/16" cd-pltd lock WASHER (4)
9	376 239 R11	SUPPORT ASSEMBLY, foot RH 3/8 x 3/4" hex-hd cap SCREW 3/8" lock WASHER
10	376 231 R11	FRAME ASSEMBLY, main 1/2 x 1" hex-hd cap SCREW (2) 1/2 x 6" hex-hd cap SCREW (2) 1/2" lock WASHER (4)
11	376 238 R11	SUPPORT ASSEMBLY, foot LH 3/8 x 3/4" hex-hd cap SCREW 3/8" lock WASHER



SHEET METAL AND GRILLES

REF. NO.	PART NUMBER	DESCRIPTION
----------	-------------	-------------

FENDERS AND PLATFORM

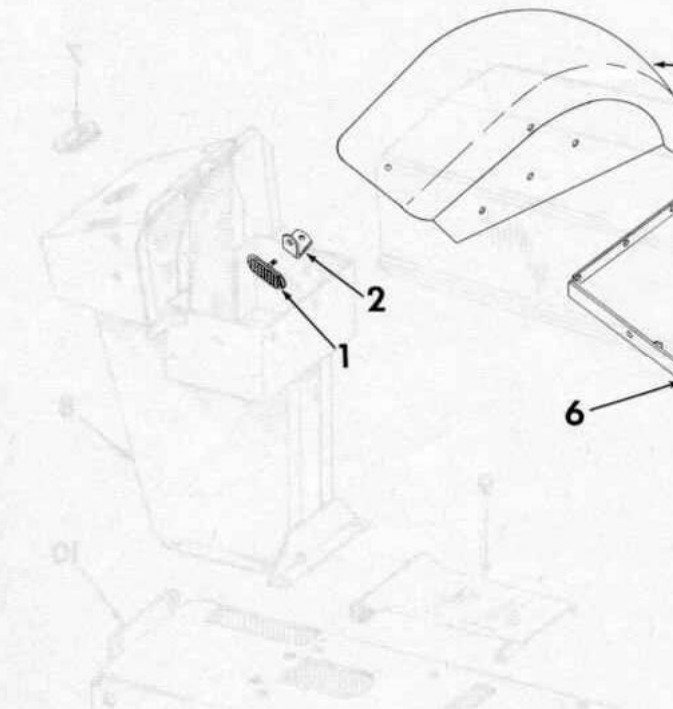

	377 859 R91	FENDER PARTS ACCESSORY
1	377 857 R1	REFLECTOR, fender (2) No. 10 cd-pltd NUT (2) No. 10 cd-pltd lock WASHER (2)
2	377 856 R1	BRACKET, reflector (2) No. 10 cd-pltd NUT (2) No. 10 x 3/8" slt-rd-hd cd-pltd SCREW (2) No. 10 cd-pltd lock WASHER (2)
3	377 860 R11	FENDER ASSEMBLY, LH



SHEET METAL AND GRILLES

REF. NO.	PART NUMBER	DESCRIPTION
----------	-------------	-------------

FENDERS AND PLATFORM - CONTINUED

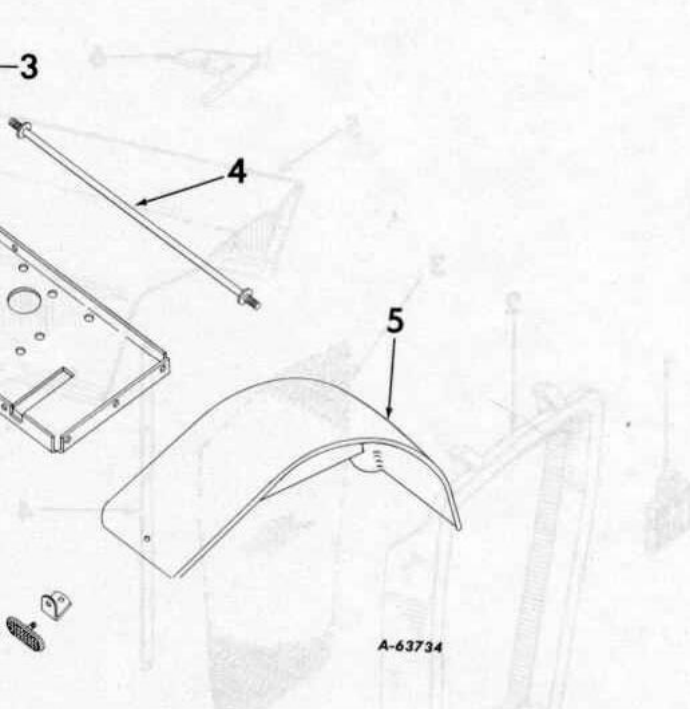

4	377 858 R11	ROD ASSEMBLY, fender stabilizer 5/16" cd-pltd NUT (2) 5/16" cd-pltd lock WASHER (2)
5	377 861 R11	FENDER ASSEMBLY, RH
6	377 863 R1	PLATFORM, fender mounting 5/16" cd-pltd NUT (6) 5/16 x 5/8" hex-hd cd-pltd cap SCREW (6) 5/16 x 3/4" hex-hd cd-pltd cap SCREW (3) 3/8NF x 1-1/2" hex-hd cd-pltd cap SCREW (4) 1/2 x 1-1/4" hex-hd cd-pltd cap SCREW (2) 5/16" cd-pltd lock WASHER (9) 11/32 x 11/16" x .065 ga cd-pltd WASHER (3)

**ENGINE CONTROLS
AND INSTRUMENT PANEL**

REF. NO.	PART NUMBER	DESCRIPTION
----------	-------------	-------------

ENGINE CONTROLS AND INSTRUMENT PANEL

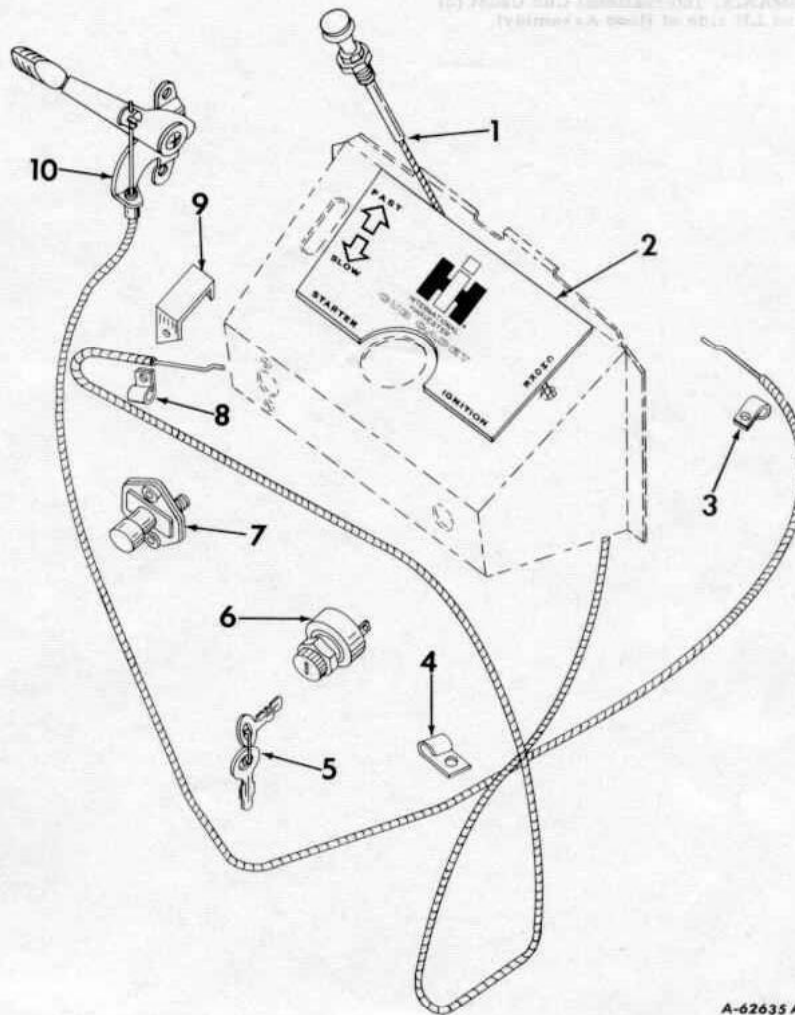

A-62635 A

- | | | |
|---|---------------------------|--|
| 1 | 376 299 R91 | CONTROL ASSEMBLY, choke (NOTE A) |
| 2 | 2 750 805 R2 | LABEL, instrument panel |
| 3 | 376 298 R1 | CLIP, throttle cable retainer
No. 8 cd-pltd NUT
No. 8 x 1/2" cd-pltd cr-rec pan-hd mach SCREW
No. 8 cd-pltd lock WASHER |
| 4 | 61 813 D | CLIP, throttle cable support
(on engine LH rear mounting bolt) |
| 5 | | KEY, switch (purchase locally) |
| 6 | 365 522 R91
365 502 R1 | SWITCH ASSEMBLY, ignition (NOTE A)
switch mounting NUT
No. 6 x 1/4" cd-pltd sltd rd-hd mach SCREW (2)
No. 6 cd-pltd lock WASHER (2) |
| | 375 431 R1 | switch mounting WASHER |
| 6 | 367 168 R91 | SWITCH ASSEMBLY, ignition (NOTE B) |

**ENGINE CONTROLS
AND INSTRUMENT PANEL**

REF. NO.	PART NUMBER	DESCRIPTION
----------	-------------	-------------

ENGINE CONTROLS AND INSTRUMENT PANEL - CONTINUED

- | | | |
|----|-------------|---|
| 7 | 376 295 R91 | SWITCH ASSEMBLY, starting (NOTE A)
1/4" NUT (2)
5/16NF cd-pltd jam NUT (2) (For fastening cable to switch)
1/4 x 3/4" slt-pan-hd mach SCREW (2)
1/4" lock WASHER (2)
5/16" cd-pltd lock WASHER (2) (For fastening cable to switch) |
| | 16 559 R1 | 17/64 x 5/8" x .049 ga WASHER (2) |
| 8 | 376 298 R1 | CLIP, choke cable retainer (NOTE A)
No. 8 cd-pltd NUT
No. 8 x 3/8" cd-pltd cr-rec-pan-hd mach SCREW |
| 9 | | BRACKET, choke cable (NOTE A) (furnished with engine) |
| 10 | 376 297 R91 | LEVER and CABLE ASSEMBLY, throttle
No. 10 cd-pltd NUT (2)
No. 10 x 1/2" cd-pltd slt-rd-hd mach SCREW (2)
No. 10 cd-pltd lock WASHER (2) |

NOTE A - Tractors with Electric Starter
NOTE B - Tractors with Retractable Starter



MISCELLANEOUS EQUIPMENT

REF. NO.	PART NUMBER	DESCRIPTION
----------	-------------	-------------

DECALCOMANIAS

2 750 813 R1 DECALCOMANIA, International Cub Cadet (2)
(On RH and LH side of Hood Assembly)

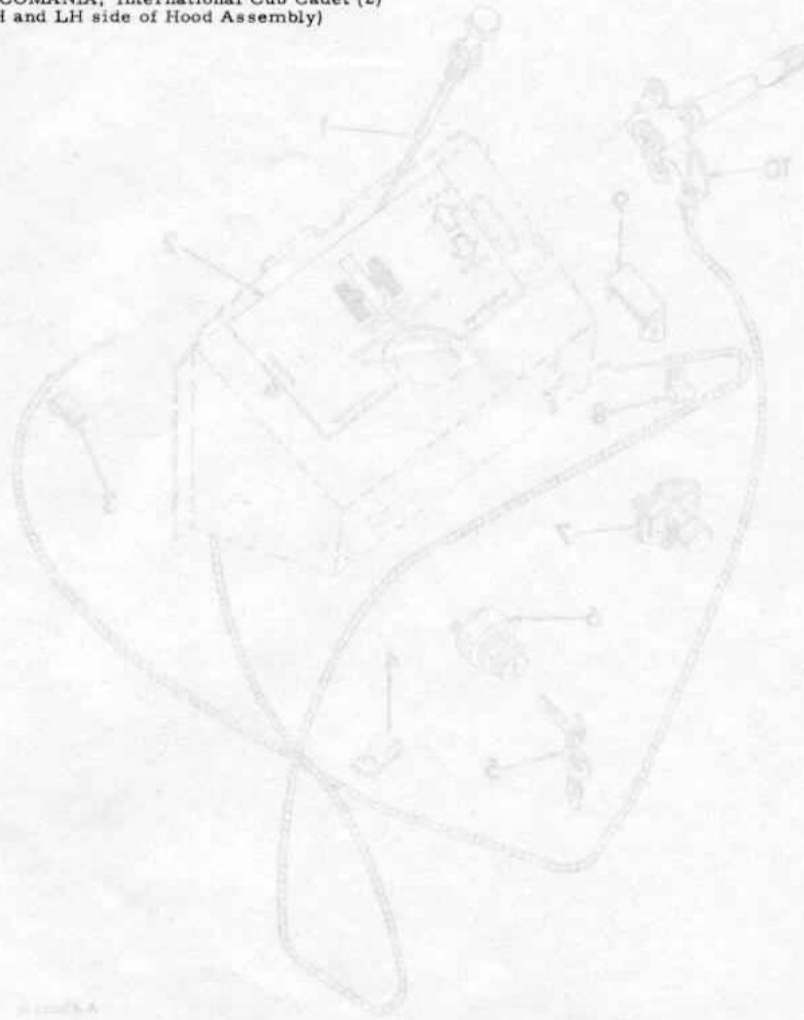

MISCELLANEOUS EQUIPMENT

REF. NO.	PART NUMBER	DESCRIPTION
----------	-------------	-------------

DECALCOMANIAS

REF. NO.	PART NUMBER	DESCRIPTION
1	2 750 813 R1	DECALCOMANIA, International Cub Cadet (2) (On RH and LH side of Hood Assembly)

BLADE, CUTTING EDGE, SKID SHOE AND MOUNTING BAR - C-14-1000

BLADE, CUTTING EDGE, SKID SHOE AND MOUNTING BAR

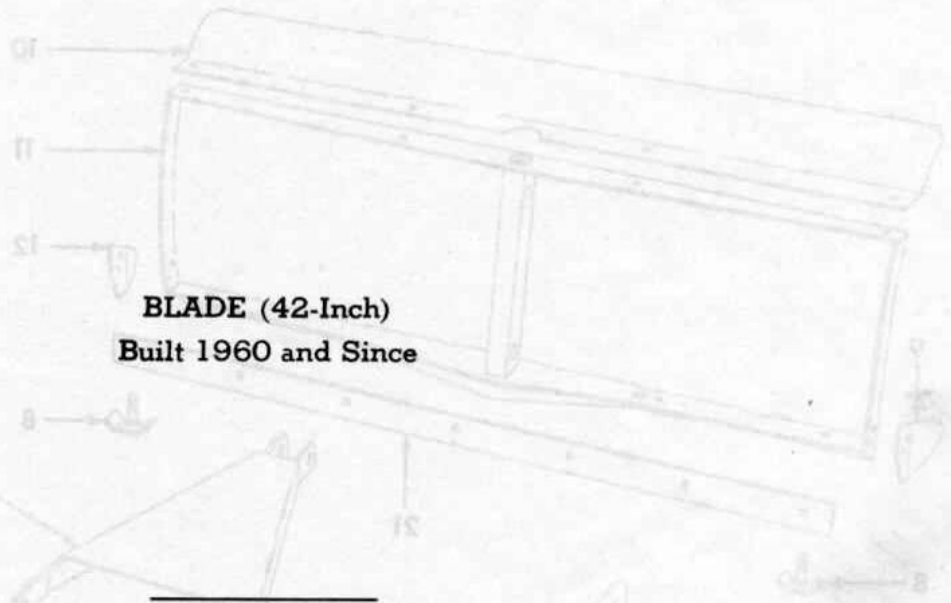

BLADE (42-Inch)
Built 1960 and Since

INDEX TO UNITS

DESCRIPTION	Page
BAR, Mounting.....	36
BLADE.....	36
DECALCOMANIAS.....	37
EDGE, Cutting.....	36
SHOE, Skid.....	36